



Public Works and Planning Department  
250 North 5<sup>th</sup> Street, Grand Junction CO 81501  
Tel: (970) 244-1430 FAX (970) 256-4031

# Sign Permit

For Signs that **DO NOT** Require  
a **Building Permit**

A

Date Submitted 7/20/09  
Fee \$ 25.00  
Zone \_\_\_\_\_

TAX SCHEDULE NO. 2945-11-04-007 CONTRACTOR The Sign Gallery  
BUSINESS NAME Walker Diagnostic Medical LICENSE NO. 2198506  
STREET ADDRESS 2241 N 7th ADDRESS 1048 Independent RD  
PROPERTY OWNER J. Walker TELEPHONE 241-6400  
OWNER ADDRESS \_\_\_\_\_ CONTACT PERSON Larry

- 1. FLUSH WALL 2 Square Feet per Linear Foot of Building Façade
- 2. ROOF 2 Square Feet per Linear Foot of Building Façade
- 3. PROJECTING 0.5 Square Feet per each Linear Foot of Building Façade
- 4. FREE-STANDING 2 Traffic Lanes - 0.75 Square Feet x Street Frontage  
4 or more Traffic Lanes - 1.5 Square Feet x Street Frontage

Existing Externally or Internally Illuminated - No Change in Electrical Service  Non-Illuminated

(1-4) Area of Proposed Sign: 60 Square Feet  
(1-3) Building Façade: 70 Linear Feet Building Façade Direction: North South East West  
(4) Street Frontage: 82 Linear Feet Name of Street: N 7th  
(2-4) Height to Top of Sign: 16 Feet Clearance to Grade: 12 Feet

EXISTING SIGNAGE TYPE & SQUARE FOOTAGE:

<u>flush wall (60 sq ft permit)</u>	<u>68</u>	Sq. Ft.
<u>Free-standing</u>	<u>104</u>	Sq. Ft.
_____	_____	Sq. Ft.
Total Existing:	<u>172</u>	Sq. Ft.

FOR OFFICE USE ONLY

Signage Allowed on Parcel:

Building	<u>140</u>	Sq. Ft.
Free-Standing	<u>123</u>	Sq. Ft.
Total Allowed:	<u>140</u>	Sq. Ft.

COMMENTS: Reletter an existing sign face

**NOTE:** No sign may exceed 300 square feet. A separate sign permit is required for each sign. Attach a sketch, to scale, of proposed and existing signage including types, dimensions and lettering. Attach a plot plan, to scale, showing: abutting streets, alleys, easements, driveways, encroachments, property lines, distances from existing buildings to proposed signs and required setbacks. Roof signs shall be manufactured such that no guy wires, braces or supports shall be visible.

I hereby attest that the information on this form and the attached sketches are true and accurate.

Larry L. Brewster 7-20-09 Wendy Spurr 7/22/09  
Applicant's Signature Date Planning Approval Date

A+B Walker Discount  
2241 97.7th



7th

Existing  
2x4 flush wall

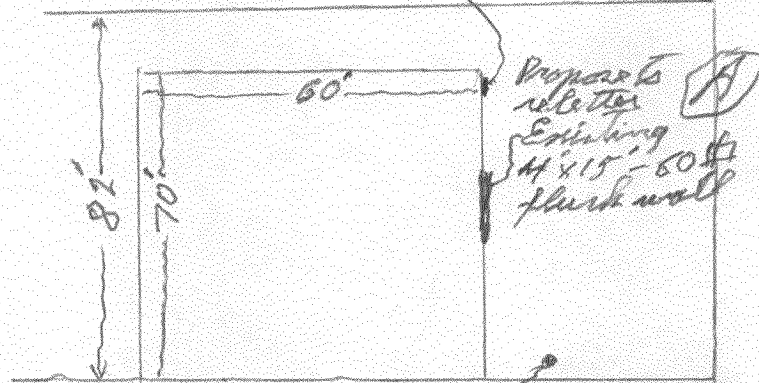

Propose to reletter  
Existing  
44 x 15 = 60 sq  
flush wall

Existing free-standing  
Propose to reletter  
one of the faces.  
6 x 8 = 48 sq  
Total faces 104 sq

A

2241 N. 7th

Walker DISCOUNT  
MEDICAL SUPPLY

4' x 15'  
60 #

Walker Discount  
2241 N 7th

Free-standing

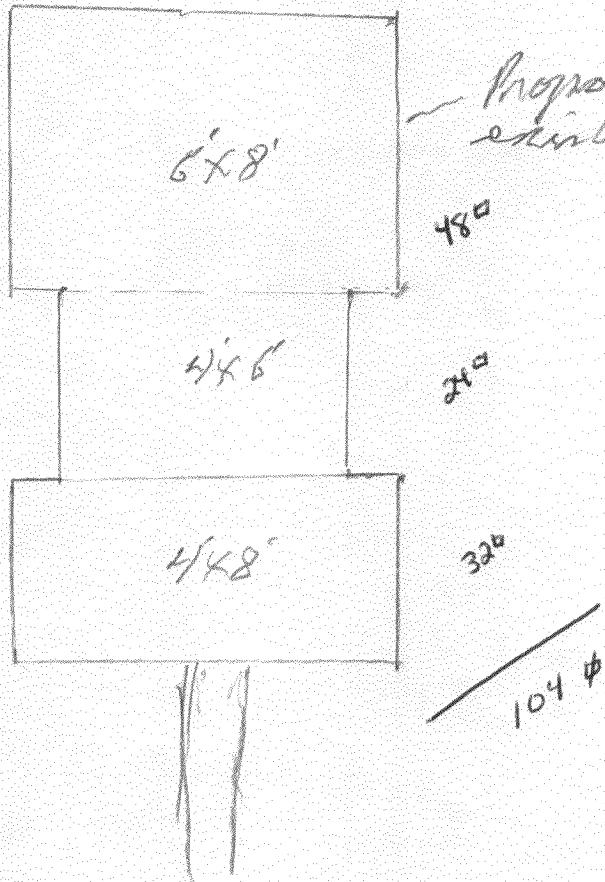

Propose to reletter  
existing 6' x 8' face