



Public Works and Planning Department
250 North 5th Street, Grand Junction CO 81501
Tel: (970) 244-1430 FAX (970) 256-4031

Sign Permit

For Signs that DO NOT Require
a Building Permit

| | |
|----------------|---------|
| Date Submitted | 6/23/09 |
| Fee \$ | 25.00 |
| Zone | C2 |

| | |
|--|-------------------------------------|
| TAX SCHEDULE NO. 2945-091-02-018 | CONTRACTOR Your Sign Company |
| BUSINESS NAME COOK Compression | LICENSE NO. 2091037 |
| STREET ADDRESS 2487 Industrial Blvd. Units 4 & 7 | ADDRESS 2478 Industrial Blvd. 81505 |
| PROPERTY OWNER Katherine Vaggolis/Schaak fam. | TELEPHONE 242-3924 |
| OWNER ADDRESS 6025 W. Warren Pl. Lakewood CO 80227 | CONTACT PERSON Angela |

| | | |
|-------------------------------------|------------------|---|
| <input type="checkbox"/> | 1. FLUSH WALL | 2 Square Feet per Linear Foot of Building Façade |
| <input type="checkbox"/> | 2. ROOF | 2 Square Feet per Linear Foot of Building Façade |
| <input type="checkbox"/> | 3. PROJECTING | 0.5 Square Feet per each Linear Foot of Building Façade |
| <input checked="" type="checkbox"/> | 4. FREE-STANDING | 2 Traffic Lanes - 0.75 Square Feet x Street Frontage 4 or more Traffic Lanes - 1.5 Square Feet x Street Frontage |

Existing Externally or Internally Illuminated - No Change in Electrical Service Non-Illuminated

| | |
|---|--|
| (1-4) Area of Proposed Sign: 60 Square Feet | Building Façade Direction: North South East West |
| (1-3) Building Façade: 250 Linear Feet | Name of Street: Industrial Blvd. |
| (4) Street Frontage: 140' Linear Feet | Clearance to Grade: 9' Feet |
| (2-4) Height to Top of Sign: 11' Feet | |

EXISTING SIGNAGE TYPE & SQUARE FOOTAGE:

| | | |
|--|------------|----------------|
| West Façade (4x8) (4x8) (4x8) (2x8) → all wall mt. | 112 | Sq. Ft. |
| Free Standing | 32 | Sq. Ft. |
| Free Standing Pole Sign | 6 | Sq. Ft. |
| Total Existing: | 150 | Sq. Ft. |

FOR OFFICE USE ONLY

| | |
|----------------------------|--------------------|
| Signage Allowed on Parcel: | |
| 2x250 Building | 500 Sq. Ft. |
| .75x140 Free-Standing | 105 Sq. Ft. |
| Total Allowed: | 605 Sq. Ft. |

COMMENTS: requesting face change on existing 60 sq. ft. pole sign

NOTE: No sign may exceed 300 square feet. A separate sign permit is required for each sign. Attach a sketch, to scale, of proposed and existing signage including types, dimensions and lettering. Attach a plot plan, to scale, showing: abutting streets, alleys, easements, driveways, encroachments, property lines, distances from existing buildings to proposed signs and required setbacks. Roof signs shall be manufactured such that no guy wires, braces or supports shall be visible.

I hereby attest that the information on this form and the attached sketches are true and accurate.

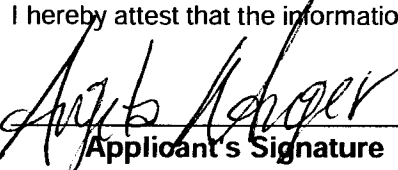
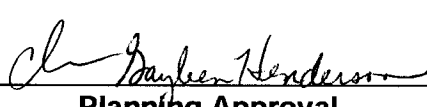
 Applicant's Signature
 6.23.09 Date
  Planning Approval
 6/24/09 Date

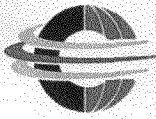

COOK
COMPRESSION

A **DOVER** COMPANY

5401 Oswego Street, Suite B

Denver, CO 80239

T: 303.750.1991

800.221.8433

F: 303.750.1993

2'

3'

proposed sign to include
logo only

*proposed face
clearing on this sign*

Mesa
ALTERNATORS
& STARTERS

INDUSTRIAL BVD
ICE SKATING INC.
MESA
ALTERNATOR
& STARTER
Kangaroo Express
MESA
TOP GUN
CHEER & DANCE ACADEMY
FERGUSON-BEAUREGARD
INC.
MESA



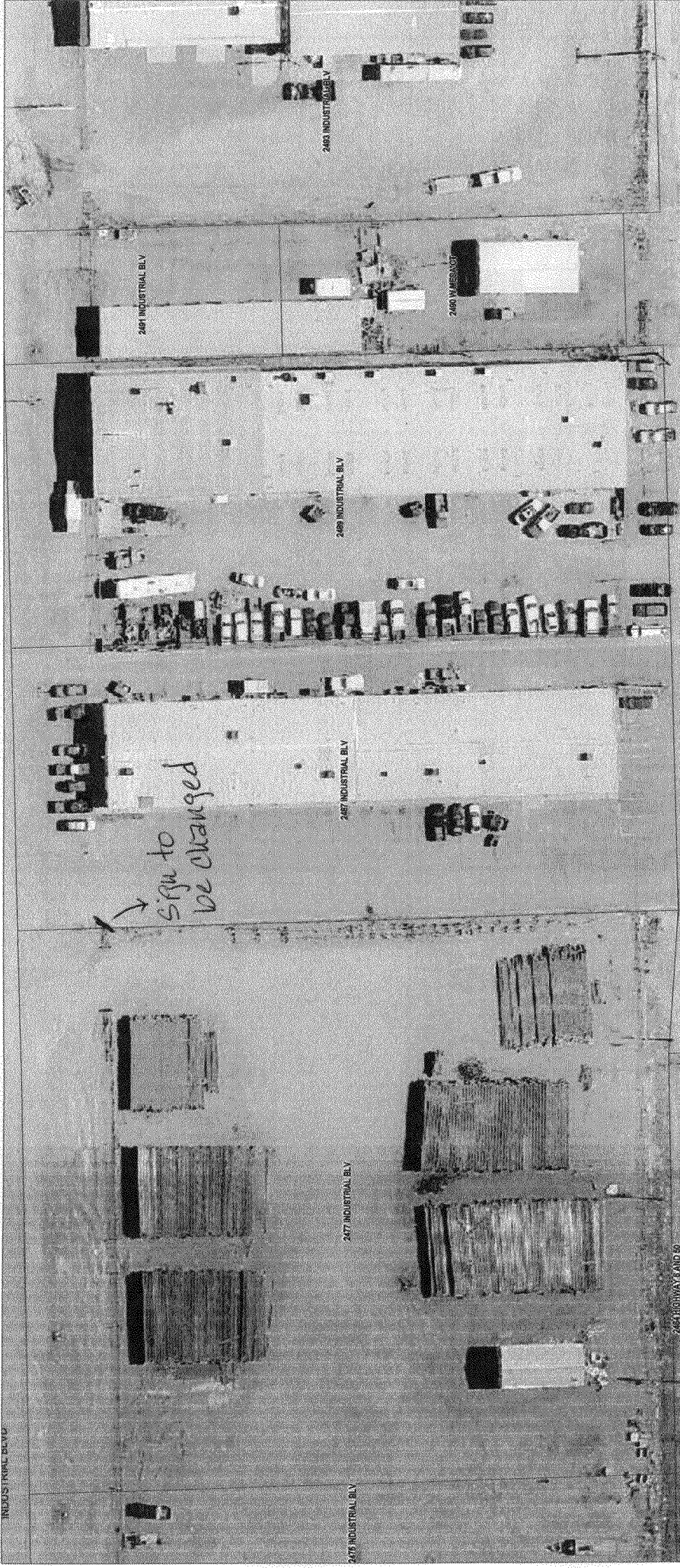

Sign to be changed

INDUSTRIAL BLVD

243 INDUSTRIAL BLV

247 INDUSTRIAL BLV

249 INDUSTRIAL BLV

249 INDUSTRIAL BLV

249 INDUSTRIAL BLV

245 INDUSTRIAL BLV

245 W HESNAP

2451 HIGHWAY 99