



Public Works and Planning Department
250 North 5th Street, Grand Junction CO 81501
Tel: (970) 244-1430 FAX (970) 256-4031

Sign Permit

For Signs that DO NOT Require
a Building Permit

Date Submitted 10/19/09
Fee \$ 25.00
Zone C1

TAX SCHEDULE NO. 2943182-00-063 CONTRACTOR The Sign Gallery
[Redacted] NO. 2198506
STREET ADDRESS 2829 N. Ave Suite 212 ADDRESS 1048 Independence A109
PROPERTY OWNER 1004 Chambers Court TELEPHONE 241-6400
OWNER ADDRESS _____ CONTACT PERSON Larry

- 1. FLUSH WALL 2 Square Feet per Linear Foot of Building Façade
- 2. ROOF 2 Square Feet per Linear Foot of Building Façade
- 3. PROJECTING 0.5 Square Feet per each Linear Foot of Building Façade
- 4. FREE-STANDING 2 Traffic Lanes - 0.75 Square Feet x Street Frontage
4 or more Traffic Lanes - 1.5 Square Feet x Street Frontage

Existing Externally or Internally Illuminated - No Change in Electrical Service Non-Illuminated

(1-4) Area of Proposed Sign: 6.5 Square Feet
(1-3) Building Façade: 125 Linear Feet Building Façade Direction: North South East West
(4) Street Frontage: 130 Linear Feet Name of Street: N. Ave
(2-4) Height to Top of Sign: 16.5 Feet Clearance to Grade: 15 Feet

EXISTING SIGNAGE TYPE & SQUARE FOOTAGE:

<u>free-standing</u>	<u>108</u> Sq. Ft.
<u>flush wall</u>	<u>13</u> Sq. Ft.
_____	_____ Sq. Ft.
Total Existing:	<u>121</u> Sq. Ft.

FOR OFFICE USE ONLY

Signage Allowed on Parcel:			
2 x 125 Building	<u>250</u>	Sq. Ft.	
1.5 x 130 Free-Standing	<u>195</u>	Sq. Ft.	
Total Allowed:	<u>195</u>	Sq. Ft.	
	<u>-108</u>		
	<u>87</u>		

COMMENTS: The sign goes on a blank panel of an existing free-standing sign 80.5 left on free-standing

NOTE: No sign may exceed 300 square feet. A separate sign permit is required for each sign. Attach a sketch, to scale, of proposed and existing signage including types, dimensions and lettering. Attach a plot plan, to scale, showing: abutting streets, alleys, easements, driveways, encroachments, property lines, distances from existing buildings to proposed signs and required setbacks. Roof signs shall be manufactured such that no guy wires, braces or supports shall be visible.

I hereby attest that the information on this form and the attached sketches are true and accurate.

Larry F Bowles 10-8-09 [Signature] 10/20/09
Applicant's Signature Date Planning Approval Date

City of Grand Junction GIS City Map ©

2829 N. Ave

Existing free-standing

Parcels

 Address Label

Air Photos

 2008 Photos

 Highways

 Street Labels

City Limits

 Grand Junction

 Fruita

 Palisade

 Mesa County

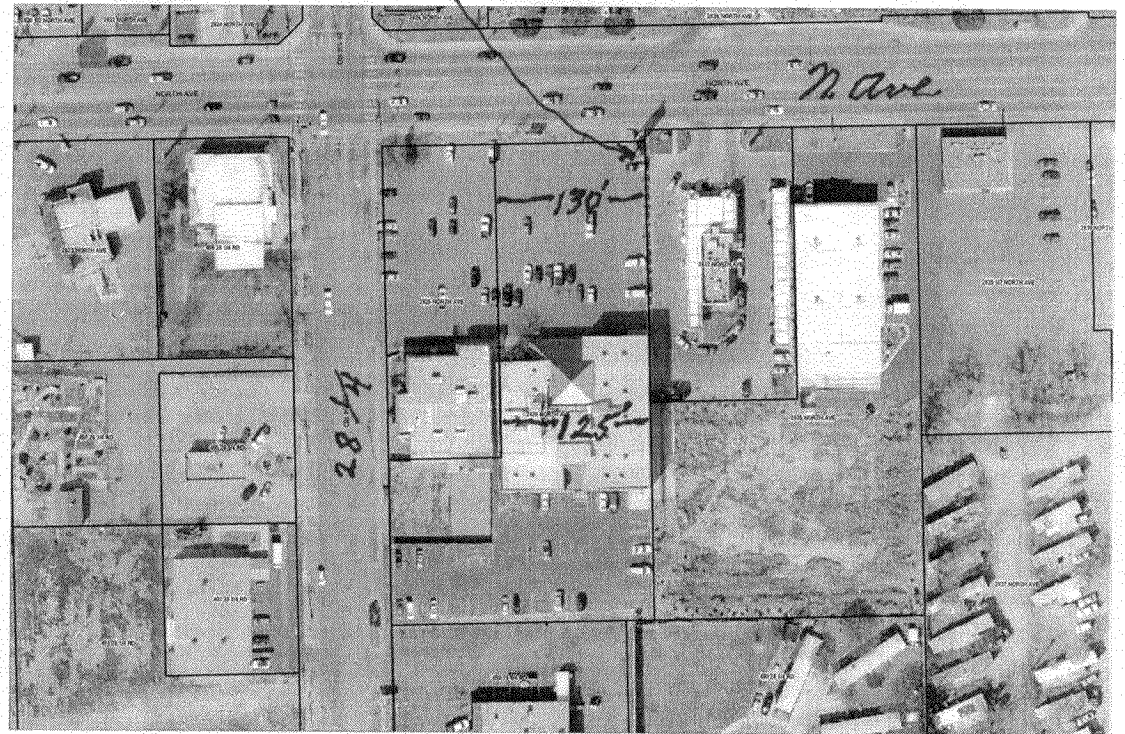

SCALE 1 : 1,963

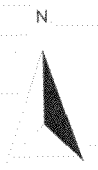
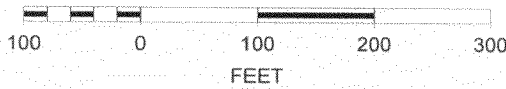

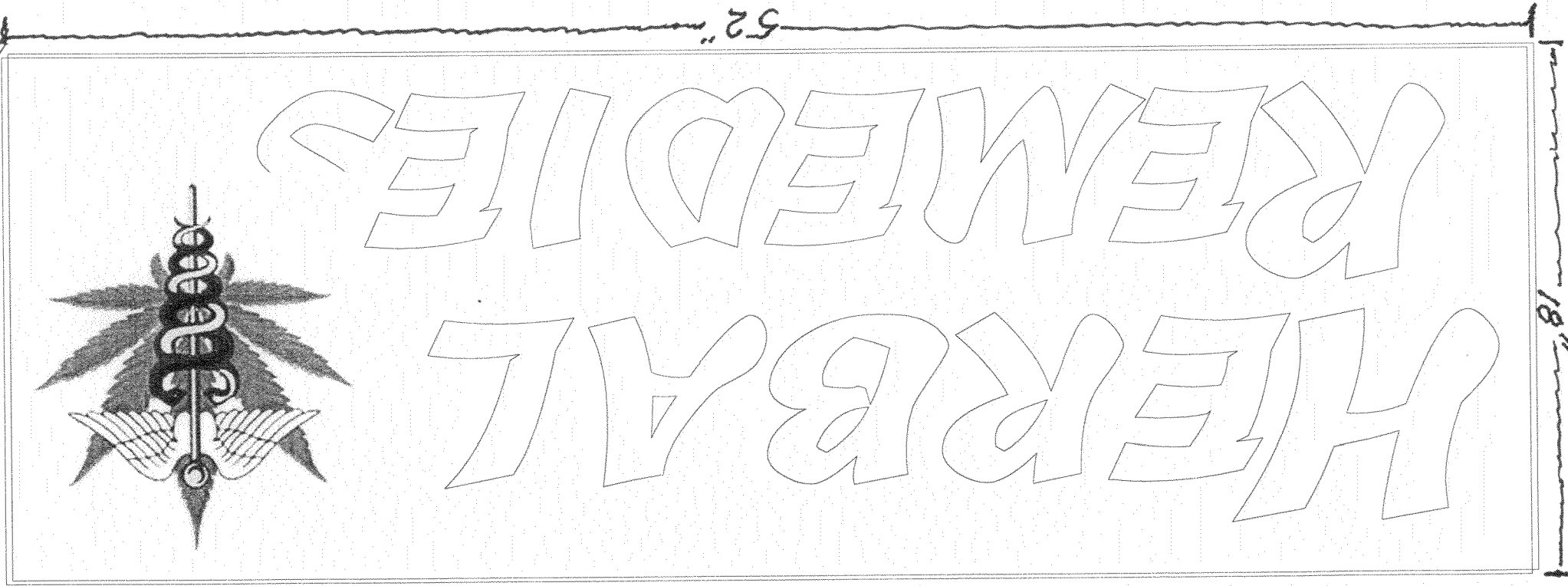

2829 N. Ave.
Suite 212

2829 N. ave.

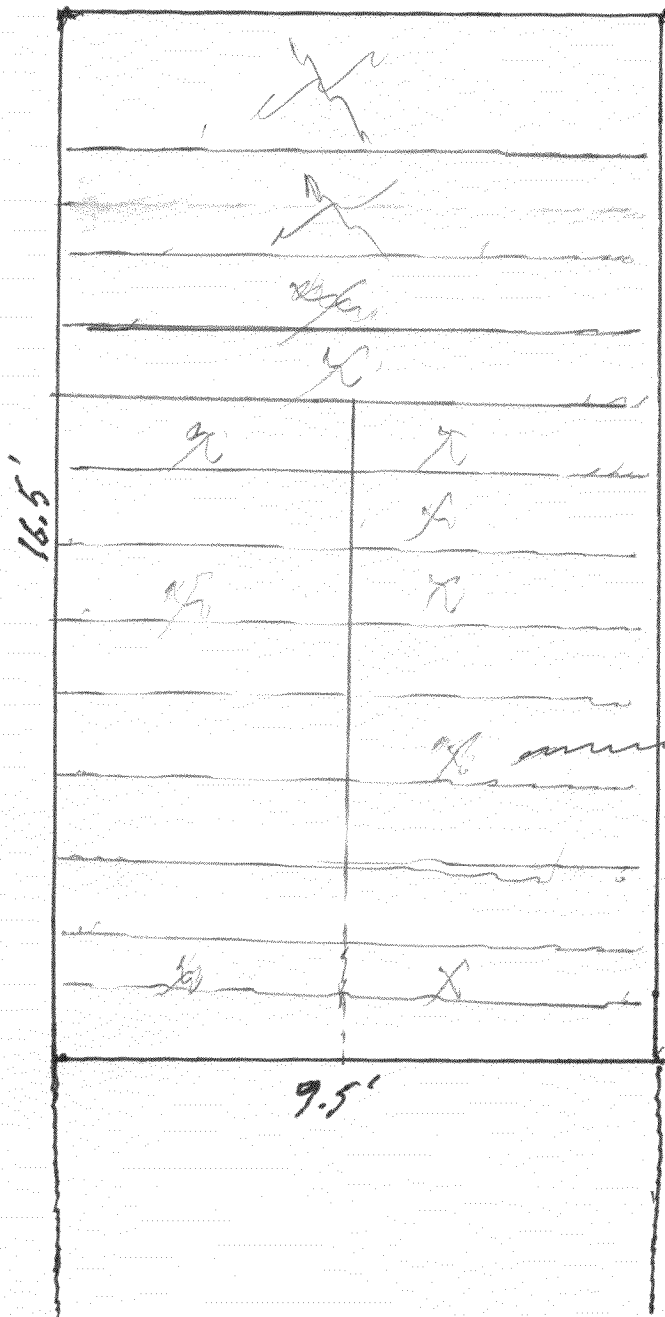

Proposed sign
of size 1.5' x 52" - 6.5'

Existing free-standing
sign. Proposed sign
will go on a blank
panel on the sign.