

A PLAT OF KEITH'S ADDITION TO GRAND JUNCTION, COLORADO.

Scale 1" = 100'

Var 14° 45' E

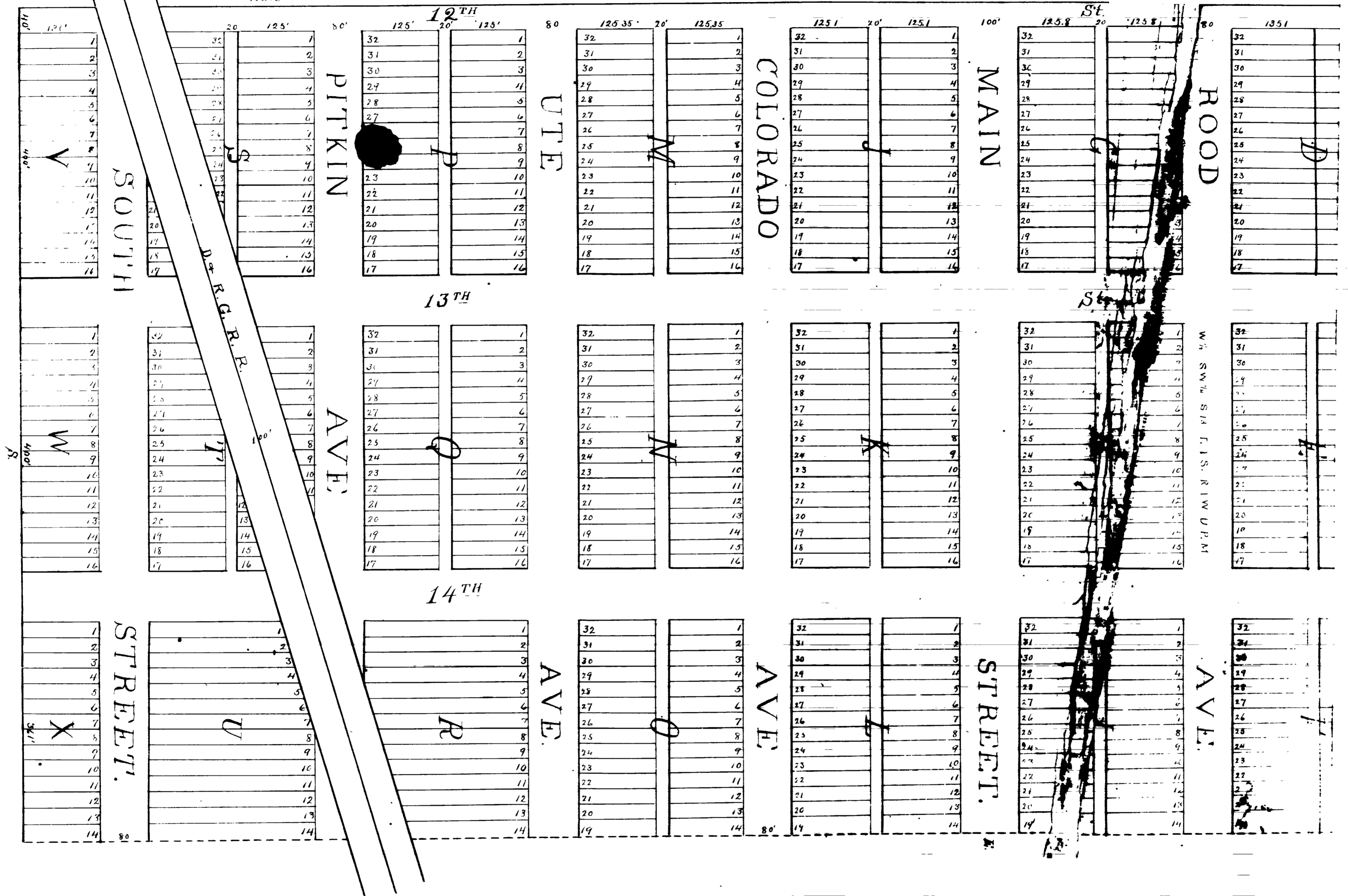

Know All men by these presents that the Grand Junction Land and Investment Company has laid out and divided the piece of land described as follows, to-wit: The West half of the South west one fourth Section Thirtieth 10th and 11th South Range Twp. 1st N. and 10th West Range Twp. 1st W. and mapped under the name of Keith's Addition to Grand Junction, Colorado, by these presents do hereby give notice to the public that the same is now open and all streets and alleys therein.

In witness whereof the said Grand Junction Land and Investment Company has caused its corporate seal to be hereunto affixed and these presents to be signed by its Secretary, this 29th day of May 1870.

W. A. Rice
Asst. Secy

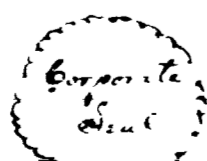

The Grand Junction Land and Investment Company
By Geo. Arthur Rice
President

Terrell, Willah }
County of Delta State }

On this 29th day of May 1870, I, Terrell Willah, do hereby certify that the Grand Junction Land and Investment Company is a corporation organized under the laws of the Territory of Colorado, and that the said company is authorized to do the business of buying and selling real estate, and that the said company is now open and all streets and alleys therein.



Witness my hand and seal of said County, this 29th day of May 1870.
Terrell Willah
County Clerk of Delta State