

# ANNEXATION MAP

The Southeast Quarter Section 7 Township 1 South Range 1 East, Ute Principal Meridian, Mesa County, Colorado.  
 That part of the Northeast Quarter Section 18, T1S, R1E U.P.M., lying North of U.S. Highway 6 and 24  
 The Northeast Quarter Northwest Quarter Section 18, T1S, R1E U.P.M.  
 The Southwest Quarter Northwest Quarter Section 7, T1S, R1E U.P.M. except that part which lies East of Indian Waste.  
 That part of North Half Southeast Quarter Northeast Quarter Section 7, T1S R1E U.P.M. which lies North of the Grand Valley Canal and West of Indian Waste.  
 All in Mesa County, Colorado.

ANNEXED BY COURT ORDER NO. 16298  
 DECEMBER 7, 1961

Total Area to be Annexed 350 acres

Present City Limits 

Proposed City Limits 

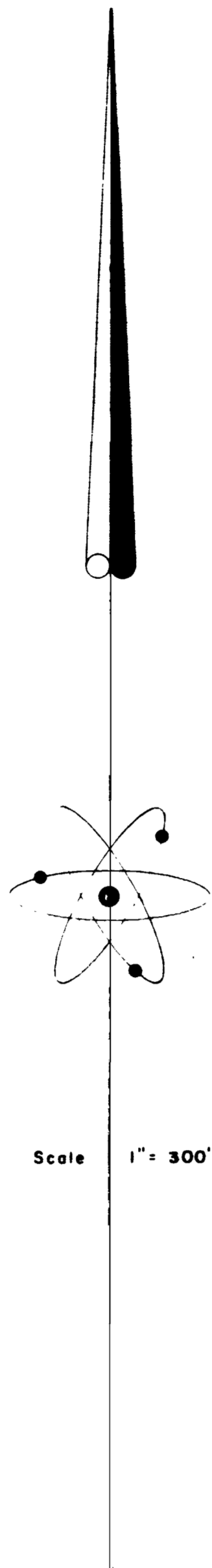

Scale 1" = 300'

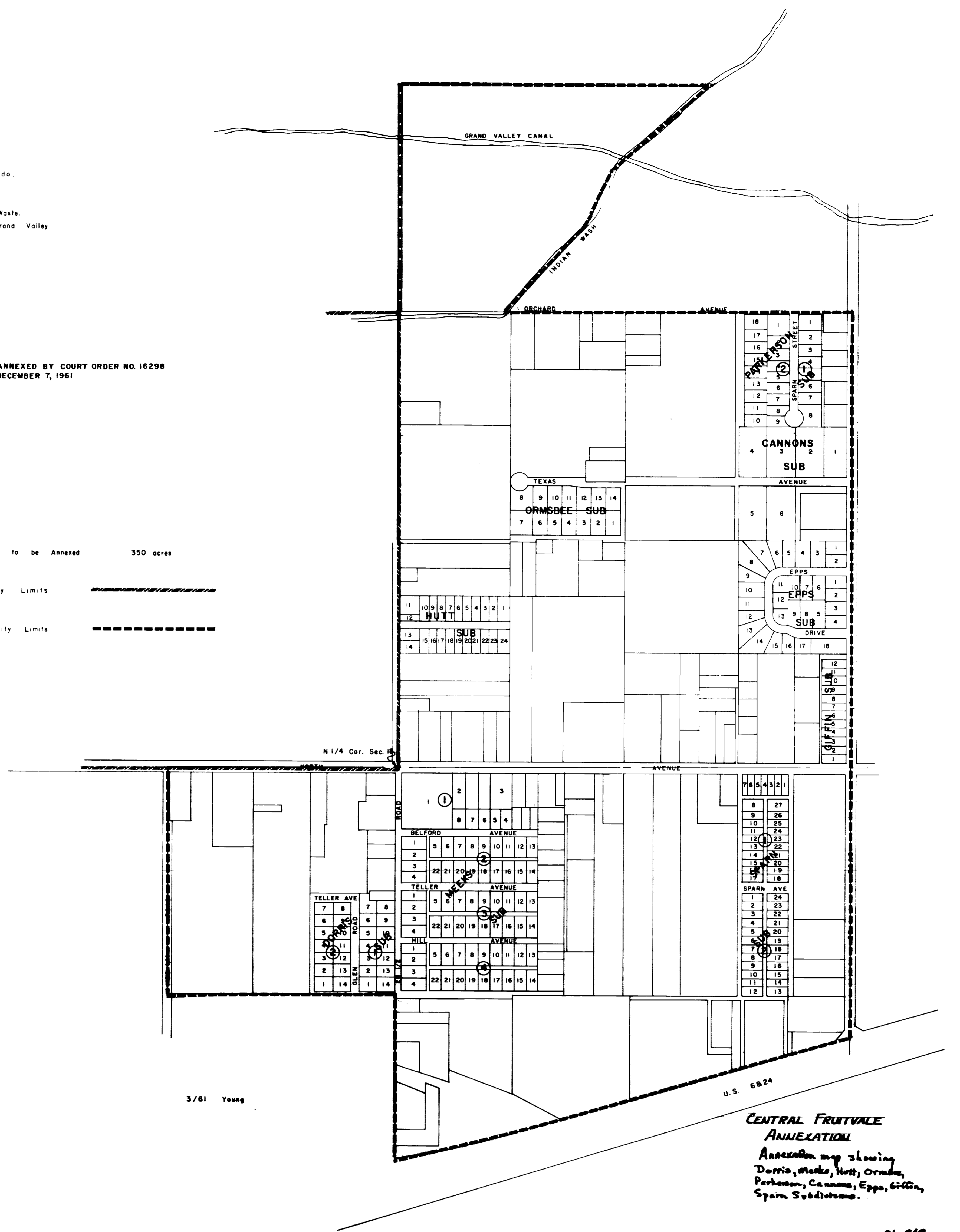

**CENTRAL FRUITVALE ANNEXATION**  
 Assessor map showing  
 Dorris, Meade, Hill, Ormsbee,  
 Parkman, Cannons, Epps, Giffin,  
 Spang Subdivisions.

01-845

13005301.tif

# ANNEXATION MAP

The NE 1/4 NW 1/4, Section 18 T1S R1E UM County of  
 Mesa, State of Colorado.

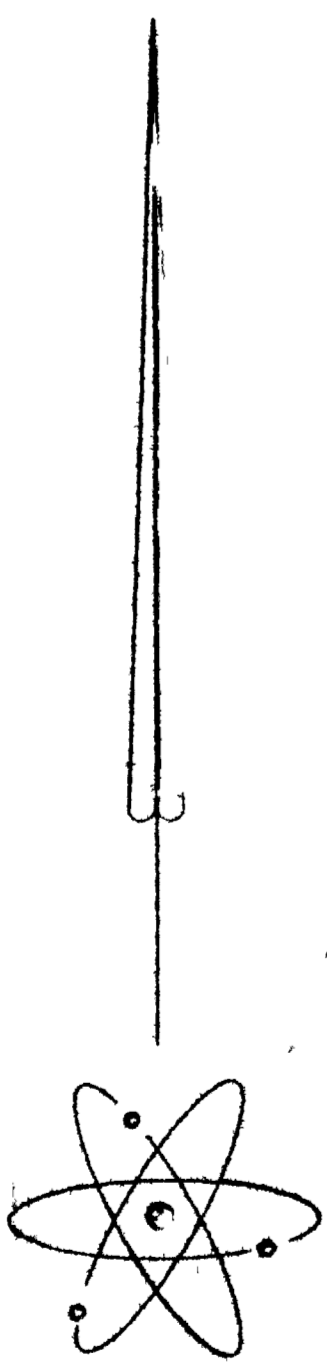

Scale 1" = 60'

Present City Limits 

Proposed City Limits 

Area to be Annexed 40 Acres



13005301.tif