

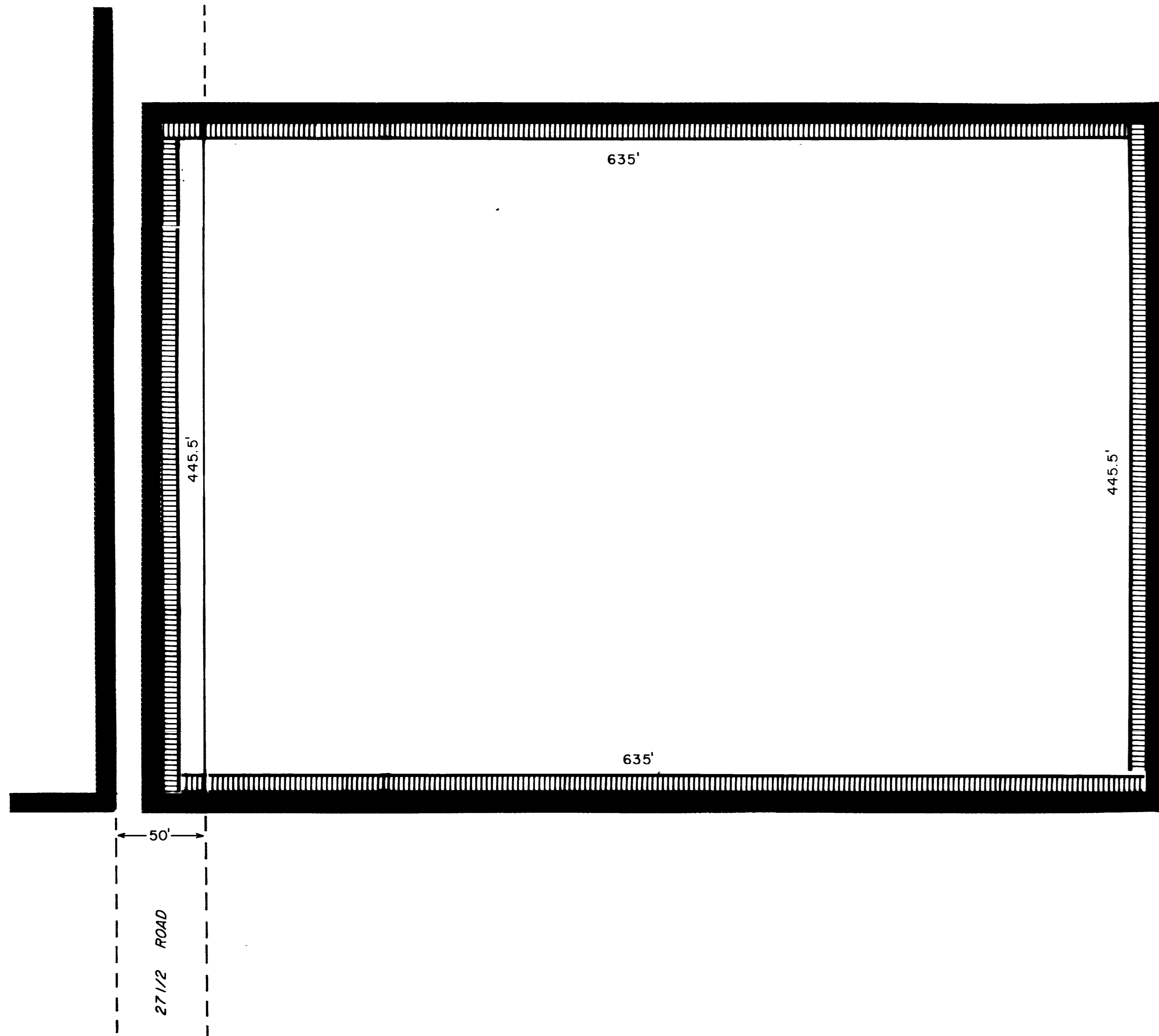

1" = 50'

PEACH ANNEXATION NO. 3



DESCRIPTION

THE WEST ONE HALF OF THE SOUTH
 135 ACRES OF THE NORTHWEST 1/4
 OF THE SOUTHEAST 1/4 OF SECTION 1
 TOWNSHIP 1 SOUTH, RANGE 1 WEST UTE
 MERIDIAN, EXCEPT THE WEST 25 FEET
 THEREOF.

LEGEND

BOUNDARY OF EXISTING CITY LIMITS ———— 

BOUNDARY OF NEW CITY LIMITS ———— 

AREA OF ANNEXATION

EXISTING BOUNDARY CONTIGUOUS TO CITY LIMITS ———— 2161.0'

PERIMETER OF AREA TO BE ANNEXED ———— 2161.0'

TOTAL ANNEXED AREA IN SQUARE FEET ———— 282,892.5' SQ. FT.

TOTAL ANNEXED AREA IN ACRES ———— 6.5 ACRES

ENGINEERS CERTIFICATE

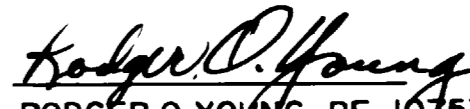
APPROVED FOR CITY
 OF GRAND JUNCTION

 RODGER O. YOUNG P.E. 1053
 CITY ENGINEER

ORD 1522