

BLOCK 16 FAIRMOUNT ANNEXATION

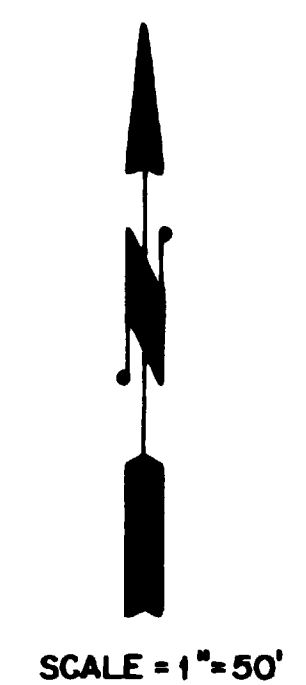

LEGAL DESCRIPTION

Part of the Southwest one quarter Section 1, Township 1 South, Range 1 West, Ute Principal Meridian.

More particularly described as: Block 16 Fairmount Subdivision, Mesa County Colorado together with all dedicated road rights of way to the center of North 13 th, North 15 th, Hermosa Avenue and F 1/4 Road that are associated with this property.

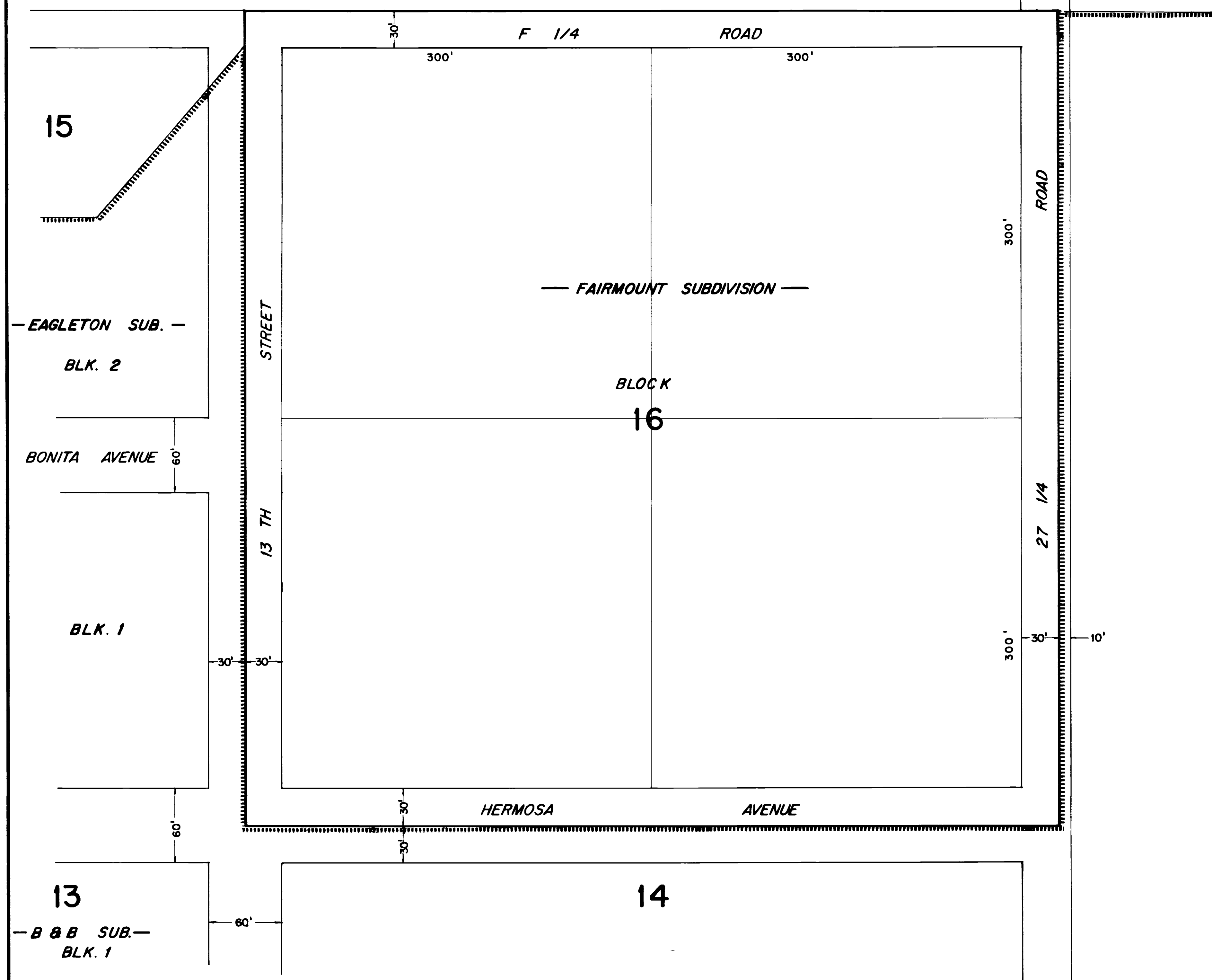

LEGEND

Boundary of existing corporate limits —————
 Boundary of new corporate limits —————

AREA OF ANNEXATION

Existing boundary contiguous to corporate limits ————— 1,890.0 FT.
 Perimeter of area to be annexed ————— 2,640.0 FT.
 Total annexed area in square feet ————— 435,600.0 SQ. FT.
 Total annexed area in acres ————— 10.0 ACRES

ENGINEER'S CERTIFICATE

I, Ronald P. Rish a Registered Professional Engineer hereby certify that the accompanying plat and legal description of Block 16 Fairmount Subdivision Annexation was prepared under my direct supervision from information secured from the Mesa County Clerk and Recorder's and Assessor's office.

SIGNED Ronald P. Rish
 DATE Dec. 7, 1976
 ORDINANCE N^o 1640
 EFFECTIVE DATE JANUARY 5, 1977

DEPARTMENT OF PUBLIC WORKS ENGINEERING DIVISION CITY OF GRAND JUNCTION, COLORADO			
BLOCK 16 FAIRMOUNT SUBDIVISION ANNEXATION			
DRAWN BY: <u>RPR</u>	DATE: <u>11-5-76</u>	HORIZONTAL SCALE: <u>1"=50'</u>	VERTICAL SCALE: <u>None</u>
CHECKED BY:	DATE:	FIELD BOOK N ^o	SHEET
APPROVED BY:	DATE:	PAGE N ^o	DRWG. N ^o