

NW Corner
Section 9

NE Corner
Section 9

RIVER ROAD ANNEXATION

Section Line

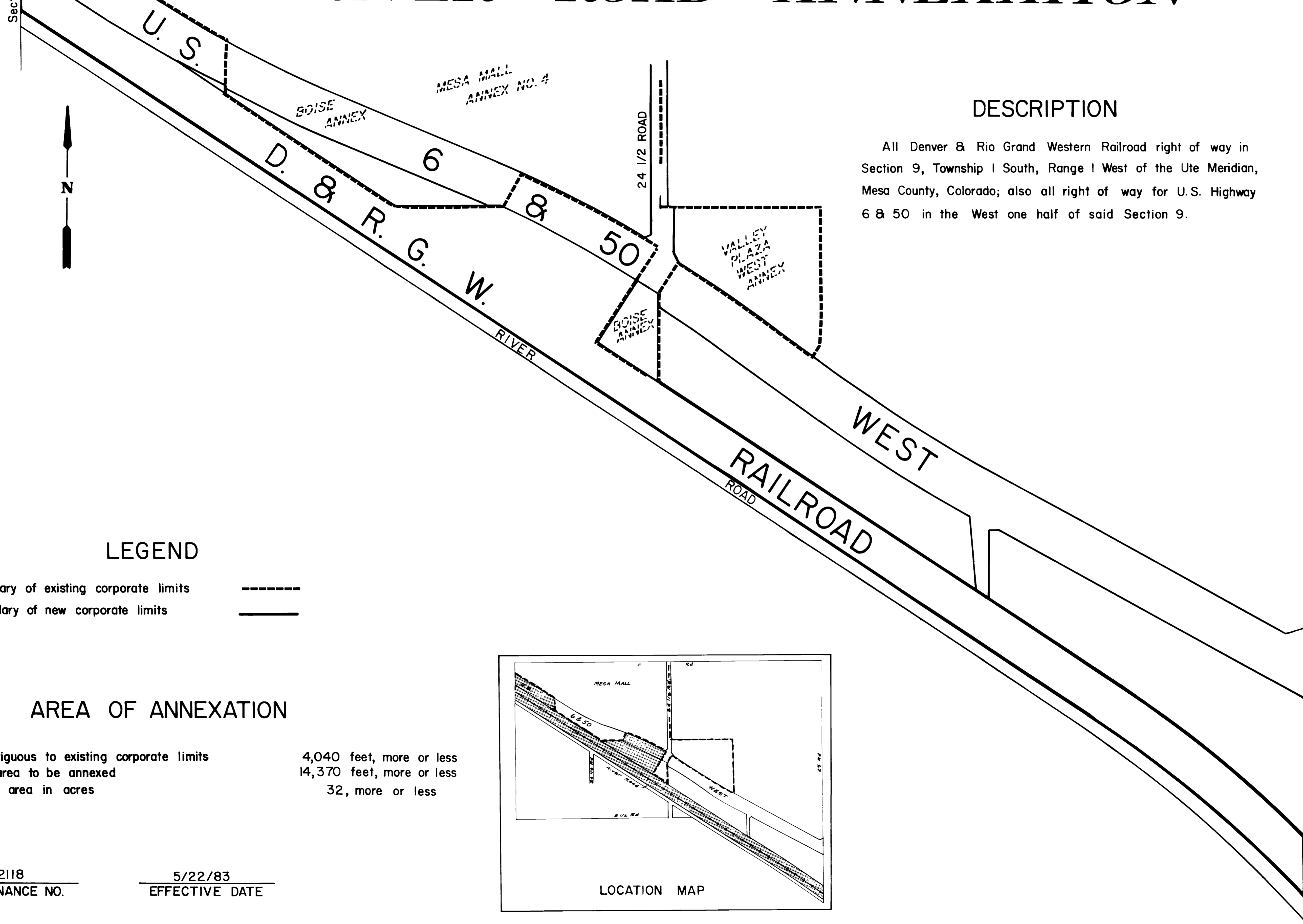

DESCRIPTION

All Denver & Rio Grand Western Railroad right of way in Section 9, Township 1 South, Range 1 West of the Ute Meridian, Mesa County, Colorado; also all right of way for U.S. Highway 6 & 50 in the West one half of said Section 9.

LEGEND

Boundary of existing corporate limits -----
Boundary of new corporate limits _____

AREA OF ANNEXATION

Boundary contiguous to existing corporate limits 4,040 feet, more or less
Perimeter of area to be annexed 14,370 feet, more or less
Total annexed area in acres 32, more or less

2118
ORDINANCE NO.

5/22/83
EFFECTIVE DATE

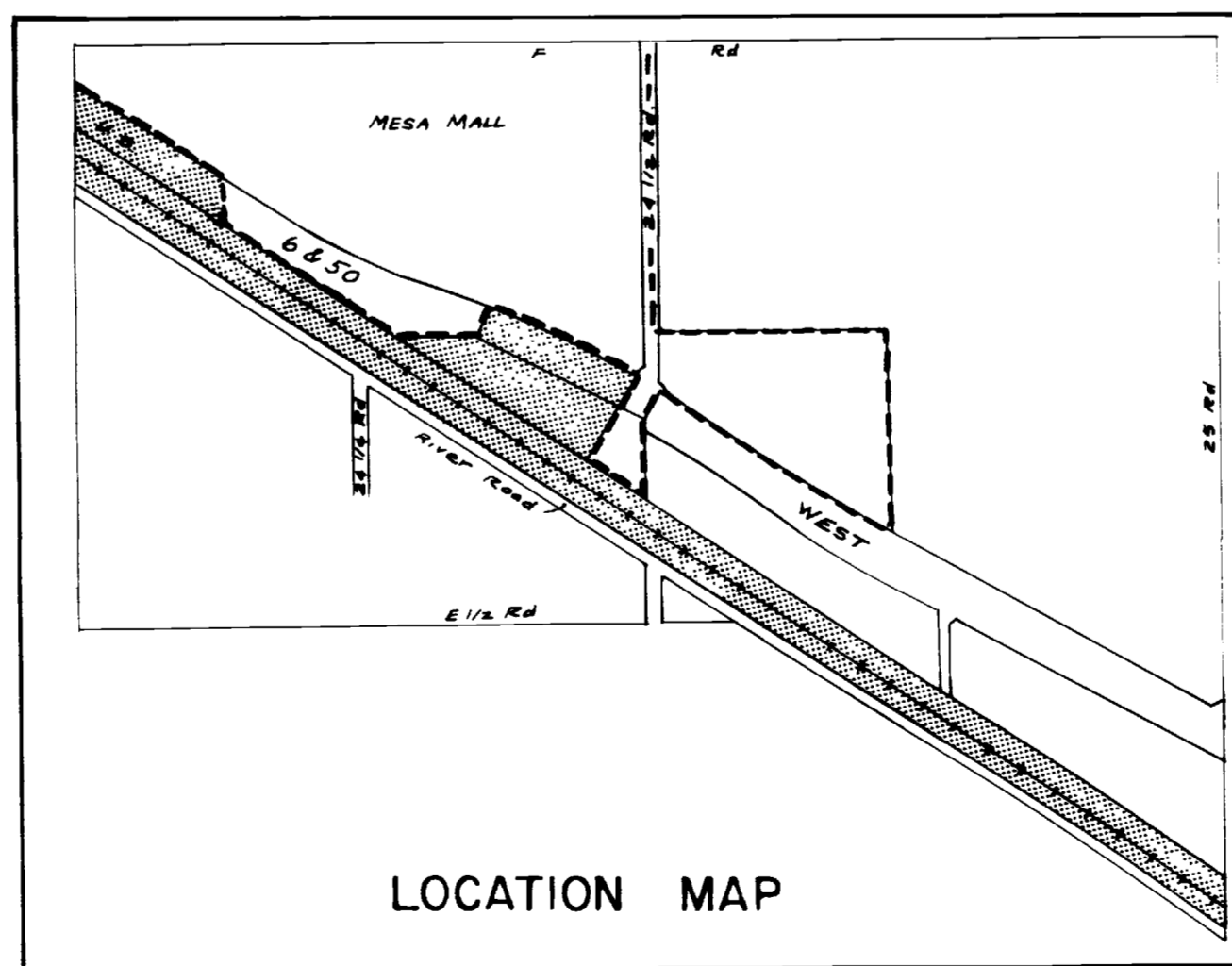

| | | | | | | | |
|----------|-------------|------|----------------|---------|-------|--------------|---------|
| REVISION | DESCRIPTION | DATE | DRAWN BY | DATE | SCALE | PLAN | PROFILE |
| REVISION | | | TH | 4/21/83 | | | |
| REVISION | | | CHECKED BY | DATE | | | |
| REVISION | | | APPROVED BY | DATE | | | |
| REVISION | | | FIELD BOOK NO. | PAGE | | not to scale | |

DEPARTMENT OF PUBLIC WORKS AND UTILITIES
ENGINEERING DIVISION
CITY OF GRAND JUNCTION, COLORADO

RIVER ROAD ANNEXATION

SHEET NO. 1
OF 1
FILE NO.