

# PAINTED BOWL ANNEXATION #1

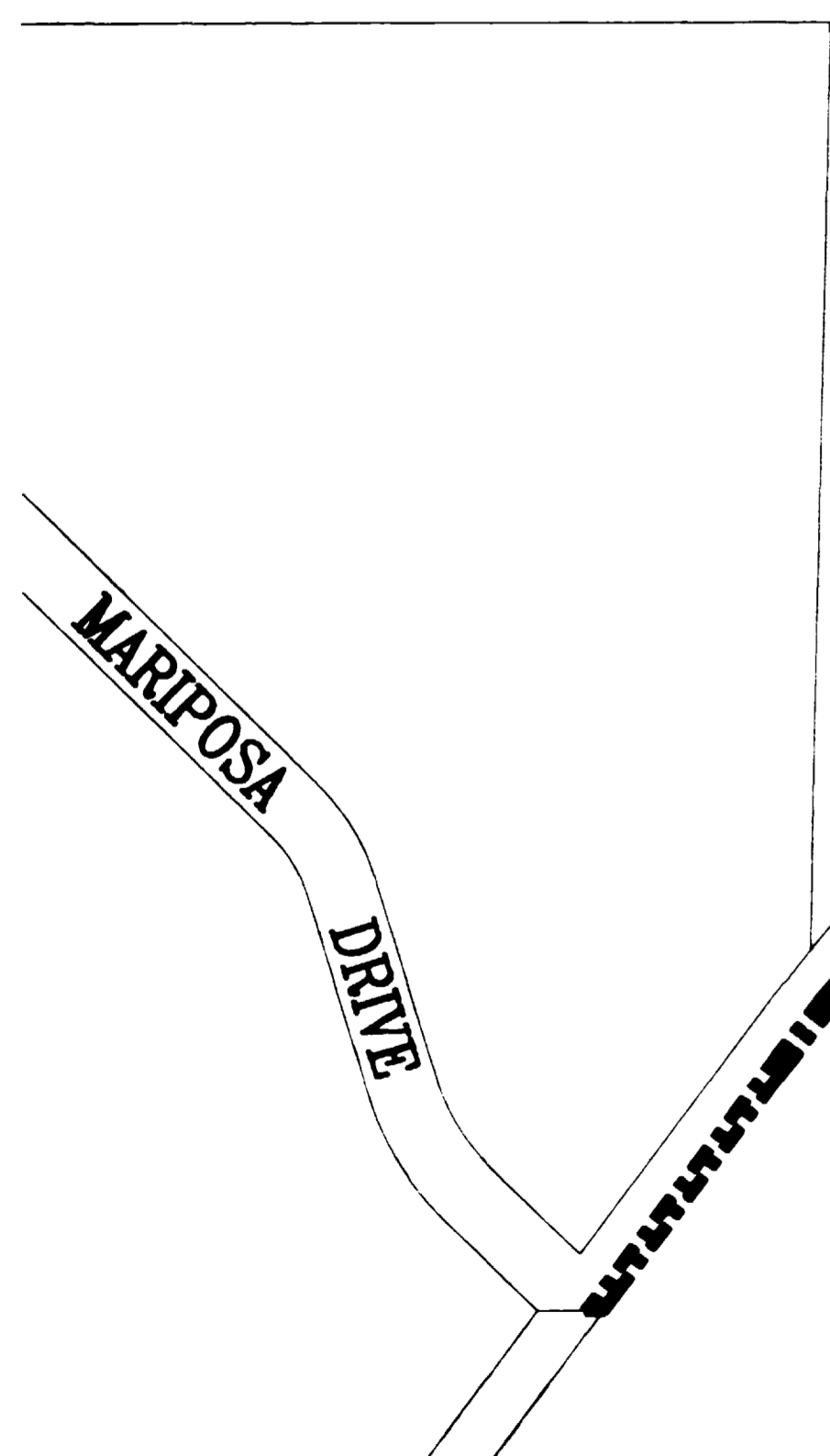
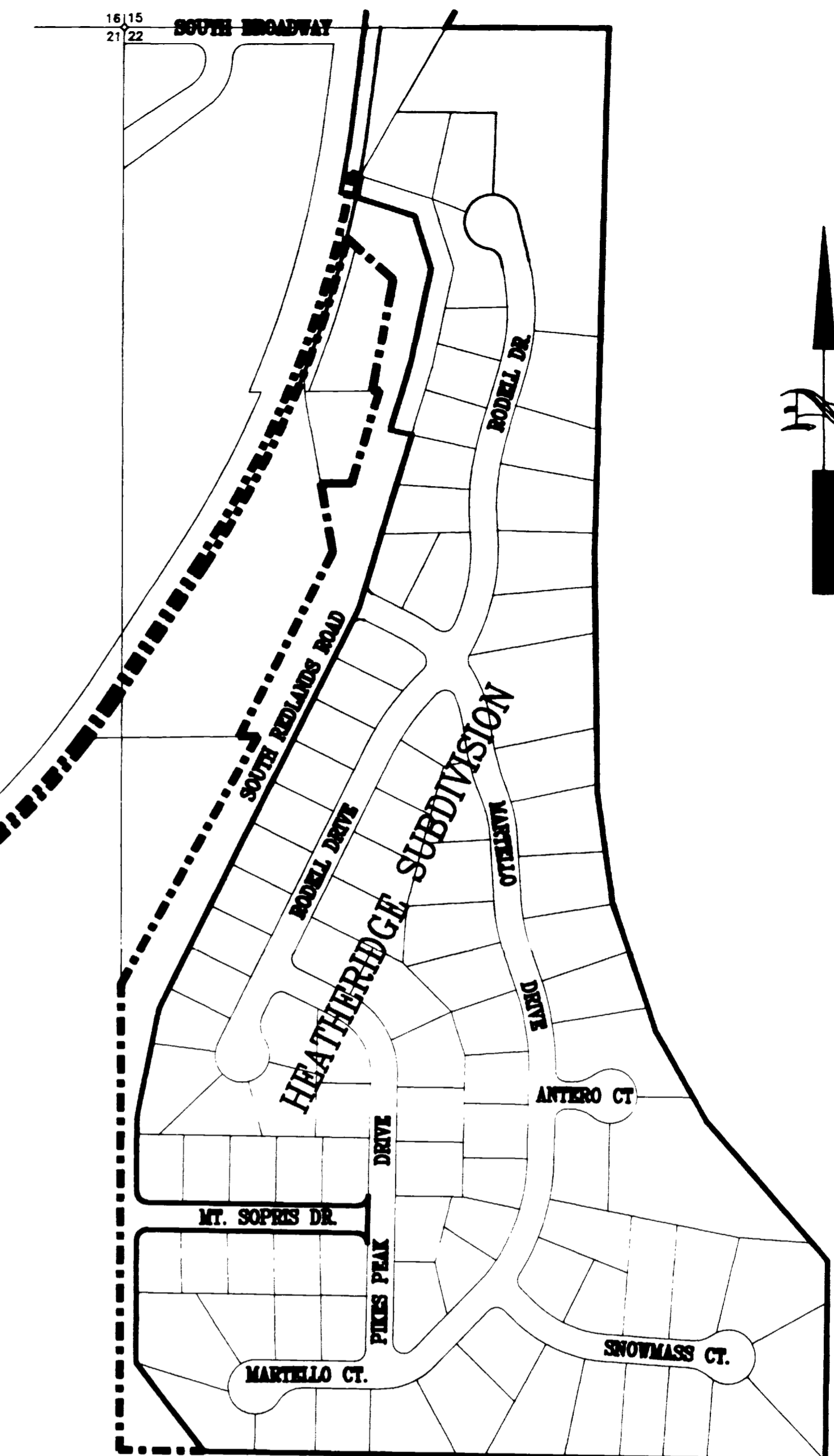

MONUMENT ROAD

### LEGEND

- Annexation Boundary
- Existing City Limits

### AREA OF ANNEXATION

Annexation Perimeter	18,536
Contiguous Perimeter	3,554
Area in Square Feet	192,212
Area in Acres	4.41

### DESCRIPTION

All of Mt. Sopris Drive platted in Heatheridge Subdivision, and all of the public right-of-way of South Redlands Road adjacent to Heatheridge Subdivision, and the Southerly one foot of the public right-of-way of Monument Road from the intersection of the North right-of-way line of South Redlands Road to a point on a line projected Easterly from the intersection of the Southwesterly right-of-way line for Miraposa Drive as dedicated in Book 1037, Pages 381 and 382, and the Northwesterly right-of-way line for Monument Road as dedicated in Book 963, Page 135 of the records of the Mesa County Clerk and Recorder.

### ORDINANCE NUMBER

2490

### EFFECTIVE DATE

12/9/90

This annexation plat has been prepared under my direction. The Legal Description(s) contained herein have been derived from subdivision plats and deed description as they appear in the office of the Mesa County Clerk and Recorder. This plat does not constitute a legal survey, and is not intended to be used as a means for establishing or verifying property boundary lines.

*J. Don Newton*  
J. Don Newton, City Engineer

REVISION	DESCRIPTION	DATE	DRAWN BY	KADEL	DATE	10/90	SCALE
			CHECKED BY		DATE		PLAN
			APPROVED BY		DATE		1"=200'
			FIELD BOOK NO.		PAGE		HORIZ.
							VERT.

DEPARTMENT OF PUBLIC WORKS AND UTILITIES  
ENGINEERING DIVISION  
CITY OF GRAND JUNCTION, COLORADO

PAINTE BOWL ANNEXATION #1

SHEET NO.	1
OF	1
FILE NO.	PAINT1.DWG