

PAINTED BOWL ANNEXATION #4

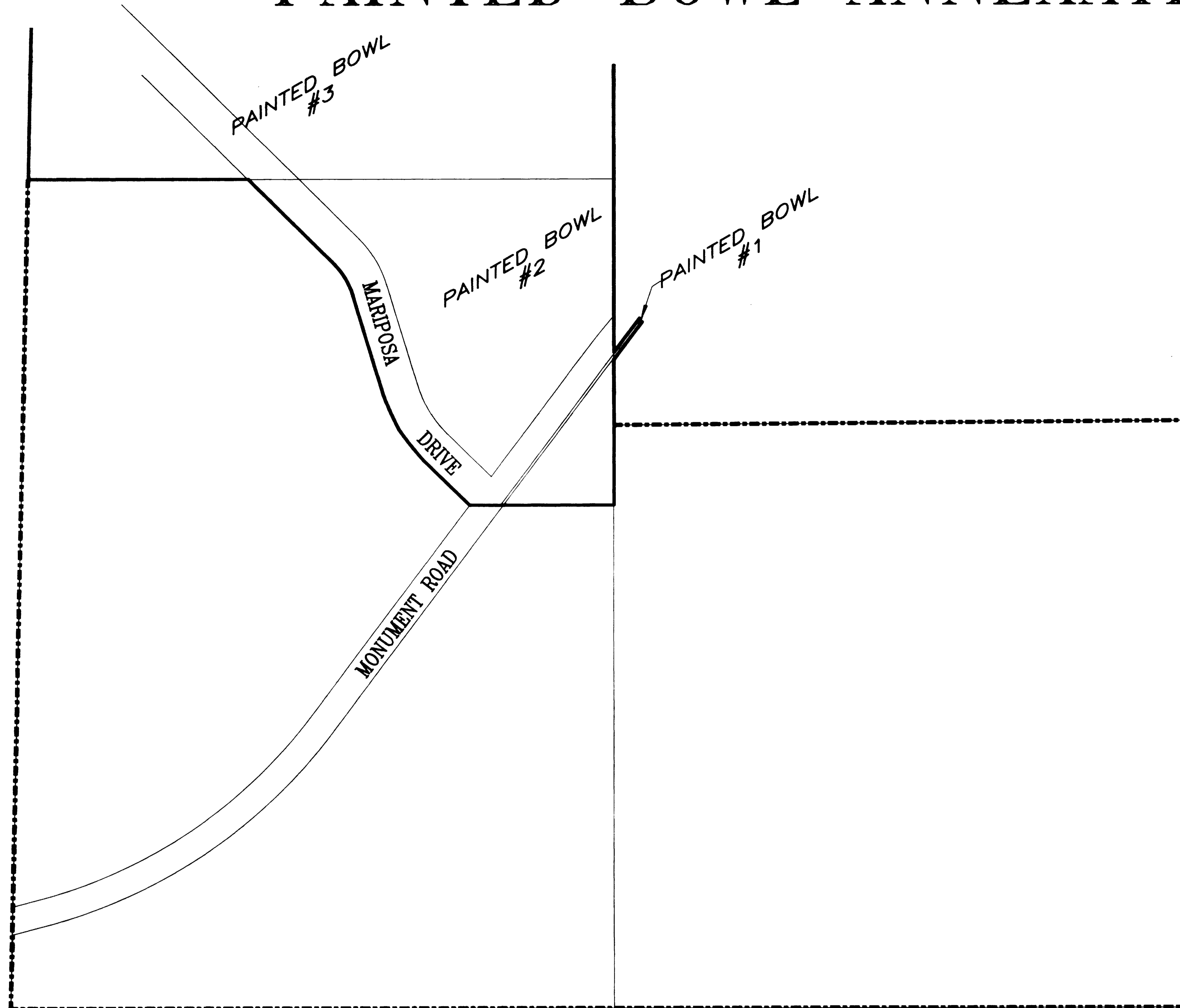

DESCRIPTION

All of the South 1/2 of the West 1/4 of Section 21, T1S R1W of the Ute Meridian and the SE 1/4 SW 1/4 of said Section 21 of the Ute Meridian, except that property described in Painted Bowl Annexations #2 and #3.

LEGEND

Annexation Boundary
 Existing City Limits

AREA OF ANNEXATION

Annexation Perimeter	7,181'
Contiguous Perimeter	1,517,
Area in Square Feet	2,387,170
Area in Acres	54.82

ORDINANCE NUMBER
2493

EFFECTIVE DATE
12/9/90

This annexation plat has been prepared under my direction. The Legal Description(s) contained herein have been derived from subdivision plats and deed descriptions as they appear in the office of the Mesa County Clerk and Recorder. This plat does not constitute a legal survey, and is not intended to be used as a means for establishing or verifying property boundary lines.

J. Don Newton
J. Don Newton, City Engineer

REVISION	DESCRIPTION	DATE	DRAWN BY	L. MARTIN	DATE	9/90	SCALE	PLAN	PROFILE
REVISION			CHECKED BY	BL	DATE	10/90		HORIZ.	N.T.S.
REVISION			APPROVED BY		DATE			HORIZ.	
REVISION			FIELD BOOK NO.		PAGE			VERT.	

DEPARTMENT OF PUBLIC WORKS AND UTILITIES
 ENGINEERING DIVISION
 CITY OF GRAND JUNCTION, COLORADO

PAINTED BOWL ANNEXATION #4

SHEET NO.	1
OF	1
FILE NO.	PAINT4.DWG