

PAINTED BOWL ANNEXATION #3

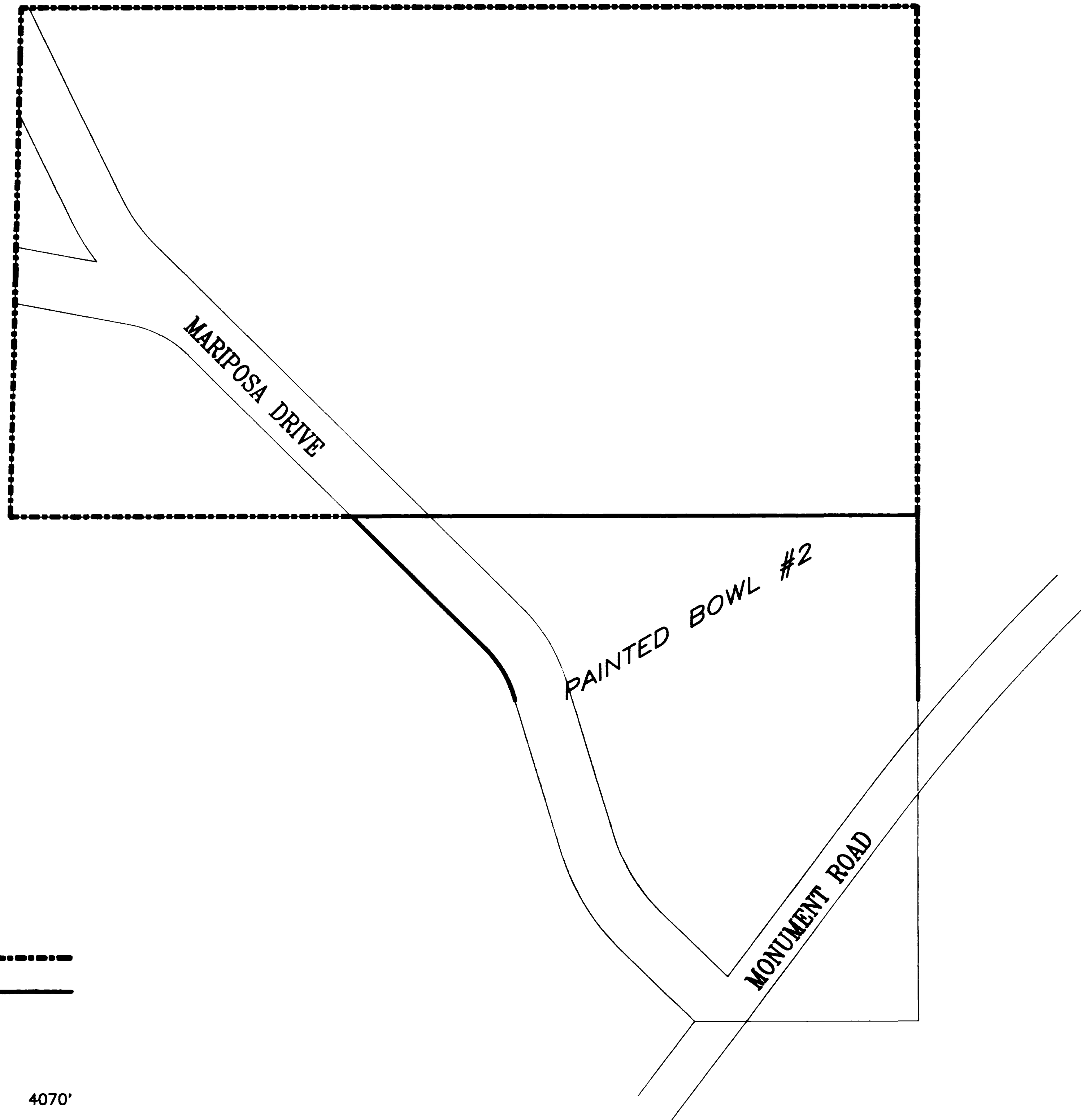

DESCRIPTION

All of the North 1/4 of the South 1/2 of the West 1/4 of Section 21, T1S, R1W of the Ute Meridian.

ORDINANCE NUMBER
2492

EFFECTIVE DATE
12/9/90

LEGEND

Annexation Boundary
Existing City Limits

AREA OF ANNEXATION

Annexation Perimeter 4070'
Contiguous Perimeter 820'
Area in Square Feet 955,180
Area in Acres 21.93

This annexation plat has been prepared under my direction. The Legal Description(s) contained herein have been derived from subdivision plats and deed descriptions as they appear in the office of the Mesa County Clerk and Recorder. This plat does not constitute a legal survey, and is not intended to be used as a means for establishing or verifying property boundary lines.

Don Newton
Don Newton, City Engineer

REVISION	DESCRIPTION	DATE	DRAWN BY	L. MARTIN	DATE	9/90	SCALE	PLAN	PROFILE
REVISION			CHECKED BY	B.L.	DATE	10/90		HORIZ. N.T.S.	HORIZ. N.T.S.
REVISION			APPROVED BY		DATE				
REVISION			FIELD BOOK NO.		PAGE			VERT.	

DEPARTMENT OF PUBLIC WORKS AND UTILITIES
ENGINEERING DIVISION
CITY OF GRAND JUNCTION, COLORADO

PAINTED BOWL ANNEXATION #3

SHEET NO.	1
OF	1
FILE NO.	PAINT3.DWG