

INTERSTATE ANNEXATION #1

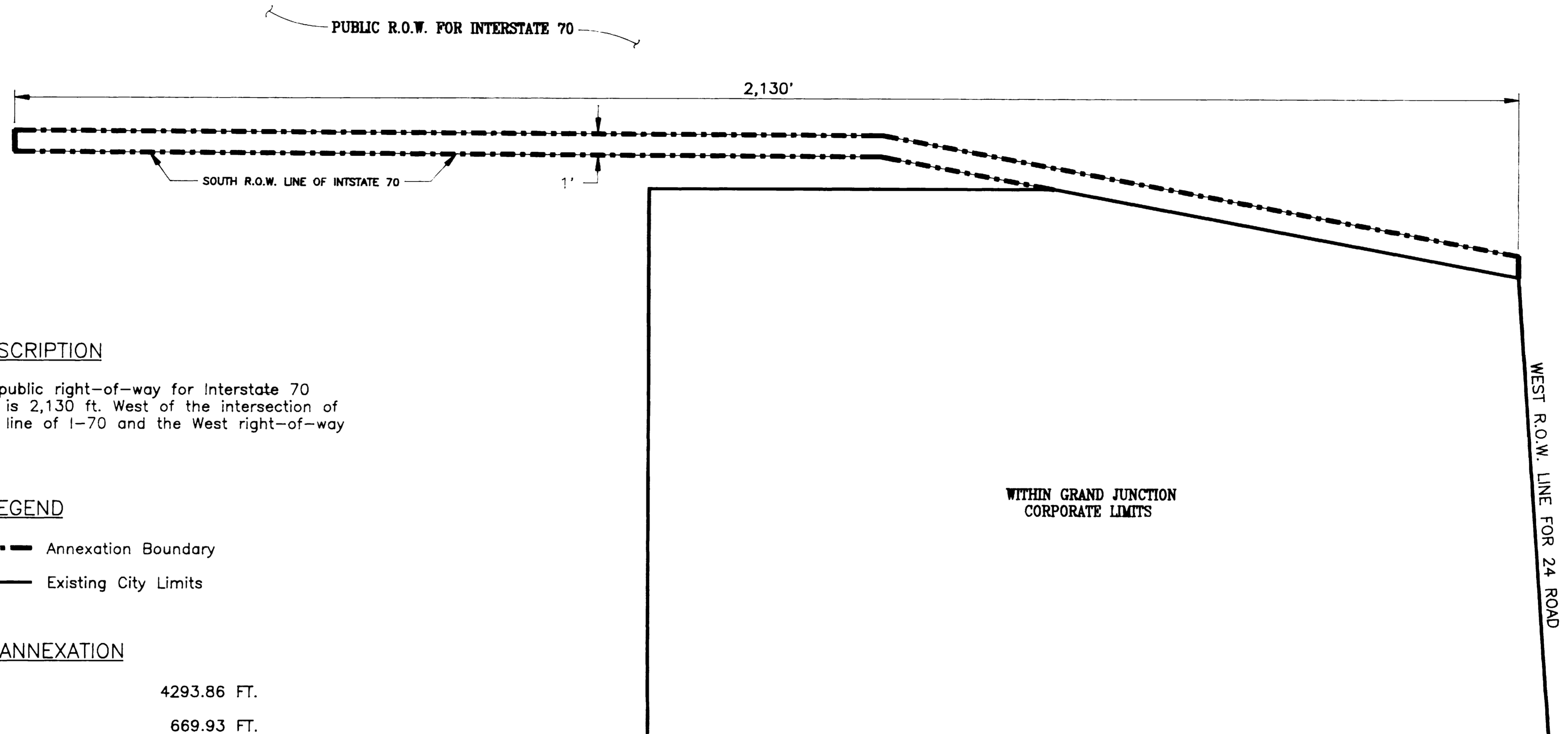

DESCRIPTION

The Southerly one foot of public right-of-way for Interstate 70 extending to a point which is 2,130 ft. West of the intersection of the Southerly right-of-way line of I-70 and the West right-of-way line of 24 road.

LEGEND

- Annexation Boundary
- _____ Existing City Limits

AREA OF ANNEXATION

Annexation Perimeter	4293.86 FT.
Contiguous Perimeter	669.93 FT.
Area in Square Feet	2,145.92
Area in Acres	0.049

ORDINANCE NUMBER
2522

EFFECTIVE DATE
AUG. 4, 1991

The Legal Description(s) contained herein have been derived from subdivision plats and deed description as they appear in the office of the Mesa County Clerk and Recorder. This plat does not constitute a legal survey, and is not intended to be used as a means for establishing or verifying property boundary lines.

J. Don Newton
J. Don Newton, City Engineer

DESCRIPTION	DATE	DRAWN BY	KADEL	DATE	4/91	SCALE	
REVISION		CHECKED BY		DATE		PLAN	PROFILE
REVISION		APPROVED BY	J.D.N.	DATE	4/91	HORIZ.	N.T.S.
REVISION		FIELD BOOK NO.		PAGE		HORIZ.	
						VERT.	

DEPARTMENT OF PUBLIC WORKS AND UTILITIES
ENGINEERING DIVISION
CITY OF GRAND JUNCTION, COLORADO

INTERSTATE ANNEXATION #1

SHEET NO.	1
OF	1
FILE NO.	INSTATE1.DWG