

CLARK/WILSON ENCLAVE ANNEXATION

SITUATE IN THE NW 1/4 & SW 1/4, SECTION 3, T1S, R1W, U.M.
 COUNTY OF MESA, STATE OF COLORADO

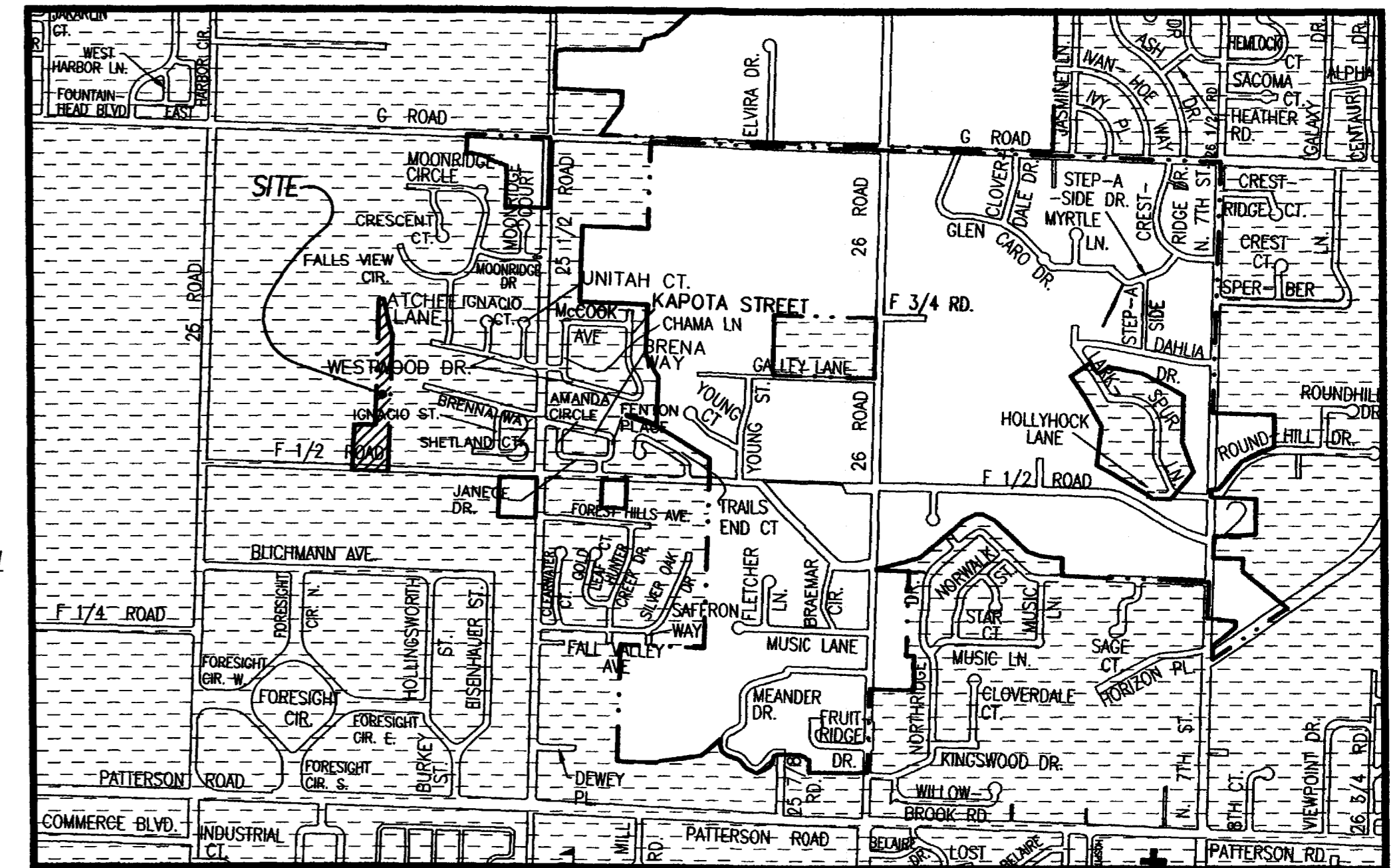

PERSIGO ANNEXATION
 ORDINANCE NO.1975
 EFFECTIVE DATE 7-5-81

POMONA PARK ANNEXATION
 ORDINANCE NO.2825
 EFFECTIVE DATE 5-7-95

DIAMOND RIDGE ANNEXATION
 ORDINANCE NO.3105
 EFFECTIVE DATE 4-4-1999

MC KEE ANNEXATION
 ORDINANCE NO.1886
 EFFECTIVE DATE 6-22-80

WESTWOOD RANCH ANNEXATION
 ORDINANCE NO.2987
 EFFECTIVE DATE 4-6-97

SHERIFFS POSSE ANNEXATION
 ORDINANCE NO.2146
 EFFECTIVE DATE 10-23-83

FORSIGHT PARK ANNEXATION
 ORDINANCE NO.1804
 EFFECTIVE DATE 4-22-79

1480 ANNEXATION
 ORDINANCE NO.2061
 EFFECTIVE DATE 7-4-82

LEGAL DESCRIPTION

A parcel of land situate in the NW 1/4 and SW 1/4 of Section 3, Township 1 South, Range 1 West of the Ute Meridian, County of Mesa, State of Colorado, being more particularly described as follows:

Commencing at the CW 1/16 corner of Section 3; thence N 89°57'00" W along the south line of the SW 1/4 NW 1/4 of said Section 3 a distance of 165.00 feet to the True Point of Beginning for the parcel described herein; thence N 00°01'03" W a distance of 330.00 feet to a point; thence S 89°57'00" E a distance of 165.00 feet to a point on the west line of the SE 1/4 NW 1/4 of said Section 3; thence N 00°01'03" W along the west line of said SE 1/4 NW 1/4 a distance of 981.62 feet to the NW 1/16 corner of said Section 3; thence S 89°31'00" E along the north line of the SE 1/4 NW 1/4 of said Section 3 a distance of 64.52 feet to a point on the northeasterly right of way line for the Grand Valley Canal a distance of 213.81 feet to a point; thence leaving said northeasterly right of way line S 00°01'03" E a distance of 1123.68 feet to a point; thence S 89°57'00" E along a line 20.00' south of and parallel with the north line of the NE 1/4 SW 1/4 of said Section 3 a distance of 64.92 feet to a point; thence S 00°05'40" W a distance of 13.00 feet to a point on the south right of way line for F 1/2 Road; thence N 89°57'00" W along said south right of way line a distance of 345.89 feet to a point; thence N 00°01'03" W a distance of 33.00 feet to a point on the north line of the NW 1/4 SW 1/4 of said Section 3 and point of beginning.



GRAPHIC SCALE

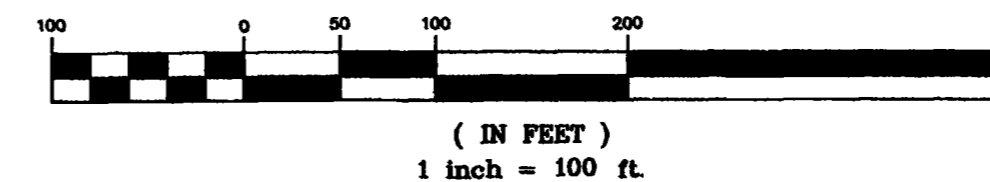

AREA OF ANNEXATION

ANNEXATION PERIMETER	3335.44 FT.
CONTIGUOUS PERIMETER	3335.44 FT.
AREA IN SQUARE FEET	211,338.07
AREA IN ACRES	4.85

LEGEND

ANNEXATION BOUNDARY	—————
EXISTING CITY LIMITS	- - - - -

ORDINANCE NO.
3266

EFFECTIVE DATE
AUGUST 6, 2000

The Description(s) contained herein have been derived from subdivision plats and deed descriptions as they appear in the office of the Mesa County Clerk and Recorder. They constitute a legal survey, and is not intended to be a means for establishing or verifying property boundaries.

Stan R. Pace
 SENIOR REAL ESTATE TECHNICIAN, PLS 22580

Notice: According to Colorado law you have 60 days from the effective date shown hereon to file a complaint based upon any defect on this plat. If no complaint is filed within said 60 days then said plat stands despite all defects and or errors.	DRAWN BY SRP DATE 5-10-2000	SCALE 1" = 100'
	DESIGNED BY _____ DATE _____	
	CHECKED BY _____ DATE _____	
	APPROVED BY _____ DATE _____	

DEPARTMENT OF PUBLIC WORKS AND UTILITIES
 ENGINEERING AND TECHNICAL SERVICES DIVISIONS
 CITY OF GRAND JUNCTION, COLORADO

CLARK / WILSON ENCLAVE ANNEXATION
 CLARK.DWG