

City  County

APPLICATION FOR THE PLANNING CLEARANCE FOR A BUILDING PERMIT

SUBMITTALS REQUIRED: (2) Plot Plans showing Parking, Landscaping, Setbacks to all property lines, and all streets which abut the parcel:

BLDG ADDRESS: 3050 No 13<sup>th</sup>  
SUBDIVISION: Fairmount North Sub  
FILING # \_\_\_\_\_ BLK # 1 LOT # 1  
TAX SCHEDULE NUMBER:  
2945-013-05-001  
PROPERTY OWNER: Mike Gillin  
ADDRESS: 3050 No 13<sup>th</sup>  
PHONE: 245-2469  
DESCRIPTION OF WORK AND INTENDED USE:  
CAR PORT

SQ FT OF BLDG: 22' x 20'  
SQ FT OF LOT: \_\_\_\_\_  
NUMBER OF FAMILY UNITS: 1  
NUMBER OF BUILDINGS ON PARCEL BEFORE THIS PLANNED CONSTRUCTION  
1  
USE OF ALL EXISTING BUILDINGS:  
LIVING

\*\*\*\*\*  
FOR OFFICE USE ONLY  
\*\*\*\*\*

ZONE: RSFE  
SETBACKS: F 20 S 5 1/2 R 15  
RIGHT OF WAY: \_\_\_\_\_  
MAXIMUM HEIGHT: \_\_\_\_\_  
PARKING SPACES REQUIRED: \_\_\_\_\_  
LANDSCAPING/SCREENING: Open carport  
can go to 3' side yard.

FLOOD PLAIN: YES NO  
GEOLOGIC HAZARD: YES NO  
CENSUS TRACT NUMBER: 10  
SPECIAL CONDITIONS: 72-21

\*\*\*\*\*  
ANY MODIFICATION TO THIS APPROVED PLANNING CLEARANCE MUST BE APPROVED IN WRITING BY THIS DEPARTMENT.  
THE STRUCTURE APPROVED BY THIS APPLICATION CANNOT BE OCCUPIED UNTIL A CERTIFICATE OF OCCUPANCY (CO) IS ISSUED BY THE BUILDING DEPARTMENT (Section 307, Uniform Building Code).  
ANY LANDSCAPING REQUIRED BY THIS PERMIT SHALL BE MAINTAINED IN AN ACCEPTABLE AND HEALTHY CONDITION. THE REPLACEMENT OF ANY VEGETATION MATERIALS THAT DIE OR ARE IN AN UNHEALTHY CONDITION SHALL BE REQUIRED.

I HEREBY ACKNOWLEDGE THAT I HAVE READ THIS APPLICATION AND THE ABOVE IS CORRECT AND I AGREE TO COMPLY WITH THE REQUIREMENTS ABOVE. FAILURE TO COMPLY SHALL RESULT IN LEGAL ACTION.

DATE APPROVED: 10/15/84  
APPROVED BY: [Signature]

[Signature]  
SIGNATURE

CAR PORT AT  
3050 No. 13th St.

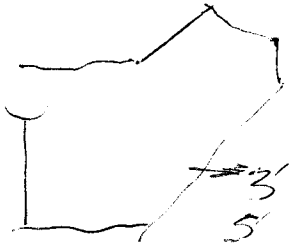

3' FROM PROPERTY LINE  
5' FROM PROPERTY LINE IF WALL IS USED

