

DATE SUBMITTED: JAN. 6, 1987

PERMIT # 26934
FEE \$500

PLANNING CLEARANCE

GRAND JUNCTION PLANNING DEPARTMENT

BLDG ADDRESS: 840 N. 11th St.

SQ. FT. OF BLDG: N/A

SUBDIVISION: City of Grand Junction

SQ. FT. OF LOT: N/A

FILING # _____ BLK # 23 LOT # 1-9

NUMBER OF FAMILY UNITS: N/A

TAX SCHEDULE NUMBER:
2945-141-18-951

NUMBER OF BUILDINGS ON PARCEL BEFORE THIS PLANNED CONSTRUCTION:
1

PROPERTY OWNER: Lutheran Church of Messiah

USE OF ALL EXISTING BUILDINGS:

ADDRESS: 840 N 11th St.

Church Exit

PHONE: 245-2838

DESCRIPTION OF WORK AND INTENDED USE:
Canopy over handiug and stairway

SUBMITTALS REQ'D: TWO (2) PLOT PLANS SHOWING PARKING, LANDSCAPING, SETBACKS TO ALL PROPERTY LINES, AND ALL STREETS WHICH ABUT THE PARCEL.

FOR OFFICE USE ONLY

ZONE: RMF-32

FLOODPLAIN: YES _____ NO

SETBACKS: F 45 S 10 R 20

GEOLOGIC HAZARD: YES _____ NO

MAXIMUM HEIGHT: 36

CENSUS TRACT #: 2

PARKING SPACES REQ'D: N/A

TRAFFIC ZONE: 36

LANDSCAPING/SCREENING: N/A

SPECIAL CONDITIONS: NONE

ANY MODIFICATION TO THIS APPROVED PLANNING CLEARANCE MUST BE APPROVED, IN WRITING, BY THE DEPARTMENT. THE STRUCTURE APPROVED BY THIS APPLICATION CANNOT BE OCCUPIED UNTIL A CERTIFICATE OF OCCUPANCY (C.O.) IS ISSUED BY THE BUILDING DEPARTMENT (SECTION 307, UNIFORM BUILDING CODE.)

ANY LANDSCAPING REQUIRED BY THIS PERMIT SHALL BE MAINTAINED IN AN ACCEPTABLE AN HEALTHY CONDITION. THE REPLACEMENT OF ANY VEGETATION MATERIALS THAT DIE OR ARE IN AN UNHEALTHY CONDITION SHALL BE REQUIRED.

HEREBY ACKNOWLEDGE THAT I HAVE READ THIS APPLICATION AND THE ABOVE IS CORRECT AND I AGREE TO COMPLY WITH THE REQUIREMENTS ABOVE. FAILURE TO COMPLY SHALL RESULT IN LEGAL ACTION.

DATE APPROVED: JAN 6, 1987

For Lutheran Church of Messiah
Harold Niquette
SIGNATURE

APPROVED BY: Kate Metzger

ELEVATION OF CANOPY OVER DOOR EAST OF GYM

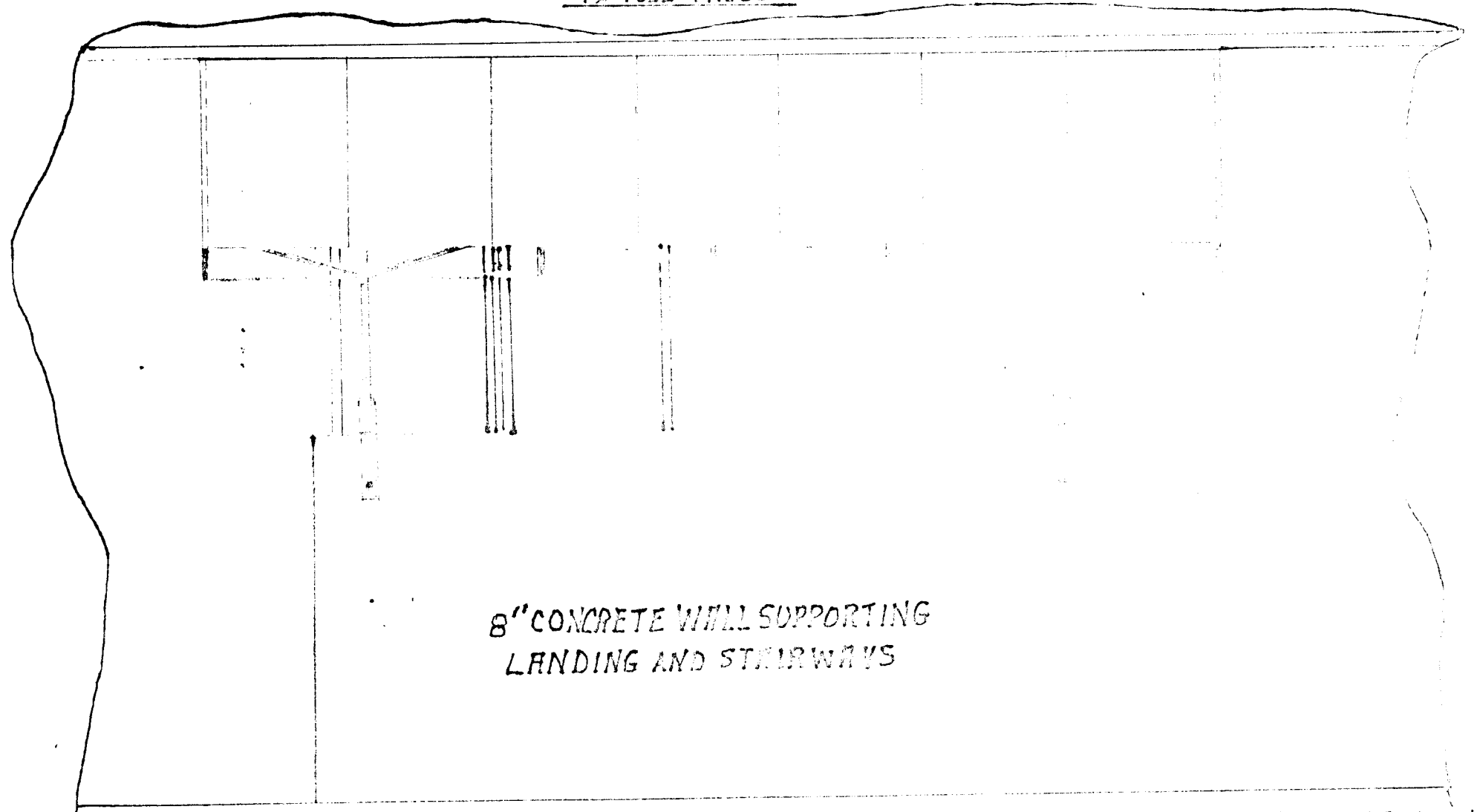
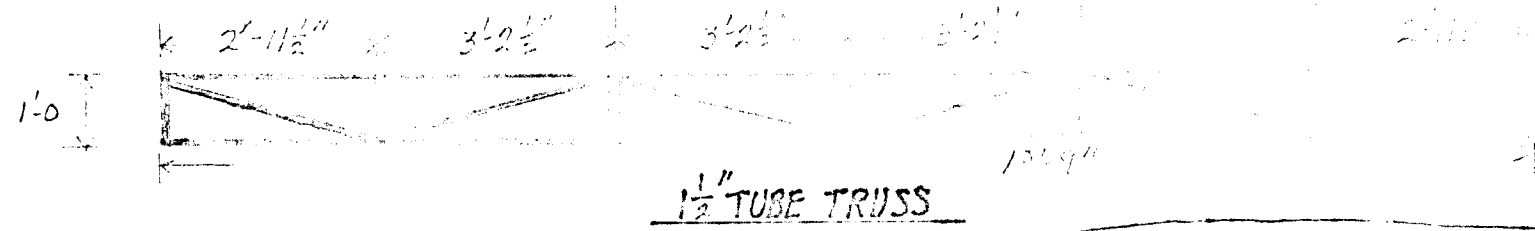

CANOPY OF V-LINE 32 METAL SHEETS SUPPORTED BY BENT PLATE AT BLDG. AND TUBE TRUSS ABOVE CONCRETE WALL

VIEW FROM EAST

LUTHERAN CHURCH OF MESSIAH
240 N. 11TH ST.
GRAND JUNCTION, COLO.
2945-141-10-951
1082

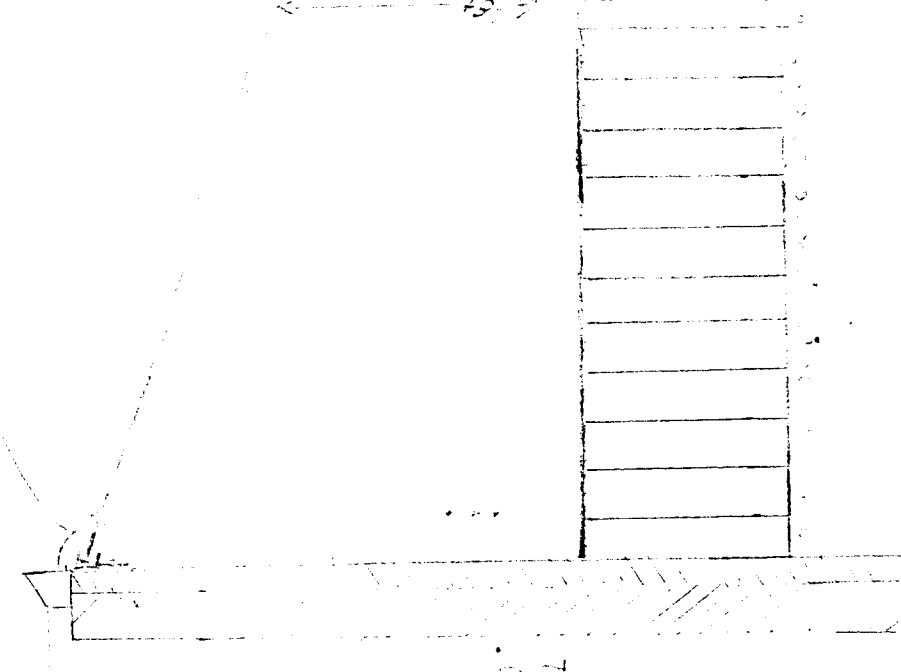
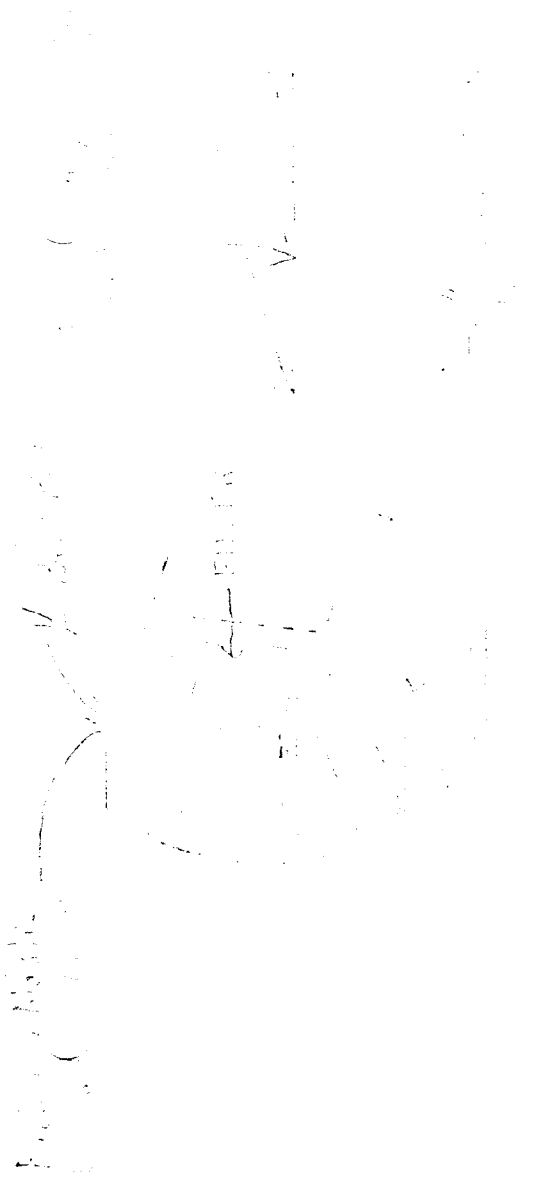

SOUTH ELEVATION

21' 0" HIGH
 11' 0" WIDE

14' 0" HIGH

2' 0" HIGH
 10' 0" WIDE

2' 0" HIGH
 10' 0" WIDE

LUTHERAN CHURCH OF MESSURIA
 870 N. 11TH ST.
 GRAND JUNCTION, COLO.
 2445-411-13-95