

DATE SUBMITTED:

5-24-88

PERMIT #

30458

FEE

\$ 5.00

PLANNING CLEARANCE

GRAND JUNCTION PLANNING DEPARTMENT

BLDG ADDRESS: 1769 N 26th

SQ. FT. OF BLDG: 26' x 40'

SUBDIVISION: Melrose

SQ. FT. OF LOT: 50' x 120 (approx)

FILING # _____ BLK # _____ LOT # _____

NUMBER OF FAMILY UNITS: 1

TAX SCHEDULE NUMBER:

NUMBER OF BUILDINGS ON PARCEL BEFORE THIS PLANNED CONSTRUCTION:

2945-124-07-034

1

PROPERTY OWNER: George May

USE OF ALL EXISTING BUILDINGS:

ADDRESS: 1769 N 26th St

residential

PHONE: 241-4126

SUBMITTALS REQ'D: TWO (2) PLOT PLANS SHOWING PARKING, LANDSCAPING, SETBACKS TO ALL PROPERTY LINES, AND ALL STREETS WHICH ABUT THE PARCEL.

DESCRIPTION OF WORK AND INTENDED USE:

Addition - bedroom + storage.

FOR OFFICE USE ONLY

ZONE: RSF-8

FLOODPLAIN: YES _____ NO

SETBACKS: F 45 S 5 R 15

GEOLOGIC HAZARD: YES _____ NO

MAXIMUM HEIGHT: 15

CENSUS TRACT #: 6

PARKING SPACES REQ'D: n/a

TRAFFIC ZONE: 37

LANDSCAPING/SCREENING: exists

SPECIAL CONDITIONS: _____

ANY MODIFICATION TO THIS APPROVED PLANNING CLEARANCE MUST BE APPROVED, IN WRITING, BY THE DEPARTMENT. THE STRUCTURE APPROVED BY THIS APPLICATION CANNOT BE OCCUPIED UNTIL A CERTIFICATE OF OCCUPANCY (C.O.) IS ISSUED BY THE BUILDING DEPARTMENT (SECTION 307, UNIFORM BUILDING CODE.)

ANY LANDSCAPING REQUIRED BY THIS PERMIT SHALL BE MAINTAINED IN AN ACCEPTABLE AN HEALTHY CONDITION. THE REPLACEMENT OF ANY VEGETATION MATERIALS THAT DIE OR ARE IN AN UNHEALTHY CONDITION SHALL BE REQUIRED.

I HEREBY ACKNOWLEDGE THAT I HAVE READ THIS APPLICATION AND THE ABOVE IS CORRECT AND I AGREE TO COMPLY WITH THE REQUIREMENTS ABOVE. FAILURE TO COMPLY SHALL RESULT IN LEGAL ACTION.

DATE APPROVED: 5-24-88

APPROVED BY: W. [Signature]

George L. May
SIGNATURE

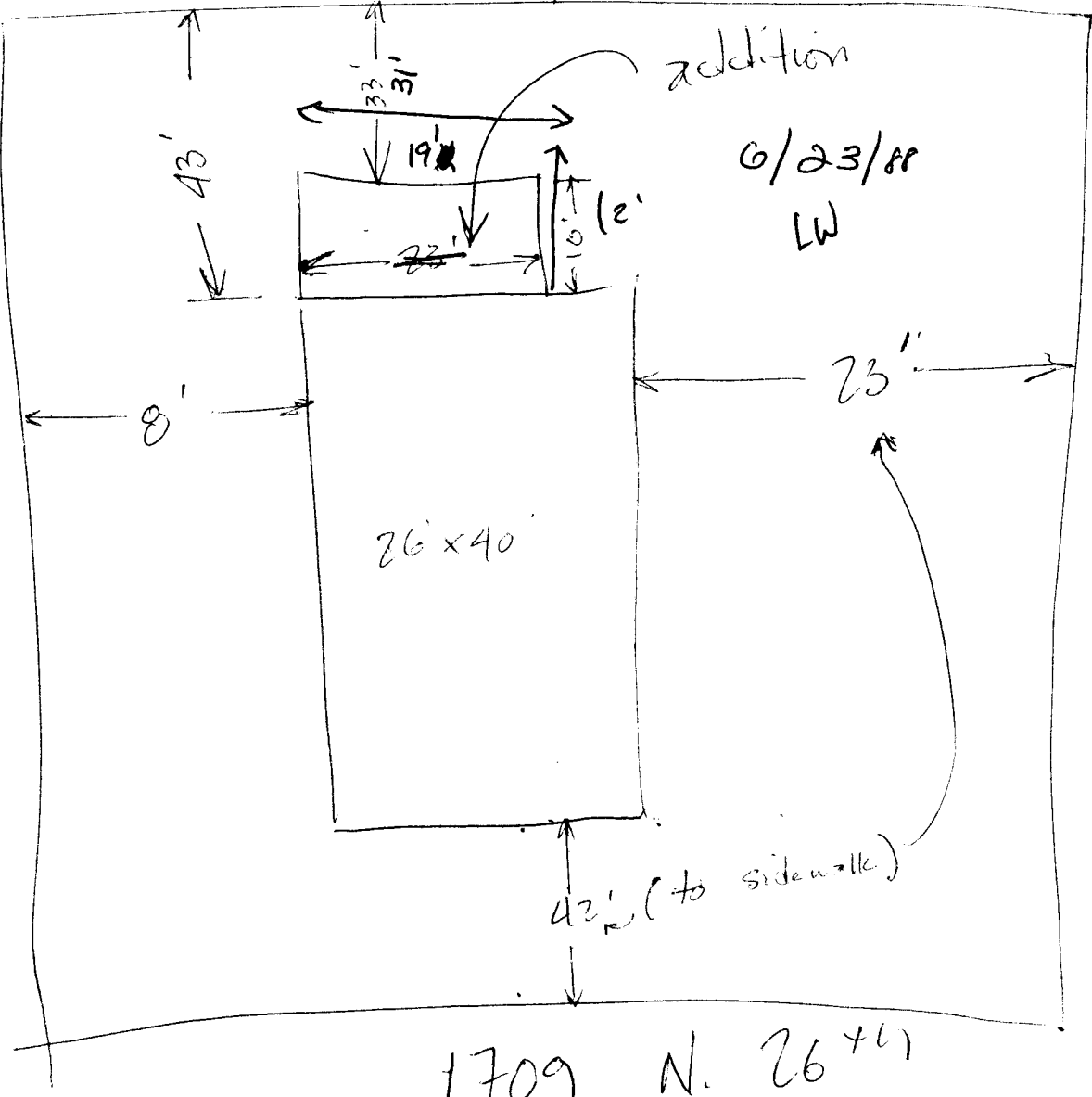

No. 26th ST