

DATE SUBMITTED: 9/7/88

PERMIT # 31226

FEE 5.00

# PLANNING CLEARANCE

GRAND JUNCTION PLANNING DEPARTMENT

BLDG ADDRESS: 2939 Crocus Ct

SQ. FT. OF BLDG: 12 x 18

SUBDIVISION: Spring Vally

SQ. FT. OF LOT: \_\_\_\_\_

FILING # 5 BLK # 4 LOT # 19

NUMBER OF FAMILY UNITS: 1

TAX SCHEDULE NUMBER:  
2945-01411-0283

NUMBER OF BUILDINGS ON PARCEL BEFORE THIS PLANNED CONSTRUCTION:  
1

PROPERTY OWNER: John Aden

USE OF ALL EXISTING BUILDINGS:  
home

ADDRESS: 2939 Crocus

PHONE: 245-6417

DESCRIPTION OF WORK AND INTENDED USE:  
stud-

SUBMITTALS REQ'D: TWO (2) PLOT PLANS SHOWING PARKING, LANDSCAPING, SETBACKS TO ALL PROPERTY LINES, AND ALL STREETS WHICH ABUT THE PARCEL.

\*\*\*\*\*

### FOR OFFICE USE ONLY

ZONE: RSF-5

FLOODPLAIN: YES \_\_\_\_\_ NO X

SETBACKS: F \_\_\_\_\_ S 3 R 10

GEOLOGIC HAZARD: YES \_\_\_\_\_ NO \_\_\_\_\_

MAXIMUM HEIGHT: 32

CENSUS TRACT #: 10

PARKING SPACES REQ'D: \_\_\_\_\_

TRAFFIC ZONE: 21

LANDSCAPING/SCREENING: \_\_\_\_\_

SPECIAL CONDITIONS: may not be built in an easement -- must be approved by Spring Valley Home Owners Association

\*\*\*\*\*

ANY MODIFICATION TO THIS APPROVED PLANNING CLEARANCE MUST BE APPROVED, IN WRITING, BY THE DEPARTMENT. THE STRUCTURE APPROVED BY THIS APPLICATION CANNOT BE OCCUPIED UNTIL A CERTIFICATE OF OCCUPANCY (C.O.) IS ISSUED BY THE BUILDING DEPARTMENT (SECTION 307, UNIFORM BUILDING CODE.)

ANY LANDSCAPING REQUIRED BY THIS PERMIT SHALL BE MAINTAINED IN AN ACCEPTABLE AN HEALTHY CONDITION. THE REPLACEMENT OF ANY VEGETATION MATERIALS THAT DIE OR ARE IN AN UNHEALTHY CONDITION SHALL BE REQUIRED.

I HEREBY ACKNOWLEDGE THAT I HAVE READ THIS APPLICATION AND THE ABOVE IS CORRECT AND I AGREE TO COMPLY WITH THE REQUIREMENTS ABOVE. FAILURE TO COMPLY SHALL RESULT IN LEGAL ACTION.

DATE APPROVED: 9/7/88

APPROVED BY: Kathy Portner

Wendy Evans  
SIGNATURE

Appurtenant

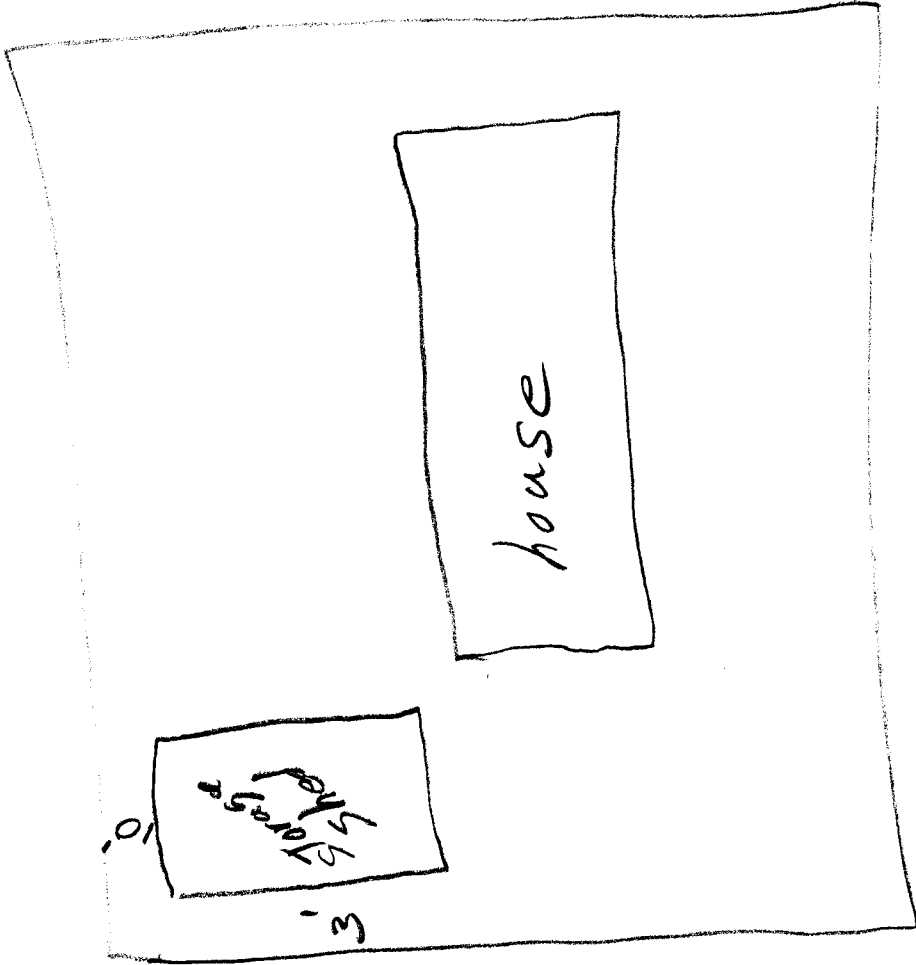

CROCUS