

DATE SUBMITTED: 7/1/88

PERMIT # 30625

FEE ~~#500~~ no fee

# PLANNING CLEARANCE

GRAND JUNCTION PLANNING DEPARTMENT

BLDG ADDRESS: 840 Hall

SQ. FT. OF BLDG: 926 S.F.

SUBDIVISION: MESA Sub

SQ. FT. OF LOT: 7500 S.F.

FILING # \_\_\_\_\_ BLK # 2 LOT # 18

NUMBER OF FAMILY UNITS: 1

TAX SCHEDULE NUMBER:  
2945-114-08-018

NUMBER OF BUILDINGS ON PARCEL BEFORE THIS PLANNED CONSTRUCTION:  
2 (including garage)

PROPERTY OWNER: Robert Gregg

USE OF ALL EXISTING BUILDINGS:  
residential

ADDRESS: 840 Hall Ave Grand Junction

PHONE: 242-8621 - Ext 592 work

DESCRIPTION OF WORK AND INTENDED USE:  
Finish already begun addition  
Bedroom - Bath interior remodel

SUBMITTALS REQ'D: TWO (2) PLOT PLANS SHOWING PARKING, LANDSCAPING, SETBACKS TO ALL PROPERTY LINES, AND ALL STREETS WHICH ABUT THE PARCEL.

\*\*\*\*\*

### FOR OFFICE USE ONLY

ZONE: RSF-8

FLOODPLAIN: YES \_\_\_\_\_ NO X

SETBACKS: F 20 ft S 5 ft R 25 ft

GEOLOGIC HAZARD: YES \_\_\_\_\_ NO X

MAXIMUM HEIGHT: 32

CENSUS TRACT #: 4

PARKING SPACES REQ'D: \_\_\_\_\_

TRAFFIC ZONE: 34

LANDSCAPING/SCREENING: \_\_\_\_\_

SPECIAL CONDITIONS: \_\_\_\_\_

\*\*\*\*\*

ANY MODIFICATION TO THIS APPROVED PLANNING CLEARANCE MUST BE APPROVED, IN WRITING, BY THE DEPARTMENT. THE STRUCTURE APPROVED BY THIS APPLICATION CANNOT BE OCCUPIED UNTIL A CERTIFICATE OF OCCUPANCY (C.O.) IS ISSUED BY THE BUILDING DEPARTMENT (SECTION 307, UNIFORM BUILDING CODE.)

ANY LANDSCAPING REQUIRED BY THIS PERMIT SHALL BE MAINTAINED IN AN ACCEPTABLE AND HEALTHY CONDITION. THE REPLACEMENT OF ANY VEGETATION MATERIALS THAT DIE OR ARE IN AN UNHEALTHY CONDITION SHALL BE REQUIRED.

I HEREBY ACKNOWLEDGE THAT I HAVE READ THIS APPLICATION AND THE ABOVE IS CORRECT AND I AGREE TO COMPLY WITH THE REQUIREMENTS ABOVE. FAILURE TO COMPLY SHALL RESULT IN LEGAL ACTION.

DATE APPROVED: 7/1/88

APPROVED BY: [Signature]

[Signature]  
SIGNATURE

840 Hall Avenue

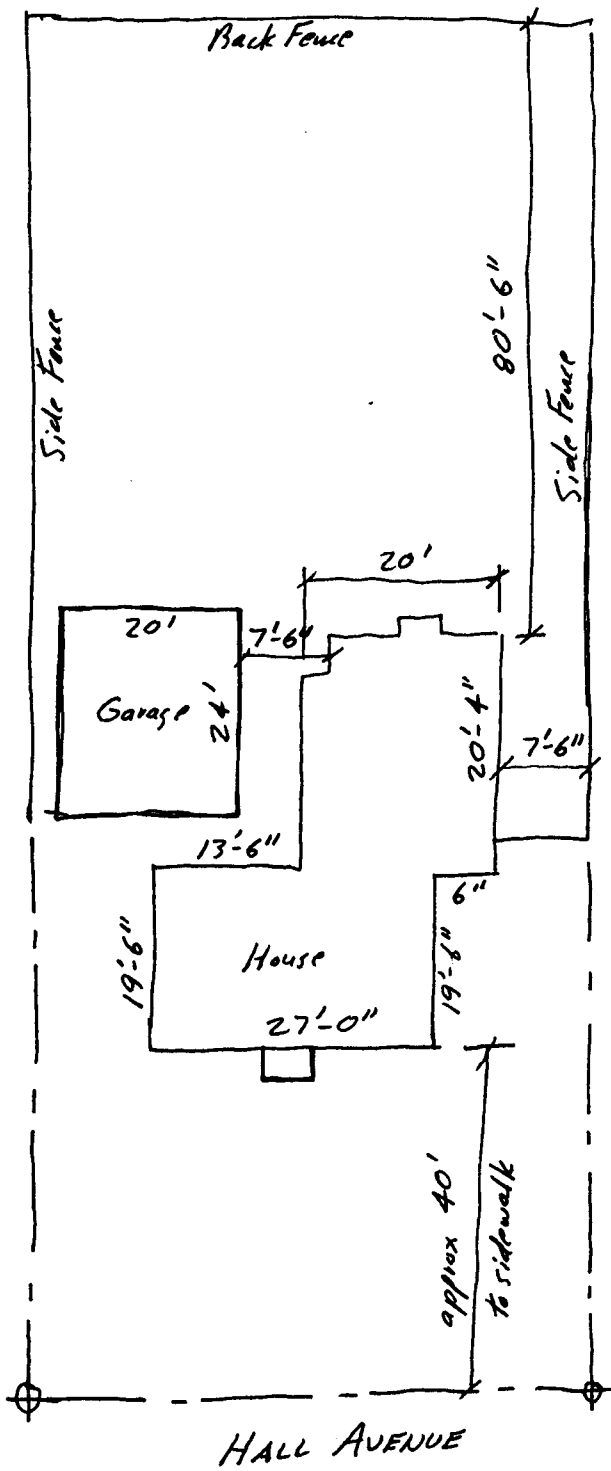

*Robert King*