

DATE SUBMITTED: 4-18-88

PERMIT # 30087

FEE \$5<sup>00</sup>

# PLANNING CLEARANCE

GRAND JUNCTION PLANNING DEPARTMENT

BLDG ADDRESS: 200 KENNEDY

SQ. FT. OF BLDG: 480

SUBDIVISION: Sherwood Park

SQ. FT. OF LOT: \_\_\_\_\_

FILING # \_\_\_\_\_ BLK # \_\_\_\_\_ LOT # \_\_\_\_\_

NUMBER OF FAMILY UNITS: \_\_\_\_\_

TAX SCHEDULE NUMBER:  
2945-113-05-009

NUMBER OF BUILDINGS ON PARCEL BEFORE THIS PLANNED CONSTRUCTION:  
1

PROPERTY OWNER: WOODWARD

USE OF ALL EXISTING BUILDINGS:  
Home

ADDRESS: 200 KENNEDY

PHONE: \_\_\_\_\_

SUBMITTALS REQ'D: TWO (2) PLOT PLANS SHOWING PARKING, LANDSCAPING, SETBACKS TO ALL PROPERTY LINES, AND ALL STREETS WHICH ABUT THE PARCEL.

DESCRIPTION OF WORK AND INTENDED USE:

16'x30' GARAGE FOR MOTOR HOME  
Enclose existing GARAGE TO MAKE family room

\*\*\*\*\*  
**FOR OFFICE USE ONLY**  
\*\*\*\*\*

ZONE: RSF-5

FLOODPLAIN: YES \_\_\_\_\_ NO X

SETBACKS: F 20 S 5 R 25

GEOLOGIC HAZARD: YES \_\_\_\_\_ NO X

MAXIMUM HEIGHT: 32

CENSUS TRACT #: 4

PARKING SPACES REQ'D: \_\_\_\_\_

TRAFFIC ZONE: 34

LANDSCAPING/SCREENING: \_\_\_\_\_

SPECIAL CONDITIONS: \_\_\_\_\_

\*\*\*\*\*  
ANY MODIFICATION TO THIS APPROVED PLANNING CLEARANCE MUST BE APPROVED, IN WRITING, BY THE DEPARTMENT. THE STRUCTURE APPROVED BY THIS APPLICATION CANNOT BE OCCUPIED UNTIL A CERTIFICATE OF OCCUPANCY (C.O.) IS ISSUED BY THE BUILDING DEPARTMENT (SECTION 307, UNIFORM BUILDING CODE.)

ANY LANDSCAPING REQUIRED BY THIS PERMIT SHALL BE MAINTAINED IN AN ACCEPTABLE AN HEALTHY CONDITION. THE REPLACEMENT OF ANY VEGETATION MATERIALS THAT DIE OR ARE IN AN UNHEALTHY CONDITION SHALL BE REQUIRED.

I HEREBY ACKNOWLEDGE THAT I HAVE READ THIS APPLICATION AND THE ABOVE IS CORRECT AND I AGREE TO COMPLY WITH THE REQUIREMENTS ABOVE. FAILURE TO COMPLY SHALL RESULT IN LEGAL ACTION.

DATE APPROVED: 4/18/88

APPROVED BY: [Signature]

[Signature]  
SIGNATURE

200 KENNEDY AVE  
WOODWARD GARAGE

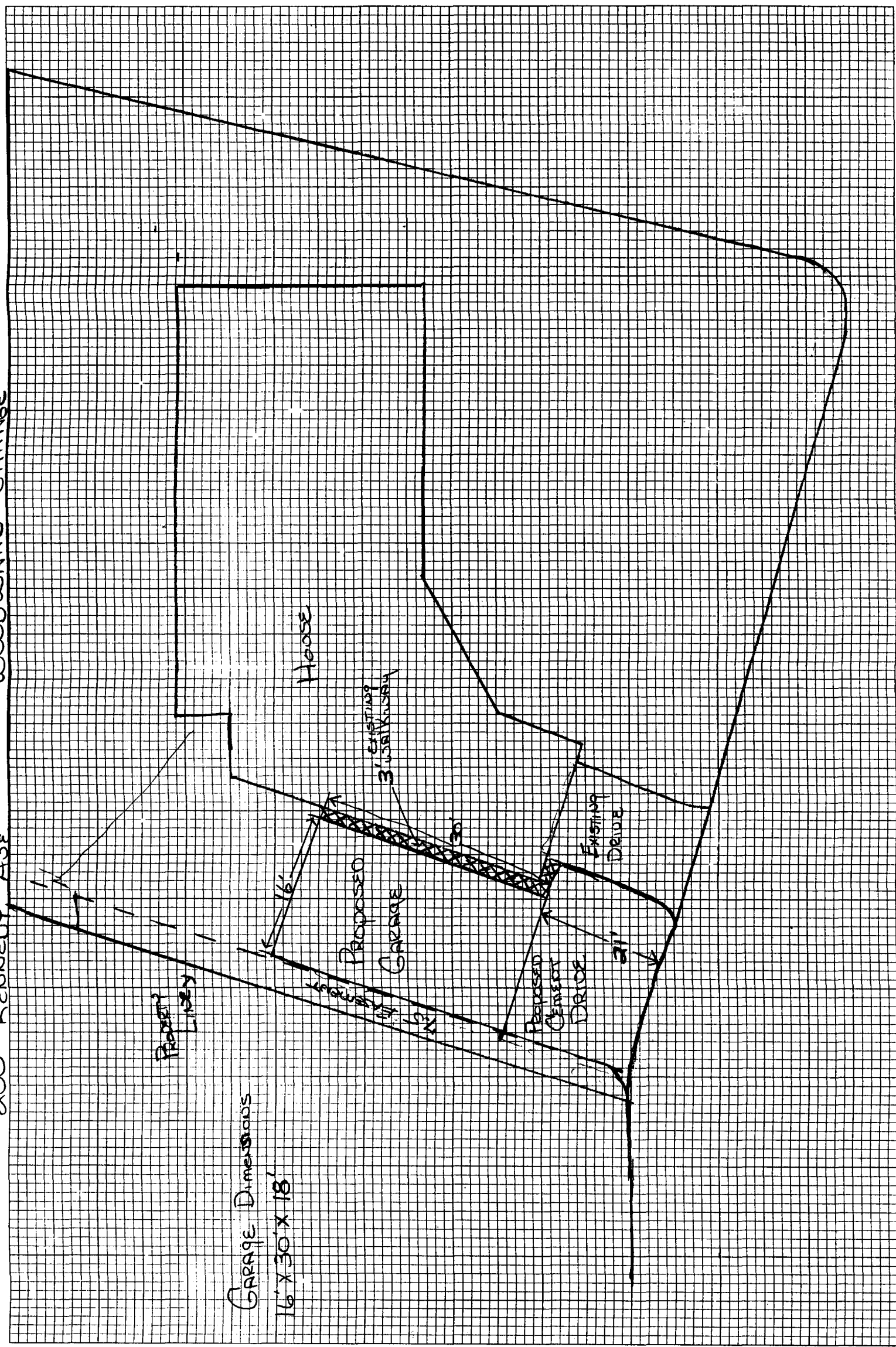

GARAGE DIMENSIONS  
16' X 30' X 18'

HOOSE

PROPOSED GARAGE

3' EXISTING CURB

EXISTING DRIVEWAY

PROPOSED CEMENT DRIVEWAY

PROPERTY LINE

16'