

DATE SUBMITTED: 5/3/88

PERMIT # 30318

FEE \$5⁰⁰

PLANNING CLEARANCE

GRAND JUNCTION PLANNING DEPARTMENT

BLDG ADDRESS: 1310 UTE

SQ. FT. OF BLDG: ~~4110~~ ^{add. 300} 3840

SUBDIVISION: ~~2945-133-18-010~~ ^{Ruth P. Adams}

SQ. FT. OF LOT: 12500

FILING # _____ BLK # N LOT # 3042

NUMBER OF FAMILY UNITS: 0

TAX SCHEDULE NUMBER:
2945-133-18-010

NUMBER OF BUILDINGS ON PARCEL BEFORE THIS PLANNED CONSTRUCTION:
1

PROPERTY OWNER: Leroy & Patty Arguala

USE OF ALL EXISTING BUILDINGS:
restaurant

ADDRESS: 1310 Ute

PHONE: _____

SUBMITTALS REQ'D: TWO (2) PLOT PLANS SHOWING PARKING, LANDSCAPING, SETBACKS TO ALL PROPERTY LINES, AND ALL STREETS WHICH ABUT THE PARCEL.

DESCRIPTION OF WORK AND INTENDED USE:
addition to rear of bldg - stage

FOR OFFICE USE ONLY

ZONE: C-2

FLOODPLAIN: YES _____ NO X

SETBACKS: F N/A S 0 R 0

GEOLOGIC HAZARD: YES _____ NO X

MAXIMUM HEIGHT: 40

CENSUS TRACT #: 8

PARKING SPACES REQ'D: _____

TRAFFIC ZONE: 41

LANDSCAPING/SCREENING: _____

SPECIAL CONDITIONS: _____

ANY MODIFICATION TO THIS APPROVED PLANNING CLEARANCE MUST BE APPROVED, IN WRITING, BY THE DEPARTMENT. THE STRUCTURE APPROVED BY THIS APPLICATION CANNOT BE OCCUPIED UNTIL A CERTIFICATE OF OCCUPANCY (C.O.) IS ISSUED BY THE BUILDING DEPARTMENT (SECTION 307, UNIFORM BUILDING CODE.)

ANY LANDSCAPING REQUIRED BY THIS PERMIT SHALL BE MAINTAINED IN AN ACCEPTABLE AN HEALTHY CONDITION. THE REPLACEMENT OF ANY VEGETATION MATERIALS THAT DIE OR ARE IN AN UNHEALTHY CONDITION SHALL BE REQUIRED.

I HEREBY ACKNOWLEDGE THAT I HAVE READ THIS APPLICATION AND THE ABOVE IS CORRECT AND I AGREE TO COMPLY WITH THE REQUIREMENTS ABOVE. FAILURE TO COMPLY SHALL RESULT IN LEGAL ACTION.

DATE APPROVED: 5/3/88

APPROVED BY: [Signature]

DATURA CORP
[Signature]
SIGNATURE

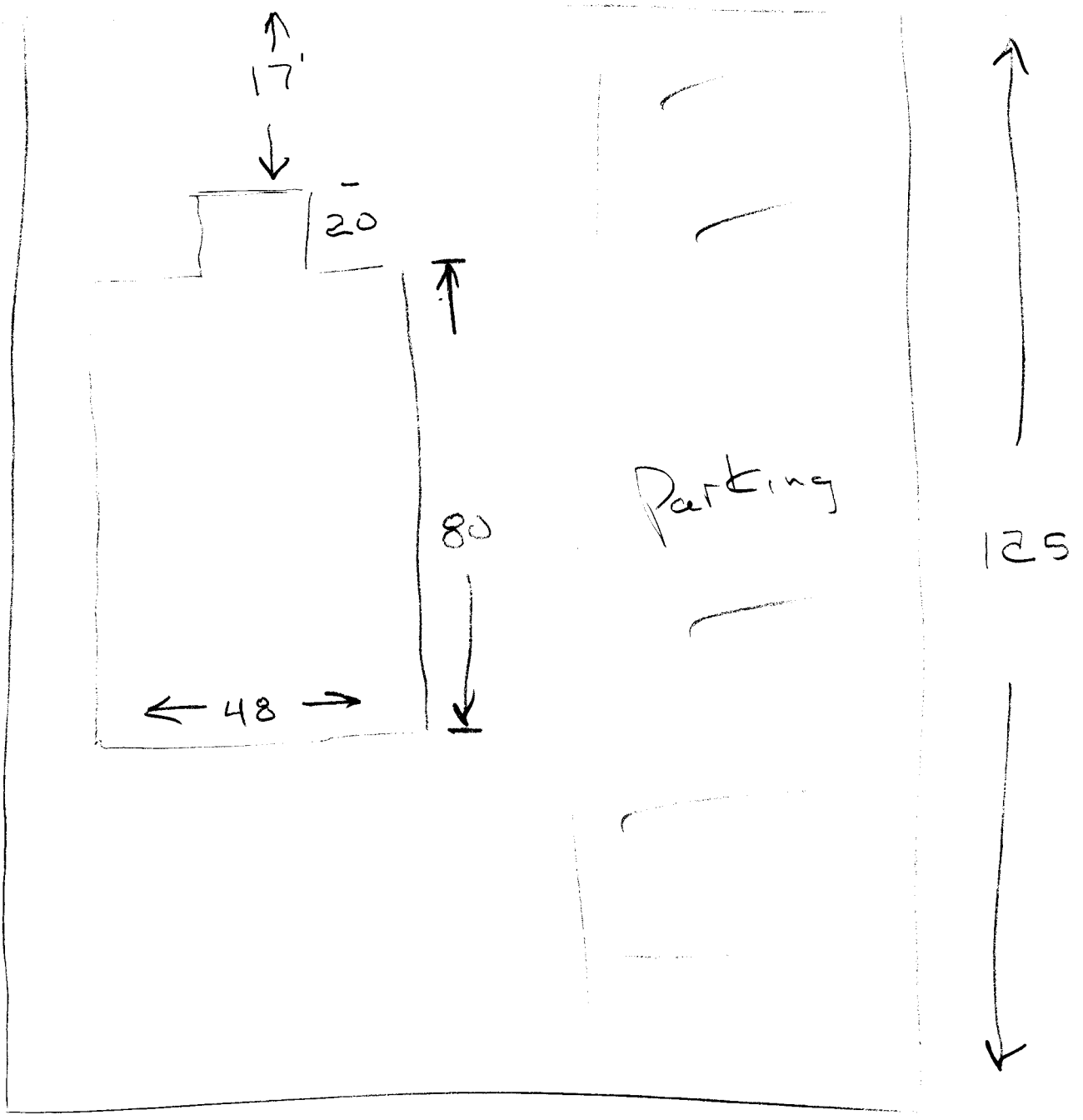

← 100' →

N T S