

DATE SUBMITTED: 6-5-89

PERMIT # 33113

FEE \$50

PLANNING CLEARANCE

GRAND JUNCTION PLANNING DEPARTMENT

BLDG ADDRESS: 651 Hwy 50

SQ. FT. OF BLDG: 32' 5th wheel

SUBDIVISION: Twin's End

SQ. FT. OF LOT: _____

FILING # _____ BLK # _____ LOT # 4

NUMBER OF FAMILY UNITS: _____

TAX SCHEDULE NUMBER:
2945-262-10-001

NUMBER OF BUILDINGS ON PARCEL
BEFORE THIS PLANNED CONSTRUCTION:

PROPERTY OWNER: OLIVER HAYASHI

USE OF ALL EXISTING BUILDINGS:

ADDRESS: 2679 B 1/2 Rd

PHONE: 242-8585

DESCRIPTION OF WORK AND INTENDED USE:
Setup RV space - convert MH space
to RV space

SUBMITTALS REQ'D: TWO (2) PLOT
PLANS SHOWING PARKING, LAND-
SCAPING, SETBACKS TO ALL PROPERTY
LINES, AND ALL STREETS WHICH ABUT
THE PARCEL.

FOR OFFICE USE ONLY

ONE: PMH

FLOODPLAIN: YES _____ NO

SETBACKS: F _____ S As per PMH R PMH

GEOLOGIC HAZARD: YES _____ NO _____

MAXIMUM HEIGHT: _____

CENSUS TRACT #: 13

PARKING SPACES REQ'D: _____

TRAFFIC ZONE: 81

LANDSCAPING/SCREENING: _____

SPECIAL CONDITIONS: Converted MH
space to RV space

ANY MODIFICATION TO THIS APPROVED PLANNING CLEARANCE MUST BE APPROVED, IN WRITING, BY THE DEPARTMENT. THE STRUCTURE APPROVED BY THIS APPLICATION CANNOT BE OCCUPIED UNTIL A CERTIFICATE OF OCCUPANCY (C.O.) IS ISSUED BY THE BUILDING DEPARTMENT (SECTION 307, UNIFORM BUILDING CODE.)

ANY LANDSCAPING REQUIRED BY THIS PERMIT SHALL BE MAINTAINED IN AN ACCEPTABLE AND HEALTHY CONDITION. THE REPLACEMENT OF ANY VEGETATION MATERIALS THAT DIE OR ARE IN AN UNHEALTHY CONDITION SHALL BE REQUIRED.

I HEREBY ACKNOWLEDGE THAT I HAVE READ THIS APPLICATION AND THE ABOVE IS CORRECT AND I AGREE TO COMPLY WITH THE REQUIREMENTS ABOVE. FAILURE TO COMPLY SHALL RESULT IN LEGAL ACTION.

DATE APPROVED: 6-5-89

APPROVED BY: Janice Wietzel

Oliver Hayashi
SIGNATURE

Trails End
651 Hwy 50

ACCEPTED
M 6/18/89
ANY CHANGES TO SETBACKS MUST BE
APPROVED BY THE CITY PLANNING
DEPARTMENT BEFORE ANY
REVISIONS TO THE EASEMENTS
AND PROPERTY LINES
LOCATED ON THESE PLANS

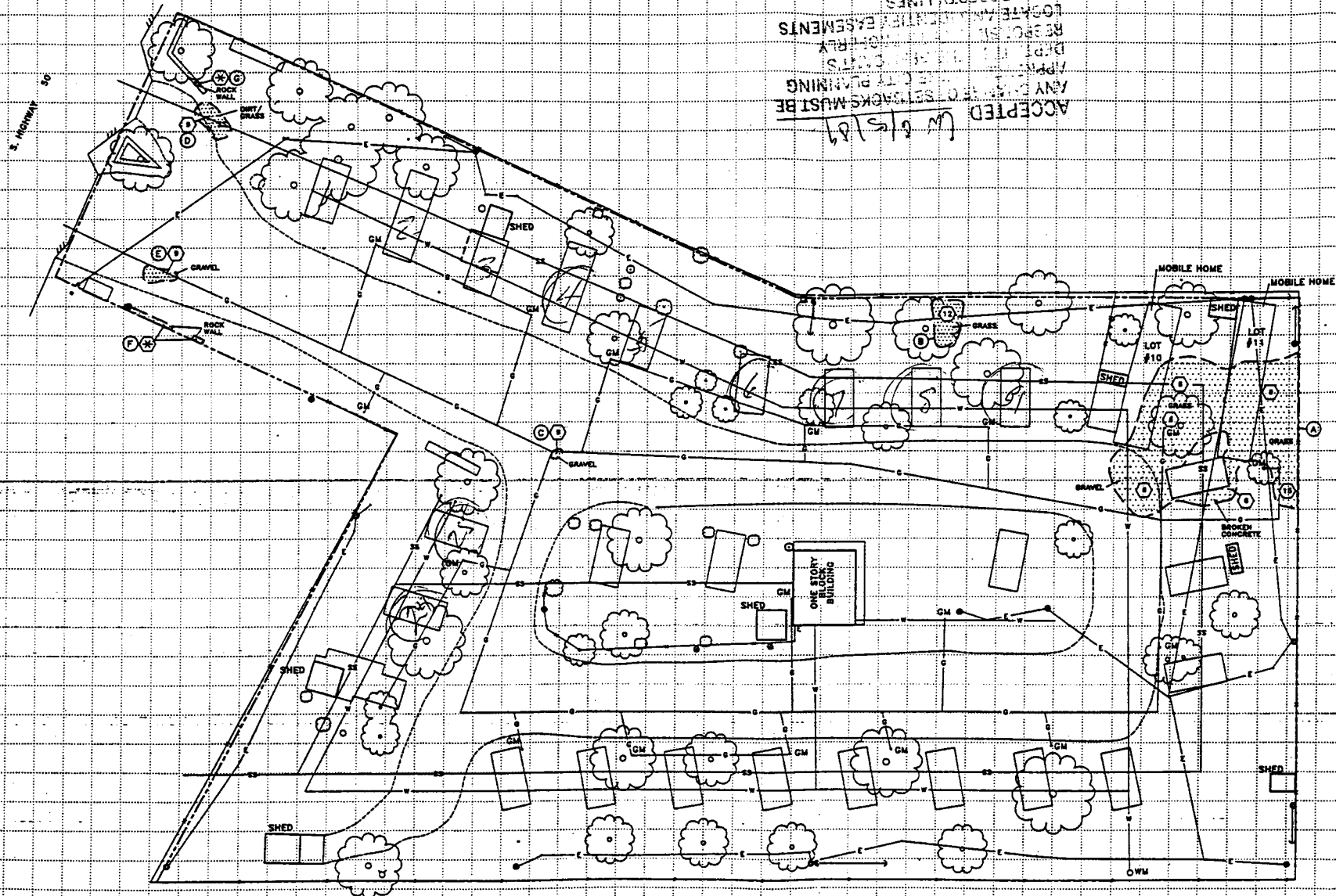

- LEGEND**
- BOUNDARY OF CONTAMINATION
 - DESIGNATION OF RESIDUAL RADIOACTIVE DEPOSIT
 - DEPTH OF CONTAMINATION (INCHES)
 - ▨ CONTAMINATED AREA
 - ⊕ SEE TEAM LEADER NOTES

FIGURE 1
EXTERIOR ESTIMATED EXTENT OF CONTAMINATION

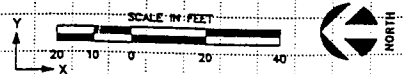

This drawing, prepared for the Uranium Mill Tailings Remedial Action Project, is for the sole use of the U.S. Department of Energy and its contractors. It is not to be used for any other purpose, nor is it to be used as a basis for any other survey, map, or other future improvement plan.

| | | | | | | | | | | | | | |
|---|------|-----------|----|----------|------|------|-----|------------|-----------|------|------|---------------------|------|
| NO. | DATE | REVISIONS | BY | CHK. | A.E. | APP. | NO. | DATE | REVISIONS | BY | CHK. | A.E. | APP. |
| RESIDENCES - NO. OF OCCUPANTS | | | | | | | | | | | | | |
| RESIDENCES - MAX. AGE/NO. | | | | | | | | | | | | | |
| U.S. DEPARTMENT OF ENERGY GRAND JUNCTION PROJECTS OFFICE, COLORADO | | | | | | | | | | | | | |
| DESIGNED BY | | DATE | | DRAWN BY | | DATE | | CHECKED BY | | DATE | | APPROVAL | |
| Prepared by | | 4/89 | | R.K.R. | | 4/89 | | L.H.P. | | 4/89 | | 4/89 | |
| K.A. 4189 | | | | | | | | | | | | | |
| SURVEY DATE | | TIME | | APPROVAL | | DATE | | APPROVAL | | DATE | | DATE | |
| | | | | | | | | | | | | U.S. G. NO. CJ-0853 | |

851 SOUTH HWY 50
GRAND JUNCTION, COLORADO