

DATE SUBMITTED: 8/29/89

PERMIT # 33817

FEE 5.00

PLANNING CLEARANCE

GRAND JUNCTION PLANNING DEPARTMENT

BLDG ADDRESS: 1546 ORCHARD AVE

SQ. FT. OF BLDG: 864

SUBDIVISION: WEAVER

SQ. FT. OF LOT: _____

FILING # 122 BLK # 06 LOT # 016

NUMBER OF FAMILY UNITS: 1

TAX SCHEDULE NUMBER:
2945-122-06-016

NUMBER OF BUILDINGS ON PARCEL
BEFORE THIS PLANNED CONSTRUCTION:
2

PROPERTY OWNER: MIKE + MARILYN KELLEY

USE OF ALL EXISTING BUILDINGS:
House + Shop

ADDRESS: 1546 ORCHARD AVE.

PHONE: 241-0488

DESCRIPTION OF WORK AND INTENDED USE:
Building A. 920 sq ft - Could be attached in future

SUBMITTALS REQ'D: TWO (2) PLOT
PLANS SHOWING PARKING, LAND-
SCAPING, SETBACKS TO ALL PROPERTY
LINES, AND ALL STREETS WHICH ABUT
THE PARCEL.

FOR OFFICE USE ONLY

NE: R5F-8

FLOODPLAIN: YES _____ NO X

SETBACKS: F 20 S 5 R 15

GEOLOGIC HAZARD: YES _____ NO _____

MAXIMUM HEIGHT: 32

CENSUS TRACT #: 6

PARKING SPACES REQ'D: _____

TRAFFIC ZONE: 31

LANDSCAPING/SCREENING: _____

SPECIAL CONDITIONS: Meets setbacks for a principal structure - will be attached in the future

ANY MODIFICATION TO THIS APPROVED PLANNING CLEARANCE MUST BE APPROVED, IN WRITING, BY THE DEPARTMENT. THE STRUCTURE APPROVED BY THIS APPLICATION CANNOT BE OCCUPIED UNTIL A CERTIFICATE OF OCCUPANCY (C.O.) IS ISSUED BY THE BUILDING DEPARTMENT (SECTION 307, UNIFORM BUILDING CODE.)

ANY LANDSCAPING REQUIRED BY THIS PERMIT SHALL BE MAINTAINED IN AN ACCEPTABLE AN HEALTHY CONDITION. THE REPLACEMENT OF ANY VEGETATION MATERIALS THAT DIE OR ARE IN AN UNHEALTHY CONDITION SHALL BE REQUIRED.

I HEREBY ACKNOWLEDGE THAT I HAVE READ THIS APPLICATION AND THE ABOVE IS CORRECT AND I AGREE TO COMPLY WITH THE REQUIREMENTS ABOVE. FAILURE TO COMPLY SHALL RESULT IN LEGAL ACTION.

DATE APPROVED: 8/29/89

APPROVED BY: Kathy Parker

Mike E Kelley
SIGNATURE

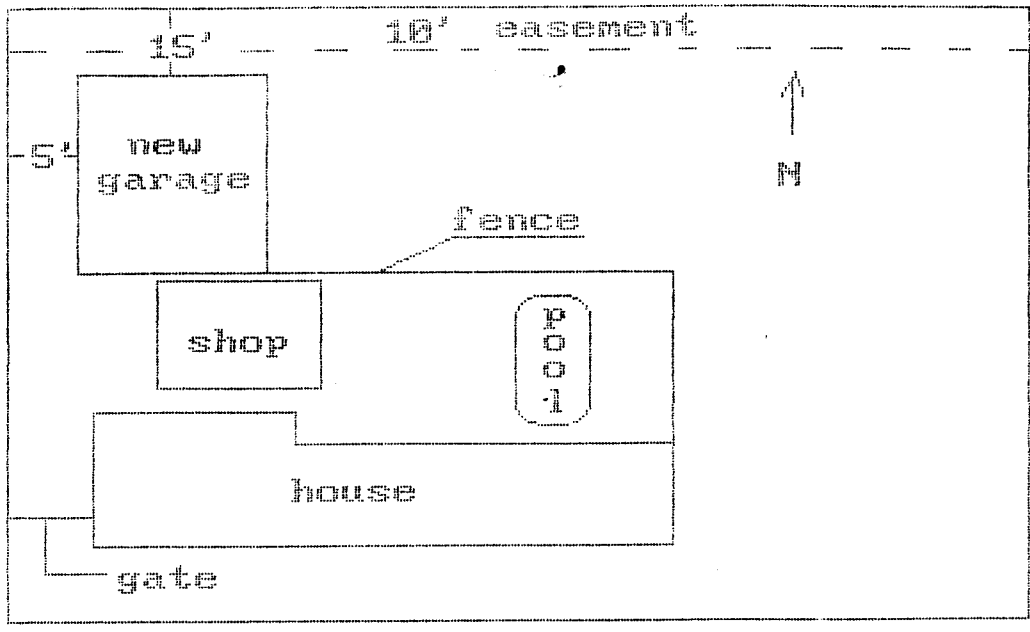

1546 Orchard Ave. (plot plan)

ACCEPTED *KP 8/29/89*
ANY CHANGE OF SETBACKS MUST BE APPROVED BY THE CITY PLANNING DEPT. IT IS THE APPLICANT'S RESPONSIBILITY TO PROPERLY LOCATE AND IDENTIFY EASEMENTS AND PROPERTY LINES.