

DATE SUBMITTED: 8/6/90

191111
PERMIT # 40602
FEE \$500

PLANNING CLEARANCE

GRAND JUNCTION PLANNING DEPARTMENT

BLDG ADDRESS: 627 W. Colorado Ave

SQ. FT. OF BLDG: 200^{sq}

SUBDIVISION: Richard D. Mobley's

SQ. FT. OF LOT: _____

FILING # _____ BLK # 10 LOT # 9

NUMBER OF FAMILY UNITS: 1

TAX SCHEDULE NUMBER:
2945-154-21-007

NUMBER OF BUILDINGS ON PARCEL BEFORE THIS PLANNED CONSTRUCTION:
1

PROPERTY OWNER: Antonio Pesina

USE OF ALL EXISTING BUILDINGS:

ADDRESS: 426 Noland Ave

Residential

PHONE: 241-1957

DESCRIPTION OF WORK AND INTENDED USE:
Extend Bathroom, New Street Rock Walls
NEW Floor Base

SUBMITTALS REQ'D: TWO (2) PLOT PLANS SHOWING PARKING, LANDSCAPING, SETBACKS TO ALL PROPERTY LINES, AND ALL STREETS WHICH ABUT THE PARCEL.

TO Live in

FOR OFFICE USE ONLY

ZONE: RSF-8

FLOODPLAIN: YES _____ NO

SETBACKS: F 20 S 5' R 15'

GEOLOGIC HAZARD: YES _____ NO

MAXIMUM HEIGHT: 32'

CENSUS TRACT #: 9

PARKING SPACES REQ'D: N/A

TRAFFIC ZONE: 43

LANDSCAPING/SCREENING: N/A

SPECIAL CONDITIONS: _____

ANY MODIFICATION TO THIS APPROVED PLANNING CLEARANCE MUST BE APPROVED, IN WRITING, BY THE DEPARTMENT. THE STRUCTURE APPROVED BY THIS APPLICATION CANNOT BE OCCUPIED UNTIL A CERTIFICATE OF OCCUPANCY (C.O.) IS ISSUED BY THE BUILDING DEPARTMENT (SECTION 307, UNIFORM BUILDING CODE.)

ANY LANDSCAPING REQUIRED BY THIS PERMIT SHALL BE MAINTAINED IN AN ACCEPTABLE AND HEALTHY CONDITION. THE REPLACEMENT OF ANY VEGETATION MATERIALS THAT DIE OR ARE IN AN UNHEALTHY CONDITION SHALL BE REQUIRED.

I HEREBY ACKNOWLEDGE THAT I HAVE READ THIS APPLICATION AND THE ABOVE IS CORRECT AND I AGREE TO COMPLY WITH THE REQUIREMENTS ABOVE. FAILURE TO COMPLY SHALL RESULT IN LEGAL ACTION.

DATE APPROVED: 8/6/90

Antonio Pesina
SIGNATURE

APPROVED BY: Karl M. Meyer

627 W. Colorado
Grand Junction Colo

81505

55 ft

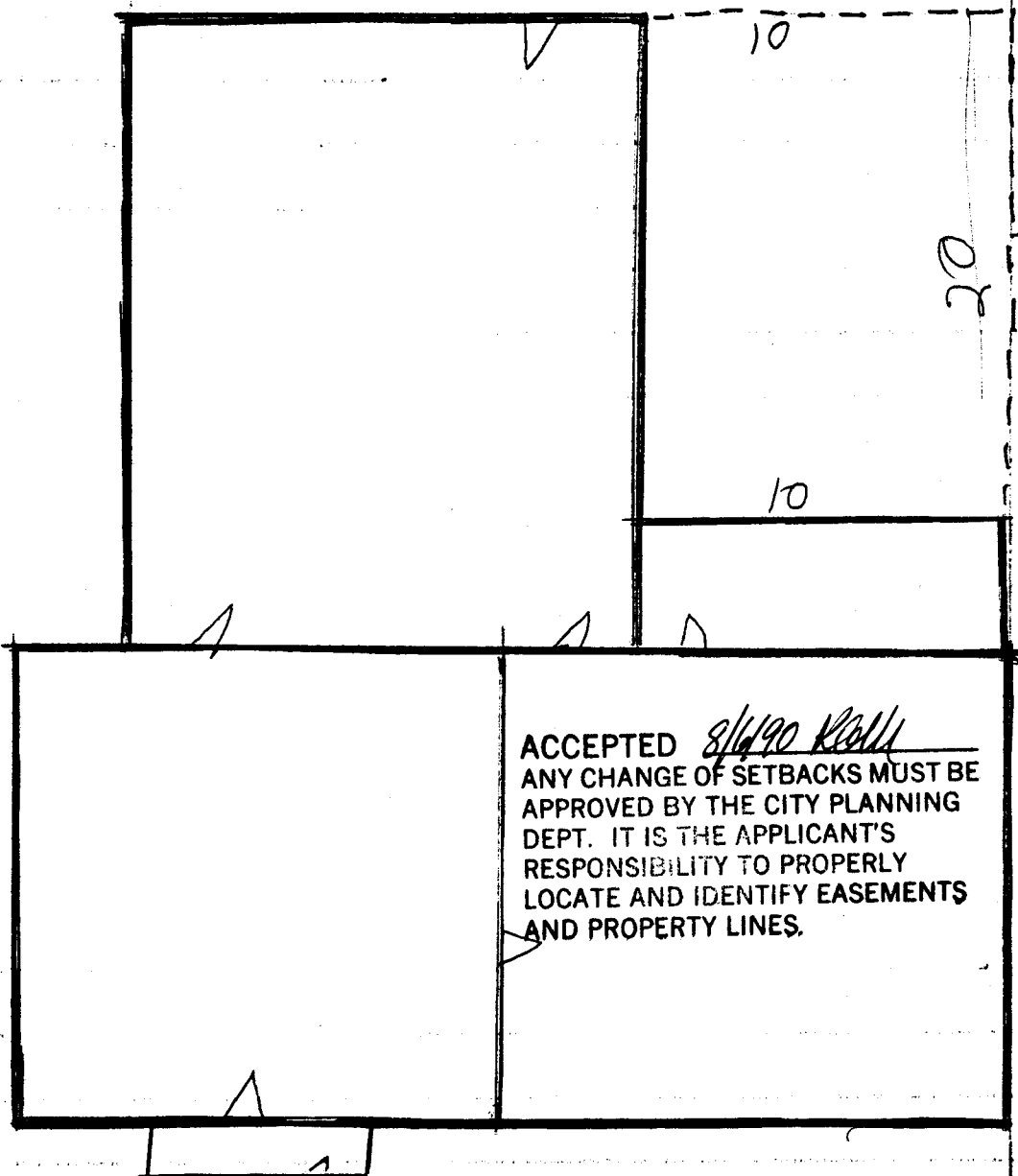

ACCEPTED 8/16/90 Kelly
ANY CHANGE OF SETBACKS MUST BE
APPROVED BY THE CITY PLANNING
DEPT. IT IS THE APPLICANT'S
RESPONSIBILITY TO PROPERLY
LOCATE AND IDENTIFY EASEMENTS
AND PROPERTY LINES.

20 ft
10 ft