

DATE SUBMITTED: Mar 19, 1990

PERMIT # 035460

FEE \$10.00

# PLANNING CLEARANCE

GRAND JUNCTION PLANNING DEPARTMENT

BLDG ADDRESS: 547 Melody Lane

SQ. FT. OF BLDG: 1976 sq ft.

SUBDIVISION: \_\_\_\_\_

SQ. FT. OF LOT: 700' x 700'

FILING # \_\_\_\_\_ BLK # \_\_\_\_\_ LOT # \_\_\_\_\_

NUMBER OF FAMILY UNITS: N/A

TAX SCHEDULE NUMBER:

NUMBER OF BUILDINGS ON PARCEL BEFORE THIS PLANNED CONSTRUCTION:

2943-074-00-951

1 - LDS STAKE CENTER (CHURCH)

PROPERTY OWNER: Church of Jesus Christ of Latter Day Saints

USE OF ALL EXISTING BUILDINGS:

ADDRESS: 547 Melody Lane

Church is only existing Building

PHONE: 242-6437

DESCRIPTION OF WORK AND INTENDED USE:

Construction of Picnic Pavilion

SUBMITTALS REQ'D: TWO (2) PLOT PLANS SHOWING PARKING, LANDSCAPING, SETBACKS TO ALL PROPERTY LINES, AND ALL STREETS WHICH ABUT THE PARCEL.

\*\*\*\*\*

### FOR OFFICE USE ONLY

ZONE: R3F8

FLOODPLAIN: YES \_\_\_\_\_ NO X

SETBACKS: F 20 S 5 R 3

GEOLOGIC HAZARD: YES \_\_\_\_\_ NO \_\_\_\_\_

MAXIMUM HEIGHT: 32

CENSUS TRACT #: 6

PARKING SPACES REQ'D: existing

TRAFFIC ZONE: 30

LANDSCAPING/SCREENING: existing

SPECIAL CONDITIONS: \_\_\_\_\_

\*\*\*\*\*

ANY MODIFICATION TO THIS APPROVED PLANNING CLEARANCE MUST BE APPROVED, IN WRITING, BY THE DEPARTMENT. THE STRUCTURE APPROVED BY THIS APPLICATION CANNOT BE OCCUPIED UNTIL A CERTIFICATE OF OCCUPANCY (C.O.) IS ISSUED BY THE BUILDING DEPARTMENT (SECTION 307, UNIFORM BUILDING CODE.)

ANY LANDSCAPING REQUIRED BY THIS PERMIT SHALL BE MAINTAINED IN AN ACCEPTABLE AN HEALTHY CONDITION. THE REPLACEMENT OF ANY VEGETATION MATERIALS THAT DIE OR ARE IN AN UNHEALTHY CONDITION SHALL BE REQUIRED.

I HEREBY ACKNOWLEDGE THAT I HAVE READ THIS APPLICATION AND THE ABOVE IS CORRECT AND I AGREE TO COMPLY WITH THE REQUIREMENTS ABOVE. FAILURE TO COMPLY SHALL RESULT IN LEGAL ACTION.

DATE APPROVED: 3/20/90

APPROVED BY: Kathy Portman

John Dolman  
SIGNATURE

of LITTLE DAY SAINTS PROPERTY

ORCHARD AVENUE

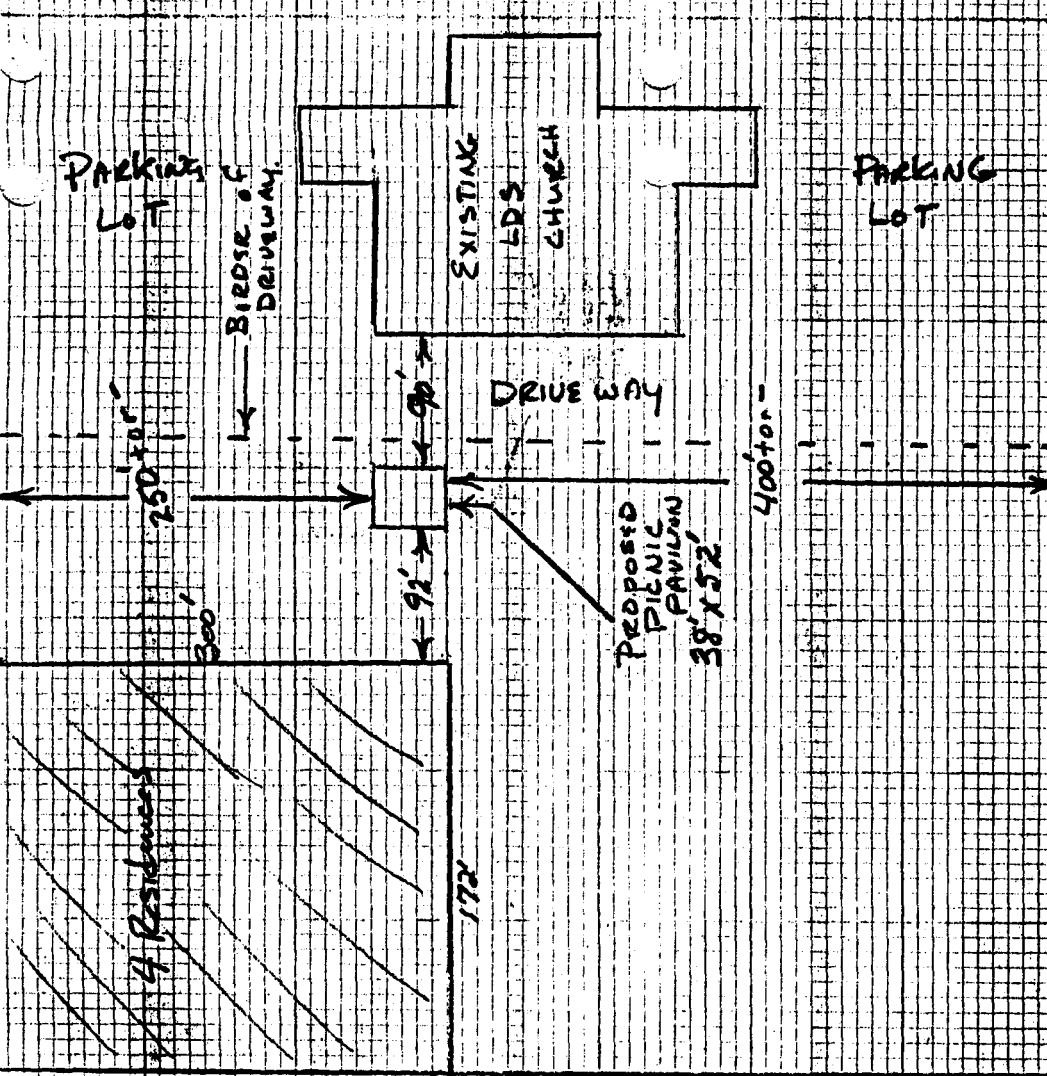

ACCEPTED 11/30/90  
 ANY CHANGES TO THESE PLANS MUST BE  
 APPROVED BY THE CITY PLANNING  
 DEPT. FOR THE CITY OF PHOENIX  
 RES. DEPARTMENT TO PROPERLY  
 LOCATE AND IDENTIFY EASEMENTS  
 AND PROPERTY LINES.

RESIDENTIAL HOUSING

MELODY LANE

MESA AVENUE

RESIDENTIAL HOUSING

28 1/4 87