

DATE SUBMITTED: April 13, 1990

PERMIT # 35604

FEE \$500

# PLANNING CLEARANCE

GRAND JUNCTION PLANNING DEPARTMENT

BLDG ADDRESS: 311 PINON

SQ. FT. OF BLDG: 530

SUBDIVISION: Valley View Minor

SQ. FT. OF LOT: \_\_\_\_\_

FILING # \_\_\_\_\_ BLK # \_\_\_\_\_ LOT # \_\_\_\_\_

NUMBER OF FAMILY UNITS: 1

TAX SCHEDULE NUMBER:  
2945-243-28002

NUMBER OF BUILDINGS ON PARCEL BEFORE THIS PLANNED CONSTRUCTION:  
1

PROPERTY OWNER: LANGE

USE OF ALL EXISTING BUILDINGS:  
Single Family

ADDRESS: 311 PINON

PHONE: \_\_\_\_\_

DESCRIPTION OF WORK AND INTENDED USE:  
DETACHED GARAGE

SUBMITTALS REQ'D: TWO (2) PLOT PLANS SHOWING PARKING, LANDSCAPING, SETBACKS TO ALL PROPERTY LINES, AND ALL STREETS WHICH ABUT THE PARCEL.

\*\*\*\*\*  
FOR OFFICE USE ONLY

ZONE: RSF-8

FLOODPLAIN: YES \_\_\_\_\_ NO /

SETBACKS: F 20' S 3' R 3'

GEOLOGIC HAZARD: YES \_\_\_\_\_ NO \_\_\_\_\_

MAXIMUM HEIGHT: 32'

CENSUS TRACT #: 13

PARKING SPACES REQ'D: /

TRAFFIC ZONE: 80

LANDSCAPING/SCREENING: /

SPECIAL CONDITIONS: \_\_\_\_\_

\*\*\*\*\*  
ANY MODIFICATION TO THIS APPROVED PLANNING CLEARANCE MUST BE APPROVED, IN WRITING, BY THE DEPARTMENT. THE STRUCTURE APPROVED BY THIS APPLICATION CANNOT BE OCCUPIED UNTIL A CERTIFICATE OF OCCUPANCY (C.O.) IS ISSUED BY THE BUILDING DEPARTMENT (SECTION 307, UNIFORM BUILDING CODE.)

ANY LANDSCAPING REQUIRED BY THIS PERMIT SHALL BE MAINTAINED IN AN ACCEPTABLE AND HEALTHY CONDITION. THE REPLACEMENT OF ANY VEGETATION MATERIALS THAT DIE OR ARE IN AN UNHEALTHY CONDITION SHALL BE REQUIRED.

I HEREBY ACKNOWLEDGE THAT I HAVE READ THIS APPLICATION AND THE ABOVE IS CORRECT AND I AGREE TO COMPLY WITH THE REQUIREMENTS ABOVE. FAILURE TO COMPLY SHALL RESULT IN LEGAL ACTION.

DATE APPROVED: 4-13-90  
APPROVED BY: David Alvarado

[Signature]  
SIGNATURE

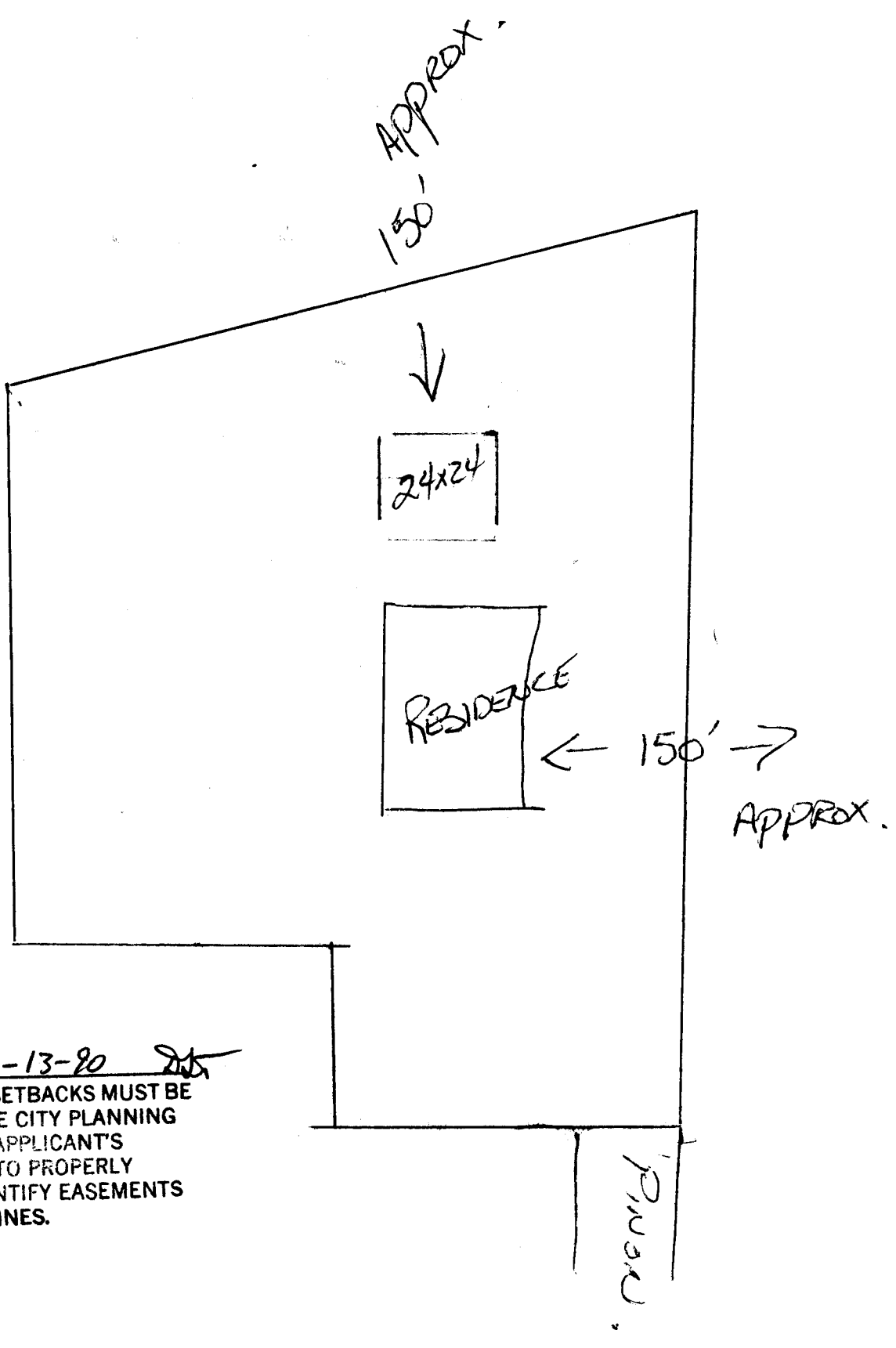

ACCEPTED 4-13-80 *[Signature]*  
ANY CHANGE OF SETBACKS MUST BE  
APPROVED BY THE CITY PLANNING  
DEPT. IT IS THE APPLICANT'S  
RESPONSIBILITY TO PROPERLY  
LOCATE AND IDENTIFY EASEMENTS  
AND PROPERTY LINES.