

DATE SUBMITTED: 9/9/91

PERMIT NO. 39756

FEE \$ No Charge

PLANNING CLEARANCE
GRAND JUNCTION COMMUNITY DEVELOPMENT DEPARTMENT

BLDG ADDRESS: 1641 GRAND

SQ. FT. OF BLDG: 103' x 28'

SUBDIVISION: _____

SQ. FT. OF LOT: _____

FILING NO. ___ BLK NO. ___ LOT NO. ___

NO. OF FAMILY UNITS: 1

TAX SCHEDULE NO: 2945 133 02 014

NUMBER OF BUILDINGS ON PARCEL BEFORE THIS PLANNED CONSTRUCTION: 2

OWNER: JANE E. JURSEZKY

USE OF EXISTING BUILDINGS: (2) (OLD GARAGE STORAGE)

ADDRESS: 1641 GRAND AVE.

DESCRIPTION OF WORK AND INTENDED USE: CAR PORT

TELEPHONE: 242-1237

SUBMITTALS REQUIRED: Two plot plans showing parking, landscaping, setbacks to all property lines, and all streets which abut the parcel.

FOR OFFICE USE ONLY

ZONE RSF-8

FLOODPLAIN: YES ___ NO X

SETBACKS: FRONT 37' (20' Req'd)

GEOLOGIC HAZARD: YES ___ NO X

SIDE 3' REAR 15'

CENSUS TRACT: 7 TRAFFIC ZONE: 40

MAXIMUM HEIGHT 32'

PARKING REQ'MT _____

LANDSCAPING/SCREENING REQUIRED: _____

SPECIAL CONDITIONS: _____

Modifications to this Planning Clearance must be approved, in writing, by this Department. The structure approved by this application cannot be occupied until a Certificate of Occupancy is issued by the Building Department (Section 307, Uniform Building Code).

Any landscaping required by this permit shall be maintained in an acceptable and healthy condition. The replacement of any vegetation materials that die or are in an unhealthy condition shall be required.

I hereby acknowledge that I have read this application and the above is correct, and I agree to comply with the requirements above. Failure to comply shall result in legal action.

Walter A. Orbeck
Department Approval
9/9/91
Date Approved

Jane E. Jursecky
Applicant Signature
9/9/91
Date

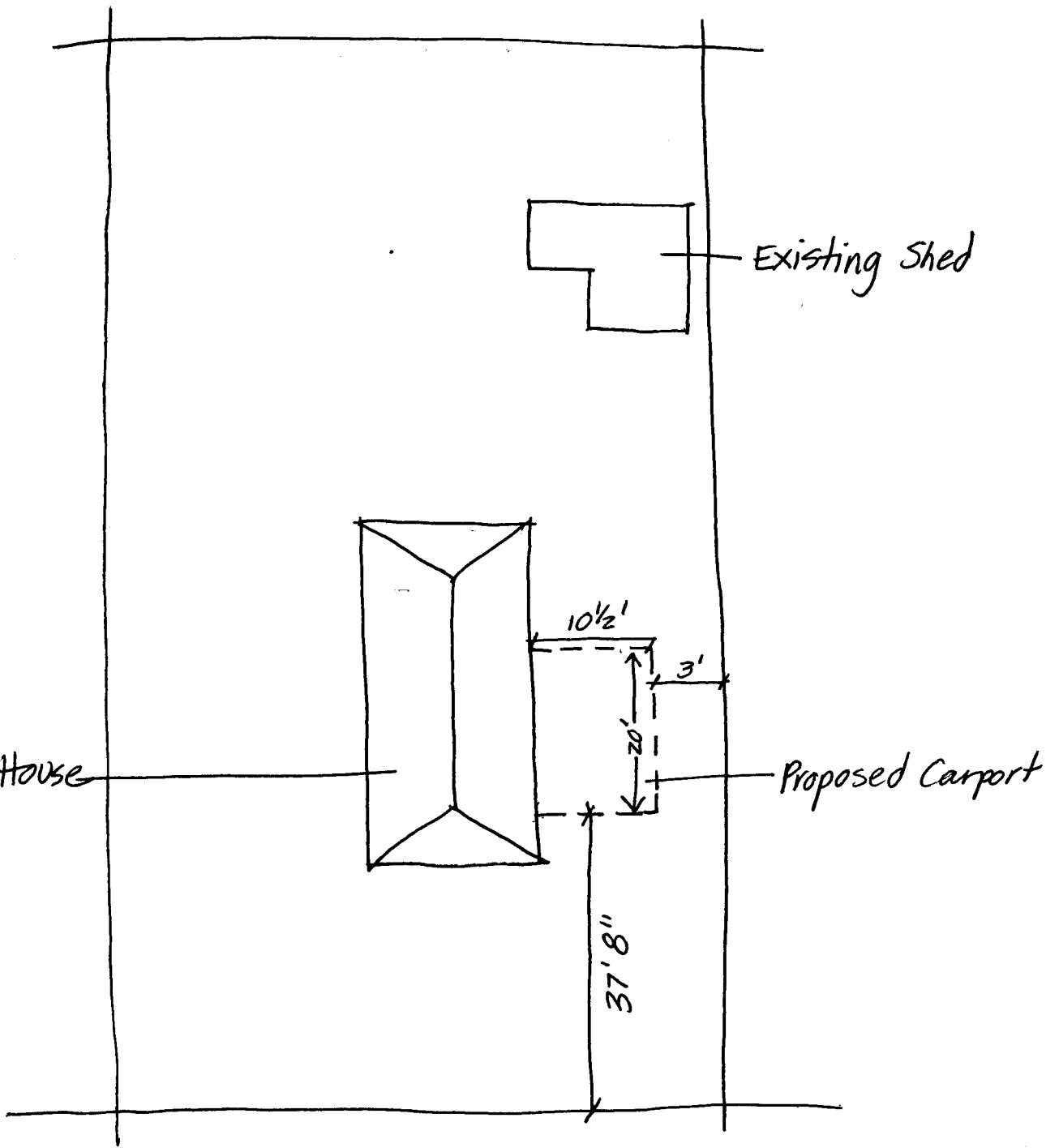

1641
GRAND

ACCEPTED KKA 9/9/91
 CITY OF GRAND RAPIDS PLANNING DEPT.
 PROVIDES PLANNING DEPARTMENT'S
 RESPONSIBILITY TO PROPERLY
 LOCATE AND IDENTIFY EASEMENTS
 AND PROPERTY LINES.

