

DATE SUBMITTED: June 25/91

PERMIT # 39064

FEE \$5.00

# PLANNING CLEARANCE

GRAND JUNCTION PLANNING DEPARTMENT

BLDG ADDRESS: 283 W Parkview

SQ. FT. OF BLDG: \_\_\_\_\_

SUBDIVISION: Parkview

SQ. FT. OF LOT: 125 x 75

FILING # \_\_\_\_\_ BLK # 3 LOT # 12

NUMBER OF FAMILY UNITS: 1

TAX SCHEDULE NUMBER:

NUMBER OF BUILDINGS ON PARCEL BEFORE THIS PLANNED CONSTRUCTION:

2945 252 22 012

Two

PROPERTY OWNER: Joseph & Deborah Krabachor

USE OF ALL EXISTING BUILDINGS:

ADDRESS: 283 W Parkview

Residential

PHONE: 243 8308

DESCRIPTION OF WORK AND INTENDED USE:

SUBMITTALS REQ'D: TWO (2) PLOT PLANS SHOWING PARKING, LANDSCAPING, SETBACKS TO ALL PROPERTY LINES, AND ALL STREETS WHICH ABUT THE PARCEL.

patio-deck for hot-tub

\*\*\*\*\*

### FOR OFFICE USE ONLY

ZONE: RSE-8

FLOODPLAIN: YES \_\_\_\_\_ NO ✓

SETBACKS: F 45 S 5 R 15

GEOLOGIC HAZARD: YES \_\_\_\_\_ NO \_\_\_\_\_

MAXIMUM HEIGHT: 32

CENSUS TRACT #: 13

PARKING SPACES REQ'D: \_\_\_\_\_

TRAFFIC ZONE: 80

LANDSCAPING/SCREENING: \_\_\_\_\_

SPECIAL CONDITIONS: \_\_\_\_\_

\*\*\*\*\*

ANY MODIFICATION TO THIS APPROVED PLANNING CLEARANCE MUST BE APPROVED, IN WRITING, BY THIS DEPARTMENT. THE STRUCTURE APPROVED BY THIS APPLICATION CANNOT BE OCCUPIED UNTIL A CERTIFICATE OF OCCUPANCY (C.O.) IS ISSUED BY THE BUILDING DEPARTMENT (SECTION 307, UNIFORM BUILDING CODE.)

ANY LANDSCAPING REQUIRED BY THIS PERMIT SHALL BE MAINTAINED IN AN ACCEPTABLE AN HEALTHY CONDITION. THE REPLACEMENT OF ANY VEGETATION MATERIALS THAT DIE OR ARE IN AN UNHEALTHY CONDITION SHALL BE REQUIRED.

I HEREBY ACKNOWLEDGE THAT I HAVE READ THIS APPLICATION AND THE ABOVE IS CORRECT AND I AGREE TO COMPLY WITH THE REQUIREMENTS ABOVE. FAILURE TO COMPLY SHALL RESULT IN LEGAL ACTION.

DATE APPROVED: June 25, 91

APPROVED BY: [Signature]

[Signature]  
SIGNATURE

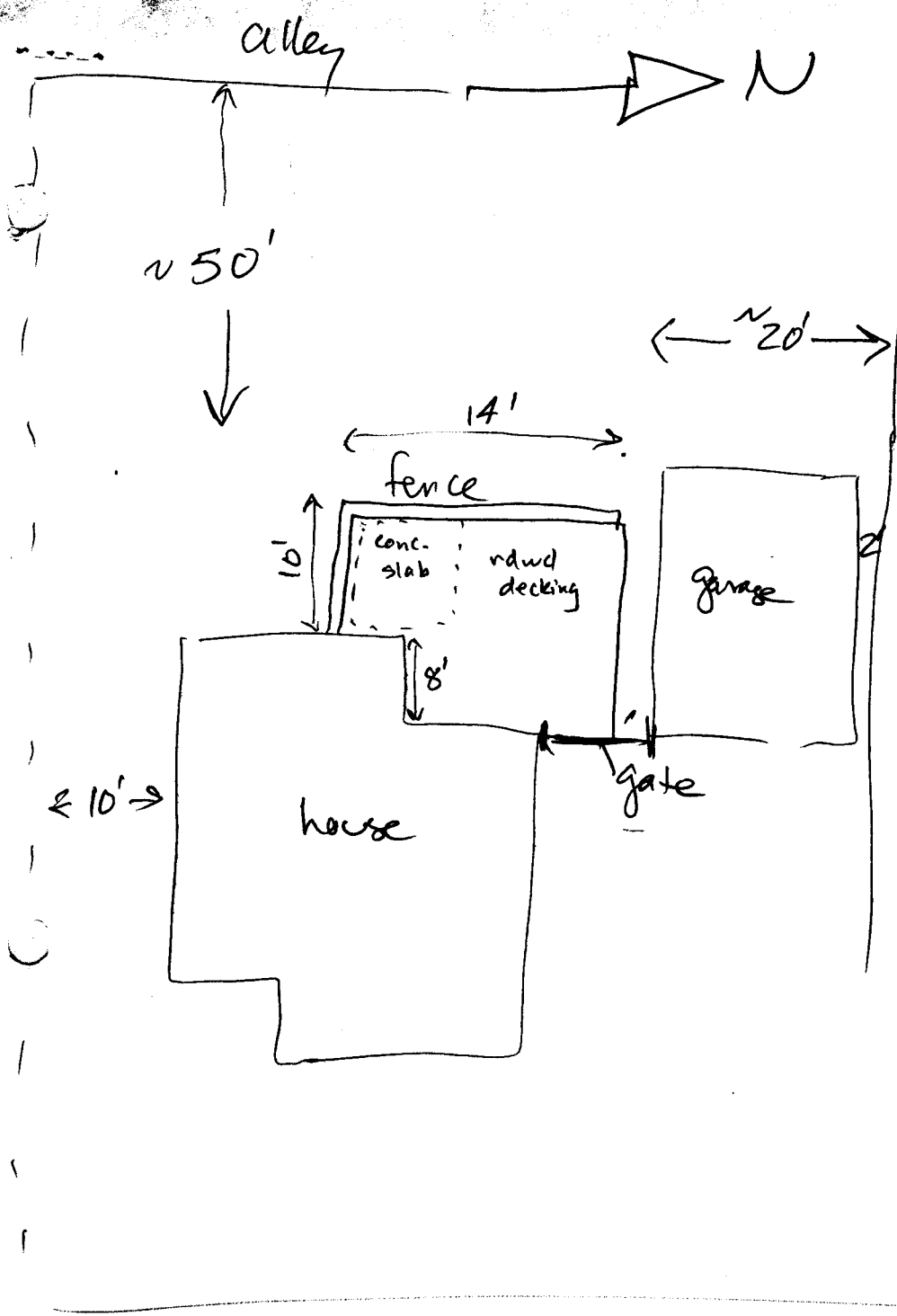

W Parkview

ACCEPTED HW 4/25/99  
 ANY CHANGE OF SETBACKS MUST BE  
 APPROVED BY THE CITY PLANNING  
 DEPT. IT IS THE APPLICANT'S  
 RESPONSIBILITY TO PROPERLY  
 LOCATE AND IDENTIFY EASEMENTS  
 AND PROPERTY LINES.