

DATE SUBMITTED: 4-14-93

PERMIT NO. #44643

FEE \$ 5.00

PLANNING CLEARANCE

GRAND JUNCTION COMMUNITY DEVELOPMENT DEPARTMENT

BLDG ADDRESS 545 29 Rd

SQ. FT. OF BLDG: Addition 462 sf

SUBDIVISION ~~XXXXXX~~

SQ. FT. OF LOT: Same (3,050 sf)

FILING # _____ BLK # _____ LOT # _____

NO. OF FAMILY UNITS: 1

TAX SCHEDULE # 2943-074-00-079

NO. OF BUILDINGS ON PARCEL BEFORE THIS PLANNED CONSTRUCTION: 2

OWNER FRANK JONES

USE OF EXISTING BUILDINGS: House + Garage

ADDRESS 545 29 Rd

TELEPHONE: 343-0018

DESCRIPTION OF WORK AND INTENDED USE: New Construction - Sun Patch (14x33)

REQUIRED: Two plot plans showing parking, landscaping, setbacks to all property lines, and all streets which abut the parcel.

FOR OFFICE USE ONLY

ZONE RSF-8

Designated
FLOODPLAIN: YES _____ NO

SETBACKS: FRONT 20'

GEOLOGIC HAZARD: YES _____ NO _____

SIDE 5' REAR 15'

CENSUS TRACT: 6 TRAFFIC ZONE: 30

MAXIMUM HEIGHT 32'

PARKING REQ'MT _____

LANDSCAPING/SCREENING REQUIRED: _____

SPECIAL CONDITIONS: _____

Modifications to this Planning Clearance must be approved, in writing, by this Department. The structure approved by this application cannot be occupied until a Certificate of Occupancy is issued by the Building Department (Section 307, Uniform Building Code).

Any landscaping required by this permit shall be maintained in an acceptable and healthy condition. The replacement of any vegetation materials that die or are in an unhealthy condition shall be required.

I hereby acknowledge that I have read this application and the above is correct, and I agree to comply with the requirements above. Failure to comply shall result in legal action.

M. Pety
Department Approval

[Signature]
Applicant Signature

4-14-93
Date Approved

4/14/93
Date

VALID FOR SIX MONTHS FROM DATE OF ISSUANCE (Section 9-3-2 D Grand Junction Zoning & Development Code)

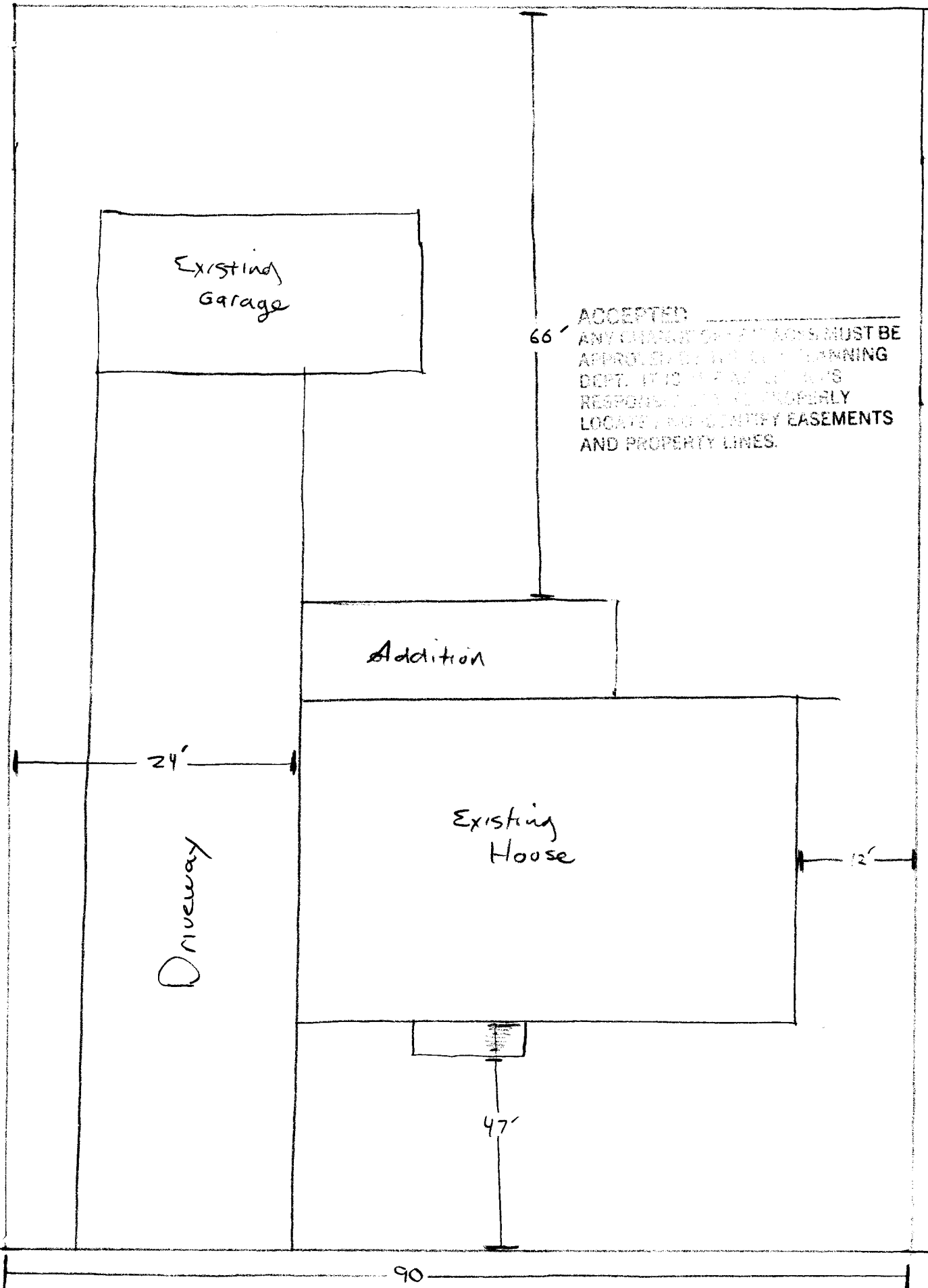

ACCEPTED
ANY CHANGE OF PLANS MUST BE
APPROVED BY THE PLANNING
DEPT. IT IS THE APPLICANT'S
RESPONSIBILITY TO PROPERLY
LOCATE AND IDENTIFY EASEMENTS
AND PROPERTY LINES.

90

145

29 RD.