

DATE SUBMITTED 11-22-93

BUILDING PERMIT NO. 47026

FEE \$ 10⁰⁰

PLANNING CLEARANCE

(Major site plan review, multi-family development, non-residential development, interior remodels)

East Middle School Grand Junction Department of Community Development

BLDG ADDRESS 830 Gunnison Ave

SQ. FT. OF PROPOSED BLDG(S)/ADDITION 7x33 = 221 #/ft

SUBDIVISION 2945-141-22-942

SQ. FT. OF EXISTING BLDG(S) -

FILING - BLK 41 LOT 1 thru 32

NO. OF FAMILY UNITS -

TAX SCHEDULE NO. -

NO. OF BLDGS ON PARCEL BEFORE THIS CONSTRUCTION -

OWNER School District 51

USE OF EXISTING BLDGS school

ADDRESS 830 Gunnison Ave

DESCRIPTION OF WORK AND INTENDED USE: addition

TELEPHONE 245-2938

Submittal requirements are outlined in the SSID (Submittal Standards for Improvements and Development) document.

ZONE PZ

DESIGNATED FLOODPLAIN: YES - NO X

SETBACKS: Front 40' from property line or 40' from center of ROW, whichever is greater

GEOLOGIC HAZARD: YES - NO -

Side 0' from property line

CENSUS TRACT 2 TRAFFIC ZONE 36

Rear 0' from property line

Parking Req'mt -

Maximum Height 65'

File Number -

Maximum coverage of lot by structures -

Special Conditions: -

Landscaping/Screening Req'd -

Modifications to this Planning Clearance must be approved, in writing, by this Department. The structure approved by this application cannot be occupied until a Certificate of Occupancy is issued by the Building Department (Section 307, Uniform Building Code). Required improvements in the public right-of-way must be guaranteed prior to issuance of a Planning Clearance. All other required site improvements must be completed or guaranteed prior to issuance of a Certificate of Occupancy. Any landscaping required by this permit shall be maintained in an acceptable and healthy condition. The replacement of any vegetation materials that die or are in an unhealthy condition shall be required.

Four (4) sets of final construction drawings must be submitted and stamped by City Engineering prior to issuing the Planning Clearance. One stamped set must be available on the job site at all times.

I hereby acknowledge that I have read this application and the above is correct, and I agree to comply with the requirements above. Failure to comply shall result in legal action.

Department Approval [Signature]

Applicant Signature [Signature]

Date Approved 11-22-93

Date 11/22/93

VALID FOR SIX MONTHS FROM DATE OF ISSUANCE (Section 9-3-2D Grand Junction Zoning & Development Code)

(White: Planning) (Yellow: Customer) (Pink: Building Department)

EXISTING DOORS REMAIN.

OVERHANG TO
STING ON STORAGE
& SOUTH.

V. METAL
TEAM ROOFING
LYWOOD
WOOD TRUSSES
PITCH TO MATCH
STORAGE ADDITION

ON 3 5/8" MTL.
6" O.C., 3/4"
HEATING.
NETIC STUCCO
TICAL
1/2" FIBERGLASS
ATION IN STUD
VAPOR BARRIER.

TUCCO COATING
F.F., TYP.

24" x 48" STATIC
TROFFER by LITHONIA
277v, (3) LAMP, SURFACE
MNT'd FLUOR. FIXTURE,
WHITE ENAMEL STL. HOUSING
and .125" ACRYLIC LENS.
TYP. (4) LOCs.
FIXTURES SUPPLIED by
OWNER, INSTALLED by
CONTRACTOR.

TECHNICAL STORAGE EDUCATION ADDITION

EXISTING DOORS REMAIN.

NEW 4" CONC. SLAB REINF. W/FIBERMESH
ON EXISTING CONC. WALK. FINISH TO MATCH EXISTING

HEAVY DUTY METAL SHELVING
SYSTEM by OWNER. CONTRACTOR TO
PROVIDE BLOCKING IN WALL FOR
SHELVING ATTACHMENT.

EXISTING TECH. ED.
CLASSROOM

CUT OPENING IN EXISTING BLOCK/MASONRY
WALL AS SHOWN. PROVIDE LINTEL AS REQ'd.
PROVIDE 1 3/4" METAL DOOR, MINERAL
FIBER INSULATION, HOLLOW METAL FRAME.
PROVIDE RAMP AT NEW DOOR.
PROVIDE DOOR SIGNAGE-"NOT AN EXT".
"BEST" LOCK by OWNER. PROVIDE H'CAP LEVER.

NEW WALL MOUNTED DOOR BUMPER.

EXISTING CONC. WALK
REMAINS, PROTECT FROM
CONSTRUCTION ACTIVITY.

EXISTING BLOCK/MASONRY WALL REMAINS.

ACCEPTED *das* 11-22-93
ANY CHANGE OF SETBACKS MUST BE
APPROVED BY THE CITY PLANNING
DEPT. IT IS THE APPLICANT'S
RESPONSIBILITY TO PROPERLY
LOCATE AND IDENTIFY EASEMENTS
AND PROPERTY LINES.

B

N STORAGE ADDITION - EAST MIDDLE SCHOOL

STTECH.DWG
03.30.93

REVISIONS	BY

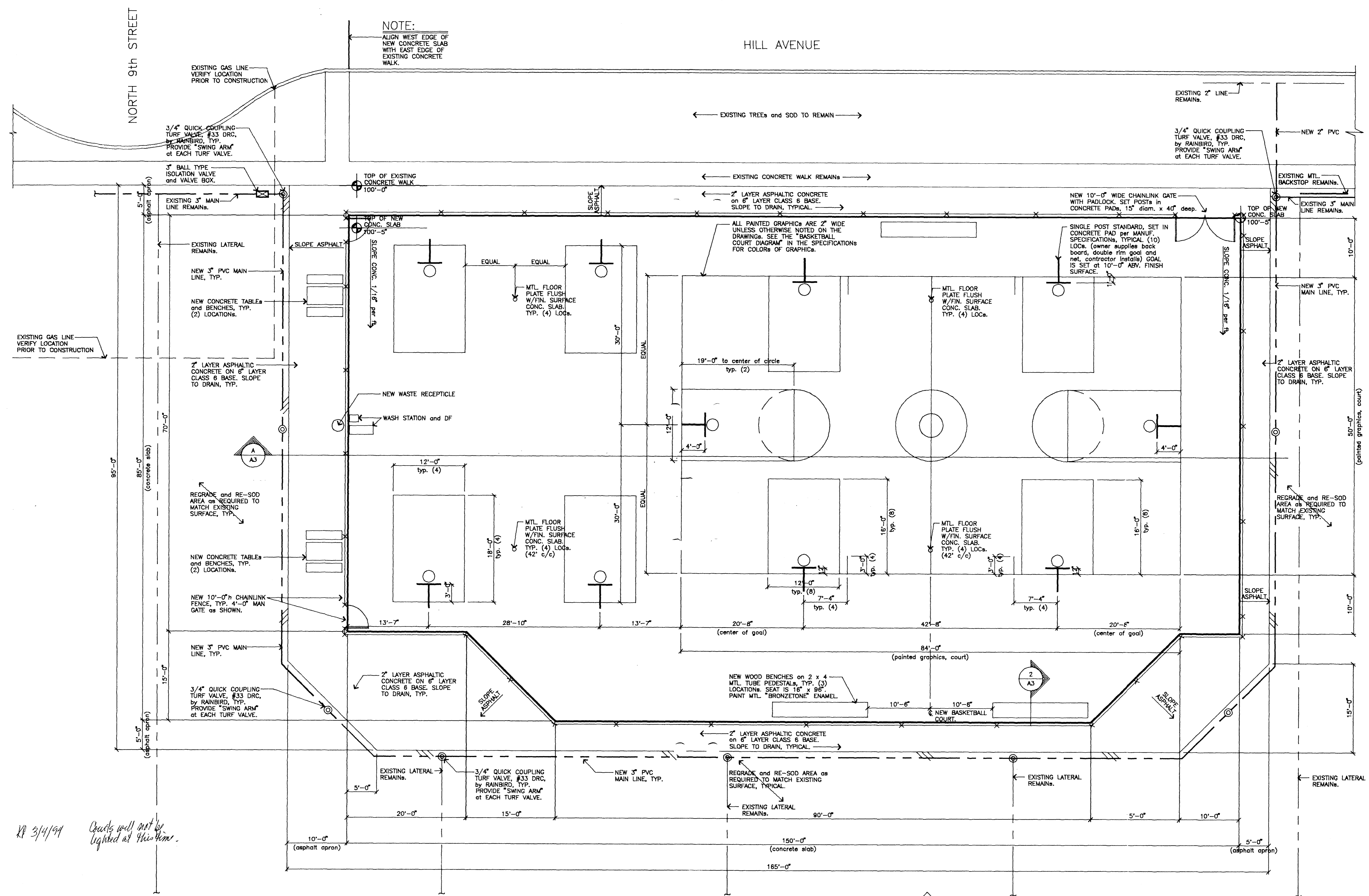

RP 3/1/94 Courts will not be lighted at this time.

ENLARGED PLAN of NEW CONSTRUCTION

1/8" = 1'-0"
 EMSPLAN.DWG
 02 FEB 94
 07 FEB 94
 09 FEB 94
 25 FEB 94
 02 MAR 94

DRAWN
CHECKED
DATE
SCALE
JOB NO.
SHEET
OF SHEETS