

DATE SUBMITTED: 14 JAN 93

PERMIT NO. 44005, 44006

FEE \$ 10.00 44007

PLANNING CLEARANCE

GRAND JUNCTION COMMUNITY DEVELOPMENT DEPARTMENT

BLDG ADDRESS 2380 115 Hwy 6 & 50

SQ. FT. OF BLDG: _____

SUBDIVISION _____

SQ. FT. OF LOT: _____

FILING # _____ BLK # _____ LOT # _____

NO. OF FAMILY UNITS: _____

TAX SCHEDULE # 294505400016

NO. OF BUILDINGS ON PARCEL BEFORE THIS PLANNED CONSTRUCTION: 1

OWNER PITON GROUP PARTNERS

USE OF EXISTING BUILDINGS: COMMERCIAL

ADDRESS 5100 E 59TH COMMERCIAL CITY

TELEPHONE: 242-5776

DESCRIPTION OF WORK AND INTENDED USE:
3EA TEMPORARY OFFICE TRAILERS
ACCOMMODATE PERSONNEL DURING REMEDIATION

REQUIRED: Two plot plans showing parking, landscaping, setbacks to all property lines, and all streets which abut the parcel.

FOR OFFICE USE ONLY

ZONE I-1

FLOODPLAIN: YES _____ NO X

SETBACKS: FRONT _____

GEOLOGIC HAZARD: YES _____ NO X

SIDE _____ REAR _____

CENSUS TRACT: 9 TRAFFIC ZONE: B

MAXIMUM HEIGHT _____

PARKING REQ'MT _____

LANDSCAPING/SCREENING REQUIRED: _____

SPECIAL CONDITIONS:
temporary trailers for construction
not to exceed 6 months

Modifications to this Planning Clearance must be approved, in writing, by this Department. The structure approved by this application cannot be occupied until a Certificate of Occupancy is issued by the Building Department (Section 307, Uniform Building Code).

Any landscaping required by this permit shall be maintained in an acceptable and healthy condition. The replacement of any vegetation materials that die or are in an unhealthy condition shall be required.

I hereby acknowledge that I have read this application and the above is correct, and I agree to comply with the requirements above. Failure to comply shall result in legal action.

Angeline Barrett
Department Approval

[Signature]
Applicant Signature

1/14/93
Date Approved

14 Jan 93
Date

VALID FOR SIX MONTHS FROM DATE OF ISSUANCE (Section 9-3-2 D Grand Junction Zoning & Development Code)

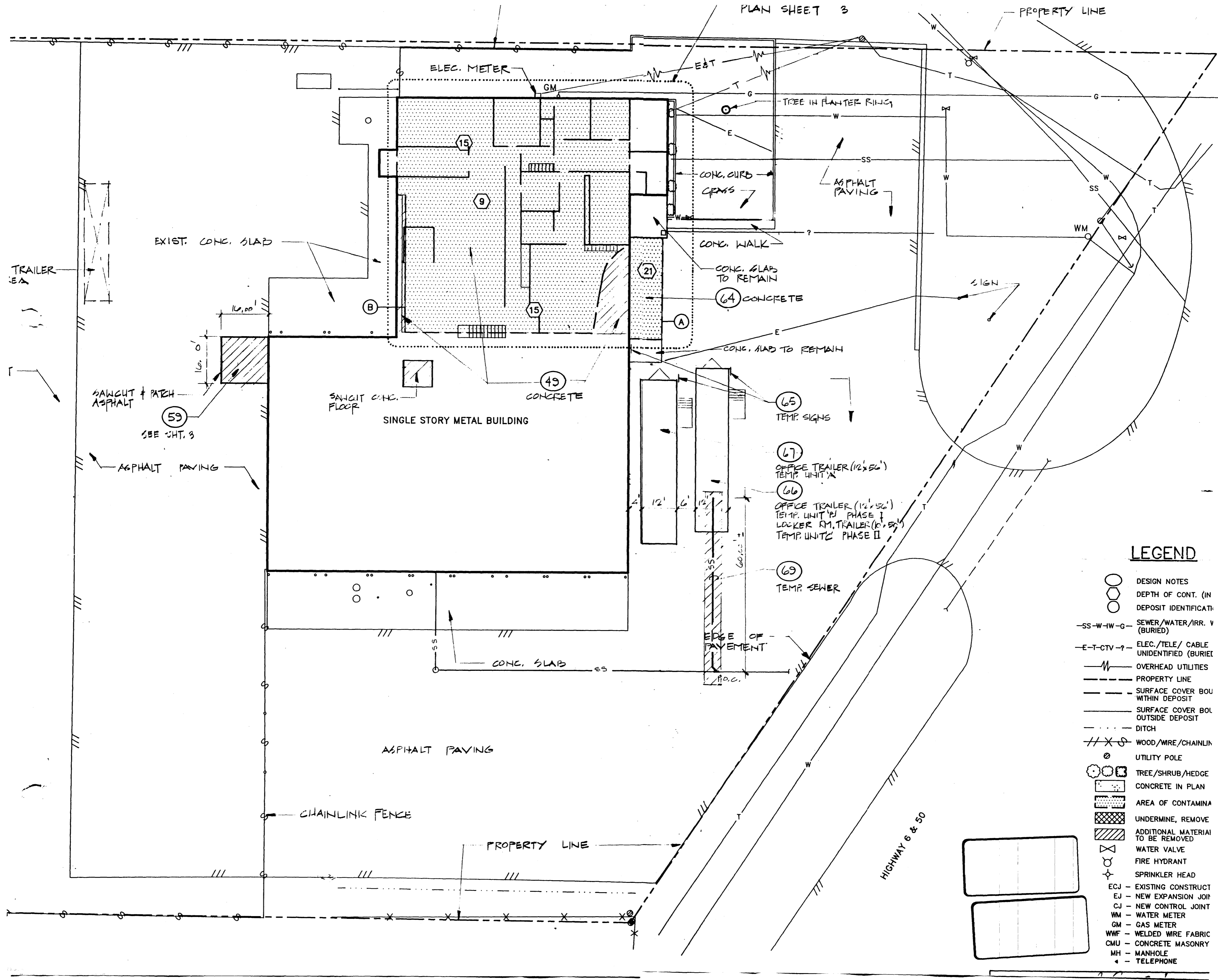

LEGEND

- DESIGN NOTES
- DEPTH OF CONT. (IN DEPOSIT IDENTIFICATION)
- SS-W-W-G- SEWER/WATER/IRR. V (BURIED)
- E-T-CTV-? ELEC./TELE/ CABLE UNIDENTIFIED (BURIED)
- OVERHEAD UTILITIES
- - - - - PROPERTY LINE
- - - - - SURFACE COVER BOU WITHIN DEPOSIT
- - - - - SURFACE COVER BOU OUTSIDE DEPOSIT
- - - - - DITCH
- /// X S WOOD/WRE/CHAINLINK
- UTILITY POLE
- TREE/SHRUB/HEDGE
- CONCRETE IN PLAN
- AREA OF CONTAMINA
- UNDERMINE, REMOVE
- ADDITIONAL MATERIAL TO BE REMOVED
- △ WATER VALVE
- FIRE HYDRANT
- SPRINKLER HEAD
- ECJ - EXISTING CONSTRUCT
- EJ - NEW EXPANSION JOI
- CJ - NEW CONTROL JOINT
- WM - WATER METER
- GM - GAS METER
- WWF - WELDED WIRE FABRIC
- CMU - CONCRETE MASONRY
- MH - MANHOLE
- TELEPHONE