

DATE SUBMITTED: 6/25/93

PERMIT NO. 45531

FEE \$ No Charge

PLANNING CLEARANCE

GRAND JUNCTION COMMUNITY DEVELOPMENT DEPARTMENT

*will be
572*

BLDG ADDRESS 2660 UNANGEP

SQ. FT. OF BLDG: 1344

SUBDIVISION COLUMBUS ELEMENTARY

SQ. FT. OF LOT: _____

FILING # _____ BLK # _____ LOT # _____

NO. OF FAMILY UNITS: _____

TAX SCHEDULE # 2945-234-02-942

NO. OF BUILDINGS ON PARCEL BEFORE THIS PLANNED CONSTRUCTION: _____

OWNER SD 51

USE OF EXISTING BUILDINGS: _____

ADDRESS 2115 GRAND

DESCRIPTION OF WORK AND INTENDED USE:

TELEPHONE: 245 2422

RELOCATE MODULAR

REQUIRED: Two plot plans showing parking, landscaping, setbacks to all property lines, and all streets which abut the parcel.

FOR OFFICE USE ONLY

ZONE PZ

FLOODPLAIN: YES _____ NO _____

SETBACKS: FRONT N/A

GEOLOGIC HAZARD: YES _____ NO X

SIDE 10' REAR 10'

CENSUS TRACT: 13 TRAFFIC ZONE: 80

MAXIMUM HEIGHT 65'

PARKING REQ'MT N/A

LANDSCAPING/SCREENING REQUIRED:
N/A

SPECIAL CONDITIONS:

Modifications to this Planning Clearance must be approved, in writing, by this Department. The structure approved by this application cannot be occupied until a Certificate of Occupancy is issued by the Building Department (Section 307, Uniform Building Code).

Any landscaping required by this permit shall be maintained in an acceptable and healthy condition. The replacement of any vegetation materials that die or are in an unhealthy condition shall be required.

I hereby acknowledge that I have read this application and the above is correct, and I agree to comply with the requirements above. Failure to comply shall result in legal action.

Kristen J. Caldwell
Department Approval

Date Approved

[Signature]
Applicant Signature
6.25.93
Date

VALID FOR SIX MONTHS FROM DATE OF ISSUANCE (Section 9-3-2 D Grand Junction Zoning & Development Code)

BOARD OF EDUCATION

W. Taft Moore, M.D.,
President
Boelke,
President
Debra D. Johns
Larry Learning
Kathie Pinson

(Your public schools...There's no better place to learn.)

**MESA COUNTY VALLEY
SCHOOL DISTRICT
NUMBER 51**

SUPERINTENDENT

Paul Rosier, Ed.D.

June 23, 1993

**EXECUTIVE INSTRUCTIONAL
DIRECTORS**

Eldon D. Beard

Glen H. Gallegos

Janet L. Henwood

Merritt L. Vanderhoofven

Planning Commission
City Hall
Grand Junction, CO 81501

City Council of Grand Junction, Colorado
City Hall
Grand Junction, CO 81501

EXECUTIVE DIRECTORS

Birney L. Cox,
Business Services

Beverly A. Johnson,
Personnel Services

Dear Friends:

This letter is written in order to satisfy the School Board's obligation pursuant to section 22-32-124(1), C.R.S. Pursuant to this statute, it is the School Board's intention to advise you, and request that you consult with the School Board, concerning the proposed construction of a school structure or school building. In order to comply with said statute, we submit herewith a site development plan for your review and comment. Pursuant to the above mentioned statute, you may request a public hearing before the School Board relating to the proposed site development plan.

DIRECTORS

Kathleen B. Kain
Curriculum Services
2523 Patterson Road
Grand Junction, CO
81505-1005
241-2366 FAX 242-7834

Sincerely,

FOR THE BOARD OF EDUCATION

Howard B. Littler,
Pupil Personnel Services
930 Ute Avenue
Grand Junction, CO
81501-3649
243-5236 FAX 243-1943

Wayne Reeder, Ed.D.,
Special Programs
2523 Patterson Road
Grand Junction, CO
81505-1005
241-2366 FAX 242-7834

BY 
Secretary to the Board

Tedd S. Brumbaugh,
Support & Assessment
410 Hill Avenue
Grand Junction, CO
81501-2528
1788 FAX 243-6716

**PUBLIC INFORMATION
OFFICER**

Gary Carr

ADMINISTRATIVE SERVICE CENTER - 2115 GRAND AVENUE - GRAND JUNCTION, CO 81501-8063
(303) 245-2422 FAX (303) 245-2714

PERMIT TO BUILD

MESA COUNTY PUBLIC WORKS DEPARTMENT
BUILDING INSPECTION DIVISION

045531

DATE

PERMIT NUMBER

VALUE

MESA COUNTY
CUBAN
DEBQUE
FRUITA
GRAND JCT.
PALISADE

B.E.
PERMIT TYPE

OWNER: School Dist 51 MOBILE HOME TAX ID NO.:

PROJECT ADDRESS: 2660 Unawap Ave TAX PARCEL NO.: 20145-234-02946
SUBDIVISION: LOT NO. BLOCK NO. FILING NO.

CONTRACTOR ADDRESS PHONE NO. LICENSE NO.

OCCUPANCY: NO. OF UNITS: NO. OF BEDROOMS:

DESCRIPTION OF WORK: Relocate mobile classroom

REQUIRED DOCUMENTS:
RADON SURVEY: 05870 SEWER: N/A SEPTIC:
FOOD FLOW: FOOD HANDLING: PLANNING:
SPECIAL CONDITIONS:

ELECTRICAL CONTRACTOR LICENSE NO. VALUE
PLUMBING CONTRACTOR LICENSE NO. VALUE
MECHANICAL CONTRACTOR LICENSE NO. VALUE

EXEMPT MONTHLY ON COMPLETION
EXEMPTION NO.

I hereby acknowledge the USE TAX filing status noted above and agree to abide by the provisions and regulations of the County Sales and Use Tax Resolution MCM-81-199. I understand that I am responsible for maintaining adequate accounting records that are subject to audit for 3 years to substantiate my use tax return.

- 1. USE TAX UPON PURCHASE OF ALL MATERIALS WHICH THE GRAND JUNCTION SALES TAX HAS NOT BEEN PAID: You may summarize by supplier on USE TAX FORM NO. 118 the amount of materials used. This shall be done upon completion of the job and paid directly on the FINANCE DIRECTOR'S OFFICE.
- 2. PAYMENT OF TAX DIRECTLY OF SUPPLIER: I hereby certify that all materials used in the above construction will be purchased within the city limits and the Sales Tax paid directly to the supplier. All purchase records and invoices will be retained for three years. I certify that the statements made herein are true and correct to the best of my knowledge.

X

X

PERMIT FEE N/C

I acknowledge that the above information is correct to the best of my knowledge, and I agree to comply with all city or county ordinances regulating building construction.

Contractor/Owner Signature

Building Department Signature

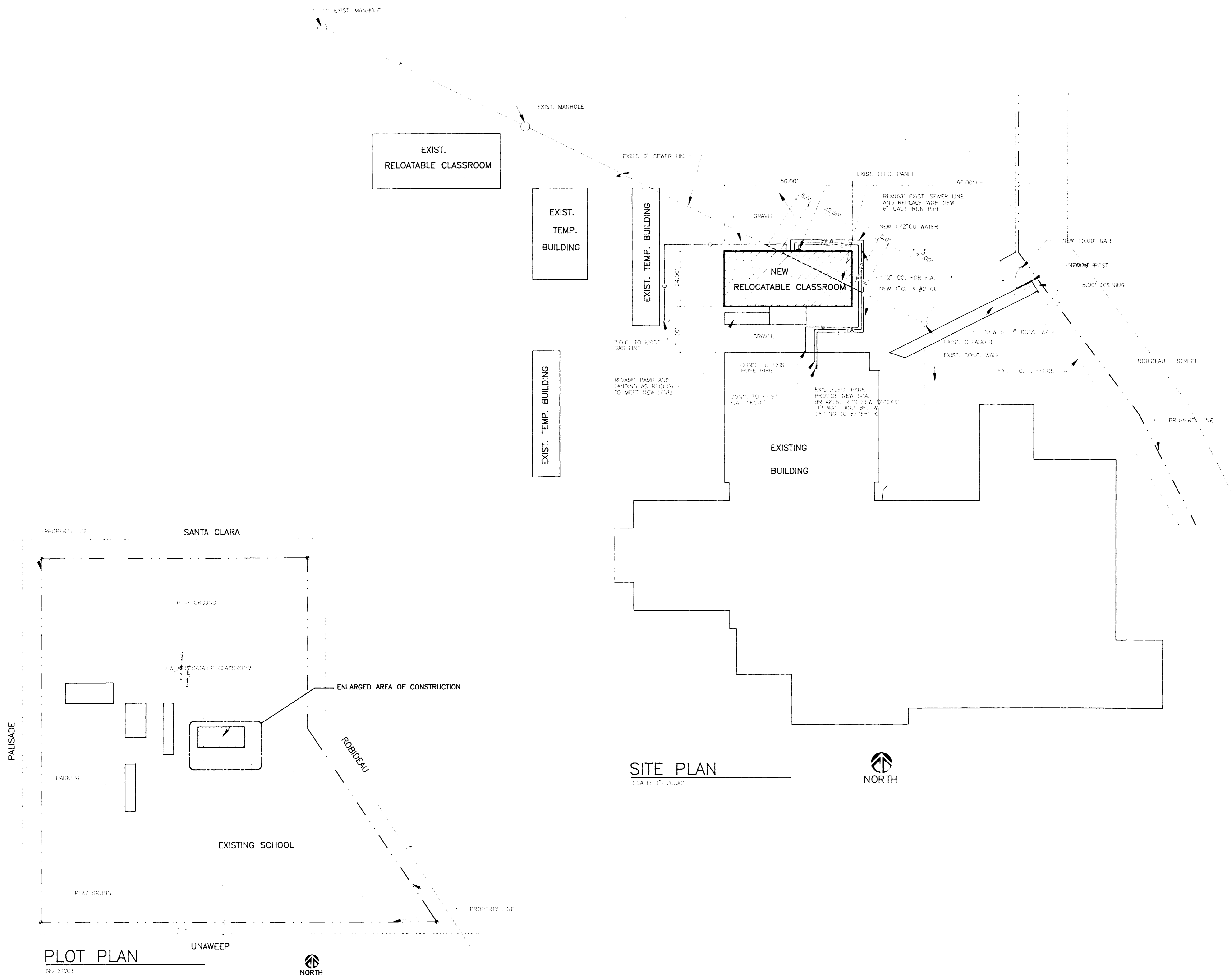

| | | |
|------------------------|--|---------------------------------------|
| | PREUSS & ASSOCIATES ARCHITECTURE • PLANNING • ENGINEERING 133 - 33 ROAD PALISADE, CO 81356 303-434-9282 | |
| | PROJECT FILE 05-015 COLORADO | SHEET TITLE SITE PLAN PLOT PLAN |
| DRAWING SP-1 | SHEET 1 OF 1 | |

| NO. | DATE | REVISIONS |
|-----|---------|--------------------|
| 1 | 8/17/05 | ISSUED FOR PERMITS |
| 2 | 8/17/05 | FOR REVIEW |
| 3 | 8/17/05 | FOR REVIEW |
| 4 | 8/17/05 | FOR REVIEW |
| 5 | 8/17/05 | FOR REVIEW |
| 6 | 8/17/05 | FOR REVIEW |
| 7 | 8/17/05 | FOR REVIEW |
| 8 | 8/17/05 | FOR REVIEW |
| 9 | 8/17/05 | FOR REVIEW |
| 10 | 8/17/05 | FOR REVIEW |