

DATE SUBMITTED 3-21-94

BUILDING PERMIT NO. 48004

FEE \$ 5.00

PLANNING CLEARANCE
(Single Family Residential and Accessory Structures)
Grand Junction Department of Community Development

BLDG ADDRESS 1250 PINYON AVE

SQ. FT. OF PROPOSED BLDG(S)/ADDITION na.

SUBDIVISION _____

SQ. FT. OF EXISTING BLDG(S) _____

FILING _____ BLK _____ LOT _____

TAX SCHEDULE NO. 2945-12200-098

NO. OF FAMILY UNITS _____

OWNER DOLORIS DEAN

NO. OF BLDGS ON PARCEL BEFORE THIS CONSTRUCTION 1

ADDRESS 1250 PINYON

DESCRIPTION OF WORK AND INTENDED USE:
Car port. C3

TELEPHONE 243-4551

REQUIRED: Two plot plans showing parking, setbacks to all property lines, and all rights-of-way which abut the parcel.

ZONE RSF-8

DESIGNATED FLOODPLAIN: YES _____ NO

SETBACKS: Front _____ from property line or _____ from center of ROW, whichever is greater

GEOLOGIC HAZARD: NO YES _____ NO

Side 3' from property line (measure from eave)

CENSUS TRACT 6 TRAFFIC ZONE 28

Rear 3' from property line

PARKING REQ'MT _____

Maximum Height _____

SPECIAL CONDITIONS: _____

Maximum coverage of lot by structures _____

Modifications to this Planning Clearance must be approved, in writing, by this Department. The structure approved by this application cannot be occupied until a final inspection has been completed by the Building Department (Section 305, Uniform Building Code).

I hereby acknowledge that I have read this application and the above is correct, and I agree to comply with the requirements above. I understand that failure to comply shall result in legal action.

Department Approval Marcia Kelly
Date Approved 3-21-94

Applicant Signature Floyd Dean
Date 3-21-94

VALID FOR SIX MONTHS FROM DATE OF ISSUANCE (Section 9-3-2D Grand Junction Zoning & Development Code)

(White: Planning)

(Yellow: Customer)

(Pink: Building Department)

Property r...

ACCEPTED MP 3-21-94
ANY CHANGE OF SETBACKS MUST BE
APPROVED BY THE CITY PLANNING
DEPT. IT IS THE APPLICANT'S
RESPONSIBILITY TO PROPERLY
LOCATE AND IDENTIFY EASEMENTS
AND PROPERTY LINES.

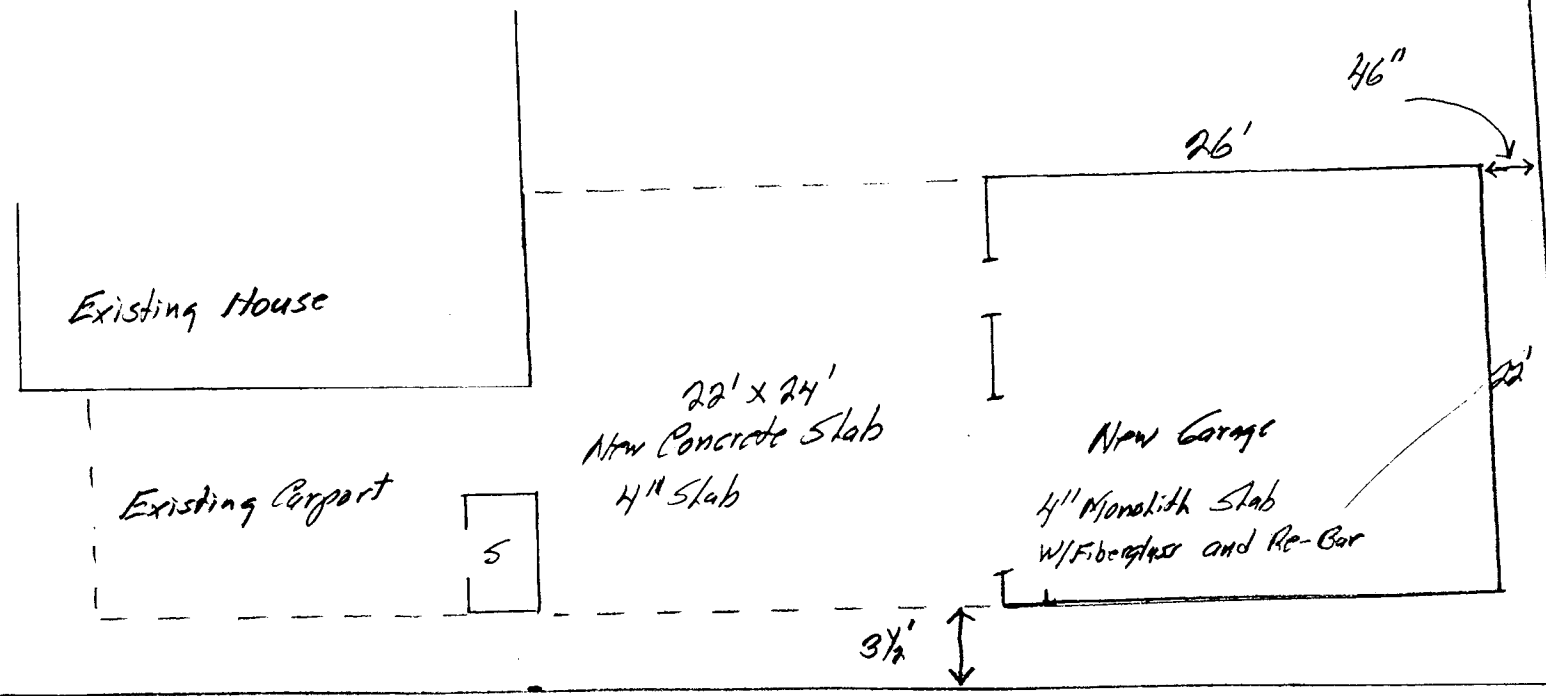

Site Plan