

FEE \$ <u>PJ W/ SPR</u>
TCP \$ <u>NA</u>
DRAINAGE FEE \$ <u>NA</u>

BLDG PERMIT NO. <u>55283</u>
FILE # <u>SPR-96-33</u>

PLANNING CLEARANCE

(site plan review, multi-family development, non-residential development)
 Grand Junction Community Development Department

THIS SECTION TO BE COMPLETED BY APPLICANT

BLDG ADDRESS <u>2848 Heritage Way</u>	TAX SCHEDULE NO. <u>2105-00³¹¹-00-941</u>
SUBDIVISION _____	SQ. FT. OF PROPOSED BLDG(S)/ADDITION <u>210'x51'</u>
FILING _____ BLK _____ LOT _____	SQ. FT. OF EXISTING BLDG(S) <u>50' x 50'</u>
(1) OWNER <u>JAMES E. FUOCO</u>	NO. OF DWELLING UNITS BEFORE: <u>N/A</u> AFTER: <u>N/A</u> CONSTRUCTION
(1) ADDRESS <u>4360 Racquet Court</u> <u>Grand Junction, CO 81506</u>	NO. OF BLDGS ON PARCEL BEFORE: <u>1</u> AFTER: <u>2</u> CONSTRUCTION
(1) TELEPHONE <u>256 0081</u>	USE OF ALL EXISTING BLDGS <u>Aircraft storage</u>
(2) APPLICANT _____	DESCRIPTION OF WORK & INTENDED USE: <u>Addition to existing building for more storage of aircraft.</u>
(2) ADDRESS _____	
(2) TELEPHONE _____	

✓ Submittal requirements are outlined in the SSID (Submittal Standards for Improvements and Development) document.

THIS SECTION TO BE COMPLETED BY COMMUNITY DEVELOPMENT DEPARTMENT STAFF

ZONE <u>PAD</u>	Landscaping / Screening Required: YES ___ NO ___
SETBACKS: Front _____ from Property Line (PL) or _____ from center of ROW, whichever is greater	Parking Req'mt _____
Side _____ from PL Rear _____ from PL	Special Conditions: _____
Maximum Height _____	
Maximum coverage of lot by structures _____	CENS.T. <u>16</u> T.ZONE <u>14</u> ANNEX # _____

Modifications to this Planning Clearance must be approved, in writing, by the Community Development Department Director. The structure authorized by this application cannot be occupied until a final inspection has been completed and a Certificate of Occupancy has been issued by the Building Department (Section 307, Uniform Building Code). Required improvements in the public right-of-way must be guaranteed prior to issuance of a Planning Clearance. All other required site improvements must be completed or guaranteed prior to issuance of a Certificate of Occupancy. Any landscaping required by this permit shall be maintained in an acceptable and healthy condition. The replacement of any vegetation materials that die or are in an unhealthy condition is required by the G.J. Zoning and Development Code.

Four (4) sets of final construction drawings must be submitted and stamped by City Engineering prior to issuing the Planning Clearance. One stamped set must be available on the job site at all times.

I hereby acknowledge that I have read this application and the information is correct; I agree to comply with any and all codes, ordinances, laws, regulations, or restrictions which apply to the project. I understand that failure to comply shall result in legal action, which may include but not necessarily be limited to non-use of the building(s).

Applicant's Signature <u>[Signature]</u>	Date <u>2/14/96</u>
Department Approval <u>[Signature]</u>	Date <u>2/23/96</u>
Additional water and/or sewer tap fee(s) are required: YES ___ NO <input checked="" type="checkbox"/> W/O No. <u>No Water/Sewer</u>	
Utility Accounting <u>[Signature]</u>	Date <u>2-26-96</u>

VALID FOR SIX MONTHS FROM DATE OF ISSUANCE (Section 9-3-2C Grand Junction Zoning & Development Code)

(White: Planning) (Yellow: Customer) (Pink: Building Department) (Goldenrod: Utility Accounting)

COMET

3-0235 — 50 SHEETS — 5 SQUARES
3-0236 — 100 SHEETS — 5 SQUARES
3-0237 — 200 SHEETS — 5 SQUARES
3-0197 — 200 SHEETS — FILLER

DEC. 7. 1995 12:18PM 970 243 4900
UNITED COMPANIES

Jim Fuoco

WINDMILL FIELD

New Hanger Project

NO. 220 P. 1

ATTEN: JIM FUOCO

$$114' \times 338' = 38,532 \times .085 = 3275.22 = 277.94$$

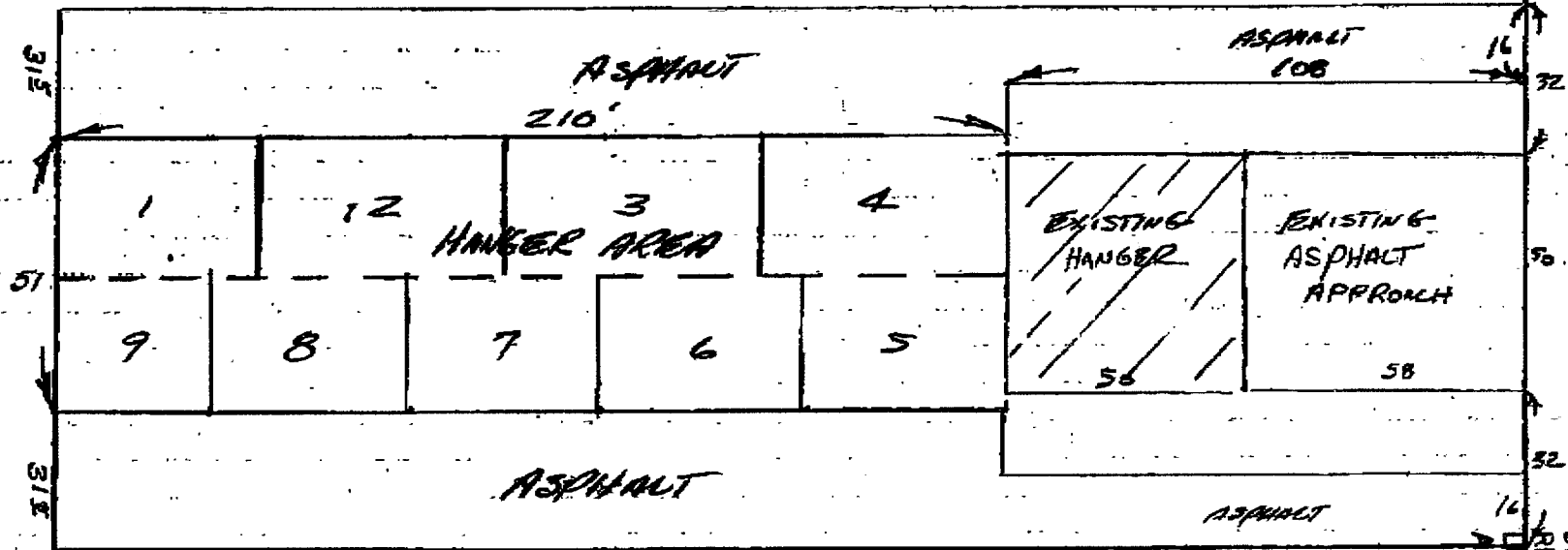

Thruway

ACCEPTED *[Signature]* 2/24/96
ANY CHANGE OF SETBACKS MUST BE APPROVED BY THE CITY PLANNING DEPT. IT IS THE APPLICANT'S RESPONSIBILITY TO PROPERLY LOCATE AND IDENTIFY EASEMENTS AND PROPERTY LINES.

Jim
IS THIS CORRECT?
FOR SCOPE OF WORK

ALSO WILL THE HANGER AREA
BE ASPHALT OR CONCRETE?

[Signature]



Robert M. Mather
Surveyor/Estimator

618 Dike Road, P.O. Box 3609
Grand Junction, CO 81502
(303) 243-4900
FAX: (303) 243-5945