

ORDINANCE NO. 1858

AN ORDINANCE ANNEXING TERRITORY TO THE CITY OF GRAND JUNCTION,
COLORADO.

WHEREAS, on the 5th day of December, 1979, the City Council of the City of Grand Junction considered a petition for the annexation of the following described property to the City of Grand Junction; and

WHEREAS, the City Council determined that said territory was eligible for annexation and that no election was necessary to determine whether such territory should be annexed as the petition was signed by the owner of one hundred percent of the territory petitioned for annexation;

NOW, THEREFORE, BE IT ORDAINED BY THE CITY COUNCIL OF THE CITY OF GRAND JUNCTION, COLORADO:

That the property situate in Mesa County, Colorado, and described to wit:

Lots 53, 54, 55 and 56 in Block 15 and the W2 of the vacated road between Blocks 15 and 16 and the road adjoining Block 15 on the north thereof; AND Beginning at the NW corner of Lot 54, thence N 30 feet, thence W 10 feet, thence S to a point 10 feet W of the SW corner of Lot 53, thence E 10 feet, thence N to point of beginning; ALL in FAIRMOUNT SUBDIVISION, according to the recorded plat thereof AND the S 1 acre of W2NW4SW4 of Section 1, T1S, R1W, Ute Meridian, EXCEPTING from the above described tracts the following:

Beginning at a point 30 feet E and 30 feet N of the SW corner of the NW4SW4SW4 Section 1, T1S, R1W, Ute Meridian, thence N 320 feet to the Drain Ditch, thence N 44° 30' E 50 feet, thence N 78° 10' E 147 feet, thence N 68° 25' E 103 feet, thence S 88° 05' E 201 feet, thence N 40° E 240 feet, more or less to a point 30 feet E of the NE corner of Lot 55 of Block 15 of FAIRMOUNT SUBDIVISION, thence S 600 feet to a point 30 feet E of the SE corner of Lot 56 of Block 15 of FAIRMOUNT SUBDIVISION, thence W 630 feet to the point of beginning.

ALSO road right of way for 12th Street on the West,

be, and the same is hereby, annexed to the City of Grand Junction, Colorado.

PASSED and ADOPTED this 19 day of December, 1979.

Jane S. Quimby

President of the Council

Attest:

Neva B. Lockhart, CMC

City Clerk

I HEREBY CERTIFY that the foregoing ordinance, being Ordinance No. 1858, was introduced, read, and ordered published by the City Council of the City of Grand Junction, Colorado, at a regular meeting of said body held on the 5th day of December, 1979, and that the same was published in the Daily Sentinel, a newspaper published and in general circulation in said City, at least ten days before its final passage.

IN WITNESS WHEREOF, I have hereunto set my hand and affixed the official seal of said City this 20 day of December, 1979.

Neva B. Lockhart, CMC

Neva B. Lockhart, CMC
City Clerk

Published: December 7, 1979

Published: December 21, 1979

Effective: January 20, 1980

HETLAND ANNEXATION

DESCRIPTION

Part of the Southwest Quarter (S.W. 1/4) of Section 1, Township 1 South, Range 1 West, Ute Meridian. More particularly described as follows:
 Lots 53, 54, 55, and 56 in Block 15 and the W 1/2 of the vacated road between Blocks 15 and 16 and the road adjoining Block 15 on the North thereof; and beginning at the Northwest corner of Lot 54, thence North 30 feet, thence West 10 feet, thence South to a point 10 feet West of the Southwest corner of Lot 53, thence East 10 feet, thence North to the point of beginning; all in Fairmount Subdivision, according to the recorded plat thereof; and the South 1 acre of the West Half of the Northwest quarter of the Southwest quarter (W 1/2, N.W. 1/4, S.W. 1/4) of Section 1, Township 1 South, Range 1 West, Ute Meridian; Excepting from the above described tracts the following:
 Beginning at a point 30 feet East and 30 feet North of the Southwest corner (S.W. cor.) of the Northwest quarter of the Southwest quarter of the Southwest quarter (N.W. 1/4, S.W. 1/4, S.W. 1/4,) Section 1, Township 1 South, Range 1 West, Ute Meridian, thence North 320 feet to the Drain Ditch, thence North 44° 30' East 10 feet, thence North 78° 10' East 147 feet, thence North 68° 25' East 103 feet, thence South 88° 05' East 201 feet, thence North 40° 00' East 240 feet more or less to a point 30 feet East of the Northeast corner of Lot 55 of Block 15 of Fairmount Subdivision, thence South 600 feet to a point 30 feet East of the Southeast corner of Lot 56 of Block 15 of Fairmount Subdivision, thence West 630 feet to the point of beginning.
 Also road right-of-way for 12th Street on the West.

LEGEND

Boundary of existing corporate limits
 Boundary of new corporate limits

AREA OF ANNEXATION

Boundary contiguous to existing corporate limits approx. 1200 ft.
 Perimeter of area to be annexed approx. 1960 ft.
 Total annexed area in acres approx. 5

ENGINEER'S CERTIFICATE

I, Ronald P. Rish, City Engineer, do hereby certify that the accompanying plat and description of Hetland Annexation was compiled under my direct supervision from existing public records.

1858
ORDINANCE NO.

1-20-80
EFFECTIVE DATE

Ronald P. Rish
RONALD P. RISH, P.E.

1-7-80
DATE

DEPARTMENT OF PUBLIC WORKS ENGINEERING DIVISION CITY OF GRAND JUNCTION, COLORADO			
HETLAND ANNEXATION			
DRAWN BY: <i>D. Bowman</i> DATE: <i>12-2-81</i>	HORIZONTAL SCALE: <i>1"=50'</i>	VERTICAL SCALE:	SHEET:
CHECKED BY:	FIELD BOOK NO:	DATE:	SHEET:
APPROVED BY:	DATE:	SHEET:	SHEET:

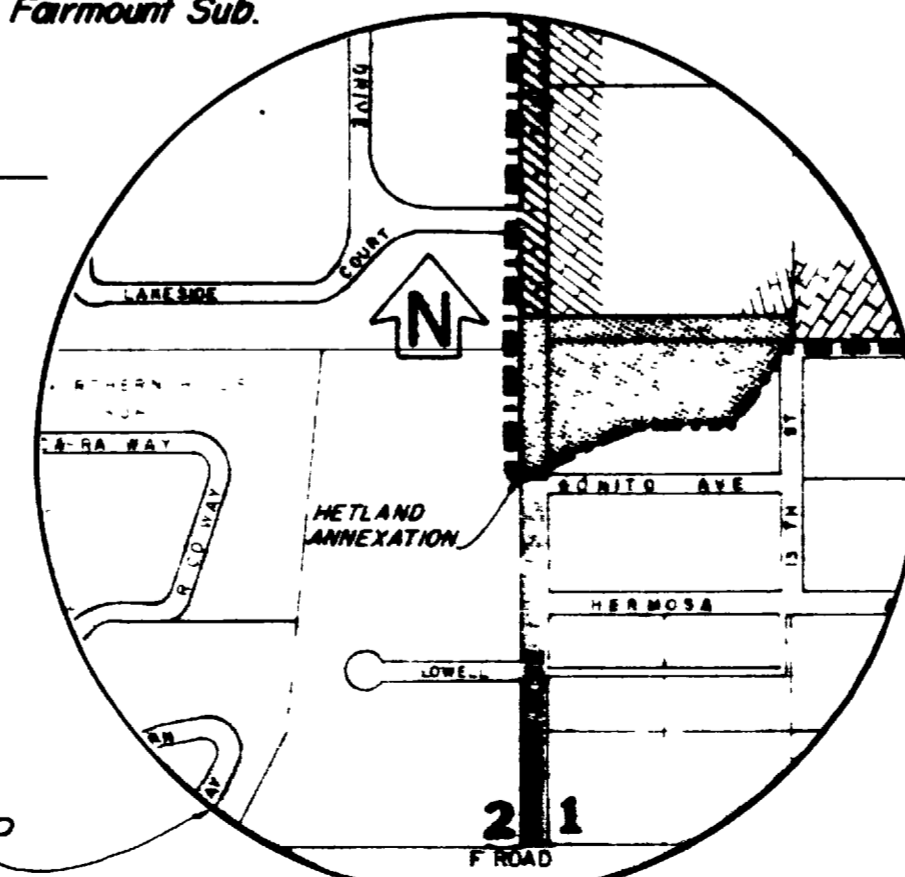

LOCATION MAP

