

Planning \$ <u>Pd w/PR/SPR</u>	Drainage \$ <u>0</u>
TCP \$ <u>0</u>	School Impact \$ <u>0</u>

E4

BLDG PERMIT NO. <u>72535</u>
FILE # <u>RR-1999-200</u>

PLANNING CLEARANCE

(site plan review, multi-family development, non-residential development)

Grand Junction Community Development Department

THIS SECTION TO BE COMPLETED BY APPLICANT

BUILDING ADDRESS <u>736 24-1/2 Road</u>	TAX SCHEDULE NO. <u>2701-334-00-03</u>
SUBDIVISION <u>Pomona Park</u>	SQ. FT. OF PROPOSED BLDG(S)/ADDITION <u>39,990 + 7,475</u>
FILING _____ BLK _____ LOTS <u>26 & 35</u>	SQ. FT OF EXISTING BLDG(S) <u>None</u>
OWNER <u>Vineyard Christian Fellowship</u>	NO. OF DWELLING UNITS: BEFORE <u>0</u> AFTER <u>0</u> CONSTRUCTION
ADDRESS <u>2791 North Avenue, G.J. 81504</u>	NO. OF BLDGS ON PARCEL: BEFORE <u>0</u> AFTER <u>2</u> CONSTRUCTION
TELEPHONE <u>(970) 242-7970</u>	USE OF ALL EXISTING BLDGS <u>Church & related</u>
APPLICANT <u>Development Construction Services, Inc. Jana B. Gerow</u>	DESCRIPTION OF WORK & INTENDED USE: <u>Develop</u>
ADDRESS <u>640 Belford Ave., G.J. 81501</u>	<u>parking lot and build church facilities.</u>
TELEPHONE <u>(970) 242-3674</u>	

✓ **Submittal requirements are outlined in the SSID (Submittal Standards for Improvements and Development) document.**

THIS SECTION TO BE COMPLETED BY COMMUNITY DEVELOPMENT DEPARTMENT STAFF

ZONE <u>RSF-12</u>	LANDSCAPING/SCREENING REQUIRED: YES <input checked="" type="checkbox"/> NO _____
SETBACKS: FRONT: <u>600</u> from Property Line (PL) or from center of ROW, whichever is greater	PARKING REQUIREMENT: <u>500 spaces</u>
SIDE: <u>50</u> from PL REAR: <u>50</u> from PL	SPECIAL CONDITIONS: _____
MAXIMUM HEIGHT <u>32'</u>	
MAXIMUM COVERAGE OF LOT BY STRUCTURES <u>25%</u>	CENSUS TRACT <u>9</u> TRAFFIC ZONE <u>5</u> ANNEX _____

Modifications to this Planning Clearance must be approved, in writing, by the Community Development Department Director. The structure authorized by this application cannot be occupied until a final inspection has been completed and a Certificate of Occupancy has been issued by the Building Department (Section 307, Uniform Building Code). Required improvements in the public right-of-way must be guaranteed prior to issuance of a Planning Clearance. All other required site improvements must be completed or guaranteed prior to issuance of a Certificate of Occupancy. Any landscaping required by this permit shall be maintained in an acceptable and healthy condition. The replacement of any vegetation materials that die or are in an unhealthy condition is required by the Grand Junction Zoning and Development Code.

Four (4) sets of final construction drawings must be submitted and stamped by City Engineering prior to issuing the Planning Clearance. One stamped set must be available on the job site at all times.

I hereby acknowledge that I have read this application and the information is correct; I agree to comply with any and all codes, ordinances, laws, regulations, or restrictions which apply to the project. I understand that failure to comply shall result in legal action, which may include but not necessarily be limited to non-use of the building(s).

Applicant's Signature <u>Jana B Gerow</u>	Date <u>8/16/99</u>
Department Approval <u>J. Gerstenberger</u>	Date <u>10-15-99</u>

Additional water and/or sewer tap fee(s) are required:	YES <input checked="" type="checkbox"/>	NO _____	W/O No. <u>12639</u>
Utility Accounting <u>T. Bensley</u>	Date <u>11/5/99</u>		

VALID FOR SIX MONTHS FROM DATE OF ISSUANCE (Section 9-3-2C Grand Junction Zoning and Development Code)

(White: Planning) (Yellow: Customer) (Pink: Building Department) (Goldenrod: Utility Accounting)

N 89° 53' 00" W 350.34'

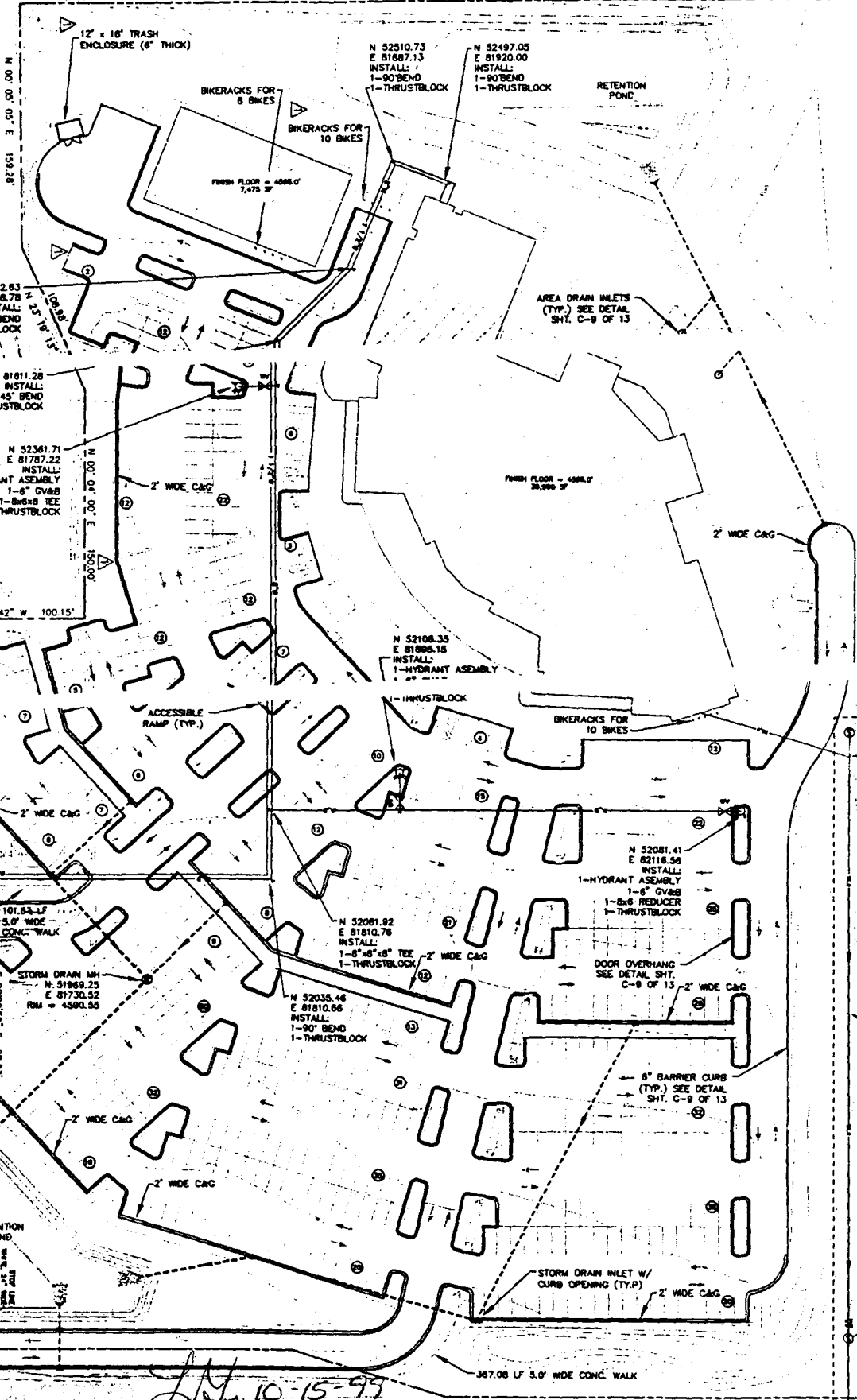

N 52442.63
E 81656.78
INSTALL:
1-22 1/2" BEND
1-THRUSTBLOCK

E 81811.28
INSTALL:
1-45" BEND
1-THRUSTBLOCK

N 52341.71
E 81787.22
INSTALL:
1-HYDRANT ASSEMBLY
1-8" GVA8B
1-8" REDUCER
1-THRUSTBLOCK

N 52510.73
E 81887.13
INSTALL:
1-90° BEND
1-THRUSTBLOCK

N 52497.05
E 81920.00
INSTALL:
1-90° BEND
1-THRUSTBLOCK

AREA DRAIN INLETS
(TYP.) SEE DETAIL
SHT. C-9 OF 13

N 52106.35
E 81895.15
INSTALL:
1-HYDRANT ASSEMBLY
1-THRUSTBLOCK

N 52081.41
E 82116.58
INSTALL:
1-HYDRANT ASSEMBLY
1-8" GVA8B
1-8" REDUCER
1-THRUSTBLOCK

N 52081.92
E 81810.78
INSTALL:
1-8" x 8" x 8" TEE
1-THRUSTBLOCK

N 52035.48
E 81810.66
INSTALL:
1-90° BEND
1-THRUSTBLOCK

DOOR OVERHANG
SEE DETAIL SHT.
C-9 OF 13

8" BARRIER CURB
(TYP.) SEE DETAIL
SHT. C-9 OF 13

STORM DRAIN INLET W/
CURB OPENING (TYP.)

N 89° 53' 42" W 100.15'

N 53072.22 E 12.54'
N 53072.22 E 12.54'
N 53072.22 E 12.54'
N 53072.22 E 12.54'

101.64 LF
5.0' WIDE
CONC. WALK

STORM DRAIN INLET
N 51969.25
E 81730.52
RM = 4590.55

DETENTION POND
N 54070.27 E 48.32'
S 00702.96 E 20.21'
S 00702.96 E 20.21'

S 00702.96 E 48.32'
S 00702.96 E 48.32'
S 00702.96 E 48.32'

PLANTING STREET TREES

N 52132.84
PROPOSED SS MH A-4
RM = 4593.00
INV. = 4595.00
10014 LF 6" PVC
SEWER SERVICE @ 1.0% MIN.

399.00 LF 6" PVC
SR-35 @ 0.35%

N 51734.84
PROPOSED SS MH A-3
RM = 4599.96
INV. = 4592.81
INV. 001-S = 4592.81

NORTH VALLEY
SUBDIVISION
(199-A)

J.Y. 10-15-99

1/2 ROAD

1/2 ROAD

S 00702.96 E 20.21'