

Planning \$ <u>10⁰⁰</u>	Drainage \$ <u>—</u>
TCP \$ <u>—</u>	School Impact \$ <u>—</u>

BLDG PERMIT NO. <u>71388</u> - foundation
FILE # <u>#71142</u> - canopy

PLANNING CLEARANCE

(site plan review, multi-family development, non-residential development)
Grand Junction Community Development Department

EX

THIS SECTION TO BE COMPLETED BY APPLICANT

BUILDING ADDRESS 702 Main St.
 SUBDIVISION City
 FILING — BLK 106 LOT 1-4

TAX SCHEDULE NO. 2945-144-17-001
 SQ. FT. OF PROPOSED BLDG(S)/ADDITION 0
 SQ. FT. OF EXISTING BLDG(S) —

OWNER DAVE & JAN JOHNSON
 ADDRESS 702 Main St
 TELEPHONE 292-3018

NO. OF DWELLING UNITS: BEFORE — AFTER —
 CONSTRUCTION
 NO. OF BLDGS ON PARCEL: BEFORE 1 AFTER 1
 CONSTRUCTION
 USE OF ALL EXISTING BLDGS Service station

APPLICANT Same
 ADDRESS Same
 TELEPHONE Same

DESCRIPTION OF WORK & INTENDED USE:
replace existing pumps, add canopy over pumps delete one set of pumps.

✓ Submittal requirements are outlined in the SSID (Submittal Standards for Improvements and Development) document.

THIS SECTION TO BE COMPLETED BY COMMUNITY DEVELOPMENT DEPARTMENT STAFF

ZONE B-3
 SETBACKS: FRONT: 0' from Property Line (PL) or 35' from center of ROW, whichever is greater
 SIDE: 0' from PL REAR: 0' from PL
 MAXIMUM HEIGHT 40'
 MAXIMUM COVERAGE OF LOT BY STRUCTURES —

LANDSCAPING/SCREENING REQUIRED: YES NO
 PARKING REQUIREMENT: —
 SPECIAL CONDITIONS: new pumps to be placed in current location.
 CENSUS TRACT 2 TRAFFIC ZONE 41 ANNEX —

Modifications to this Planning Clearance must be approved, in writing, by the Community Development Department Director. The structure authorized by this application cannot be occupied until a final inspection has been completed and a Certificate of Occupancy has been issued by the Building Department (Section 307, Uniform Building Code). Required improvements in the public right-of-way must be guaranteed prior to issuance of a Planning Clearance. All other required site improvements must be completed or guaranteed prior to issuance of a Certificate of Occupancy. Any landscaping required by this permit shall be maintained in an acceptable and healthy condition. The replacement of any vegetation materials that die or are in an unhealthy condition is required by the Grand Junction Zoning and Development Code.

Four (4) sets of final construction drawings must be submitted and stamped by City Engineering prior to issuing the Planning Clearance. One stamped set must be available on the job site at all times.

I hereby acknowledge that I have read this application and the information is correct; I agree to comply with any and all codes, ordinances, laws, regulations, or restrictions which apply to the project. I understand that failure to comply shall result in legal action, which may include but not necessarily be limited to non-use of the building(s).

Applicant's Signature Janet Lee Johnson Date 7/8/99
 Department Approval Ronny Edwards Date 7/8/99

Additional water and/or sewer tap fee(s) are required:	YES <input type="checkbox"/>	NO <input checked="" type="checkbox"/>	W/O No. <u>—</u>
Utility Accounting <u>Debi Overholt</u>			Date <u>7/8/99</u>

VALID FOR SIX MONTHS FROM DATE OF ISSUANCE (Section 9-3-2C Grand Junction Zoning and Development Code)

(White: Planning) (Yellow: Customer) (Pink: Building Department) (Goldenrod: Utility Accounting)

702 Main St.

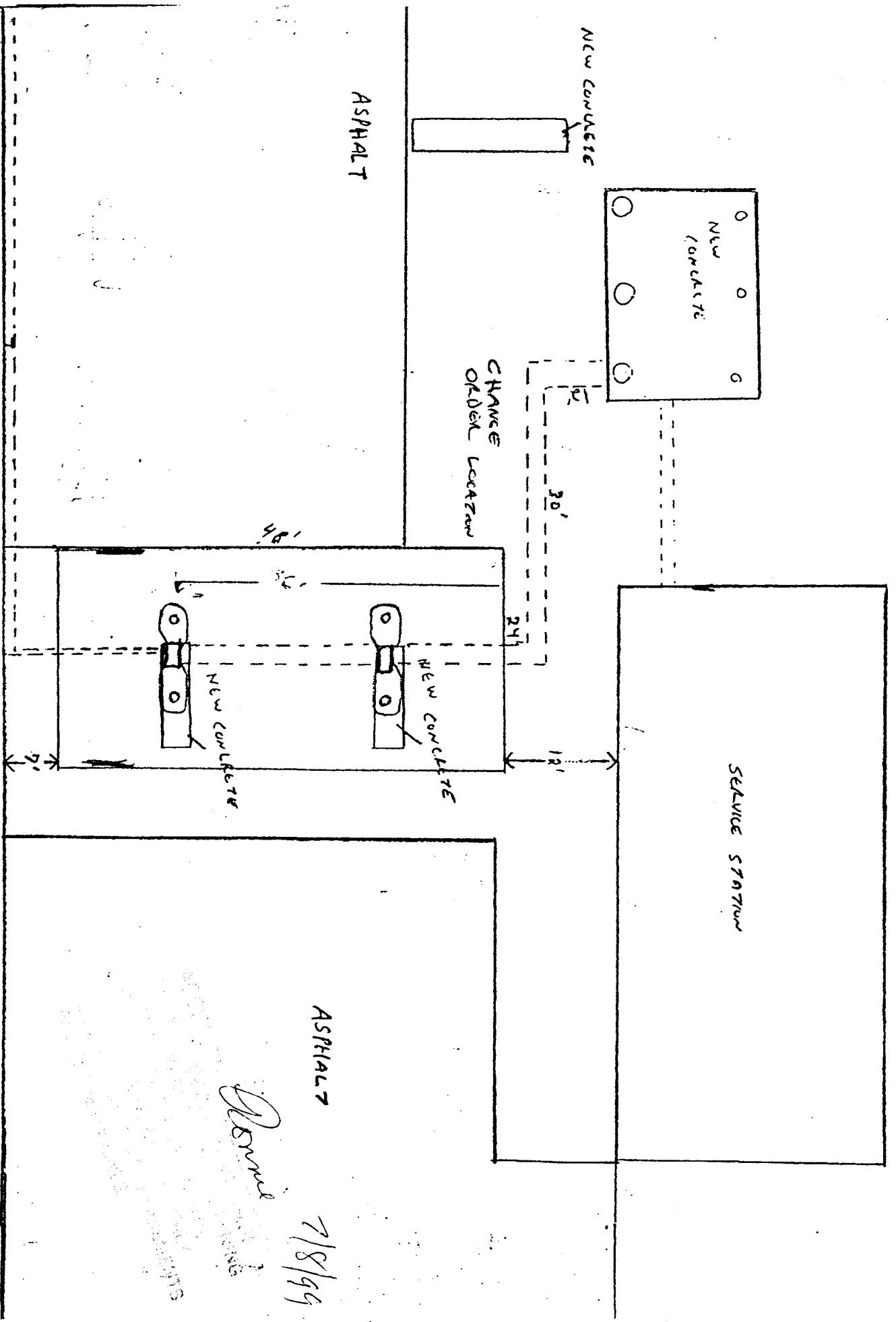

ASPHALT
Demond
7/8/99