

Planning \$ <u>10.00</u>	Drainage \$ <u>0</u>
TCP \$ <u>0</u>	School Impact \$ <u>0</u>

BLDG PERMIT NO. <u>76617</u>
FILE #

PLANNING CLEARANCE

(site plan review, multi-family development, non-residential development)
Grand Junction Community Development Department

THIS SECTION TO BE COMPLETED BY APPLICANT

BUILDING ADDRESS 596 25 Rd
 SUBDIVISION NW
 FILING _____ BLK _____ LOT 120
 OWNER C&P Food Store
 ADDRESS 1649 Main
 TELEPHONE 970-245-0392
 APPLICANT Independent Pump Co
 ADDRESS 948 3rd Ave
 TELEPHONE 970-242-5433

TAX SCHEDULE NO. 2945-102-00-120
 SQ. FT. OF PROPOSED BLDG(S)/ADDITION 2700
 SQ. FT. OF EXISTING BLDG(S) _____
 NO. OF DWELLING UNITS: BEFORE _____ AFTER _____
 CONSTRUCTION
 NO. OF BLDGS ON PARCEL: BEFORE _____ AFTER _____
 CONSTRUCTION
 USE OF ALL EXISTING BLDGS _____
 DESCRIPTION OF WORK & INTENDED USE: Replace Canopy above Fueling islands

✓ Submittal requirements are outlined in the SSID (Submittal Standards for Improvements and Development) document.

THIS SECTION TO BE COMPLETED BY COMMUNITY DEVELOPMENT DEPARTMENT STAFF

ZONE C-1
 SETBACKS: FRONT: 15' from Property Line (PL) or
 from center of ROW, whichever is greater
 SIDE: 0' from PL REAR: 10' from PL
 MAXIMUM HEIGHT 40'
 MAXIMUM COVERAGE OF LOT BY STRUCTURES _____

LANDSCAPING/SCREENING REQUIRED: YES _____ NO _____
 PARKING REQUIREMENT: _____
 SPECIAL CONDITIONS: _____
 CENSUS TRACT 4 TRAFFIC ZONE 10 ANNEX _____

Modifications to this Planning Clearance must be approved, in writing, by the Community Development Department Director. The structure authorized by this application cannot be occupied until a final inspection has been completed and a Certificate of Occupancy has been issued by the Building Department (Section 307, Uniform Building Code). Required improvements in the public right-of-way must be guaranteed prior to issuance of a Planning Clearance. All other required site improvements must be completed or guaranteed prior to issuance of a Certificate of Occupancy. Any landscaping required by this permit shall be maintained in an acceptable and healthy condition. The replacement of any vegetation materials that die or are in an unhealthy condition is required by the Grand Junction Zoning and Development Code.

Four (4) sets of final construction drawings must be submitted and stamped by City Engineering prior to issuing the Planning Clearance. One stamped set must be available on the job site at all times.

I hereby acknowledge that I have read this application and the information is correct; I agree to comply with any and all codes, ordinances, laws, regulations, or restrictions which apply to the project. I understand that failure to comply shall result in legal action, which may include but not necessarily be limited to non-use of the building(s).

Applicant's Signature _____
 Department Approval C. Faye Gibson

Date 9/1/00
 Date 9/1/00

Additional water and/or sewer tap fee(s) are required:	YES	NO <u>0</u>	W/O No. _____
Utility Accounting <u>D. Deubert</u>			Date <u>9-1-00</u>

VALID FOR SIX MONTHS FROM DATE OF ISSUANCE (Section 9-3-2C Grand Junction Zoning and Development Code)

(White: Planning) (Yellow: Customer) (Pink: Building Department) (Goldenrod: Utility Accounting)

IN THE SPACE BELOW PLEASE NEATLY DRAW A SITE PLAN SHOWING THE FOLLOWING:

- 1 - An outline of the PROPERTY LINES with dimensions.
- 2 - An outline of the PROPOSED STRUCTURE with its dimensions.
- 3 - The DISTANCE from existing and/or proposed structure(s) to the front, rear and side property lines.
- 4 - All EASEMENTS or RIGHTS - OF - WAY on the property
- 5 - All other STRUCTURES on the property.
- 6 - All STREETS and ALLEYS adjacent to the property and street names.
- 7 - All existing and proposed DRIVEWAYS.
- 8 - An arrow indicating North.

FAILURE TO PROVIDE COMPLETE INFORMATION MAY RESULT IN A DELAY IN ISSUANCE OF A PLANNING CLEARANCE.

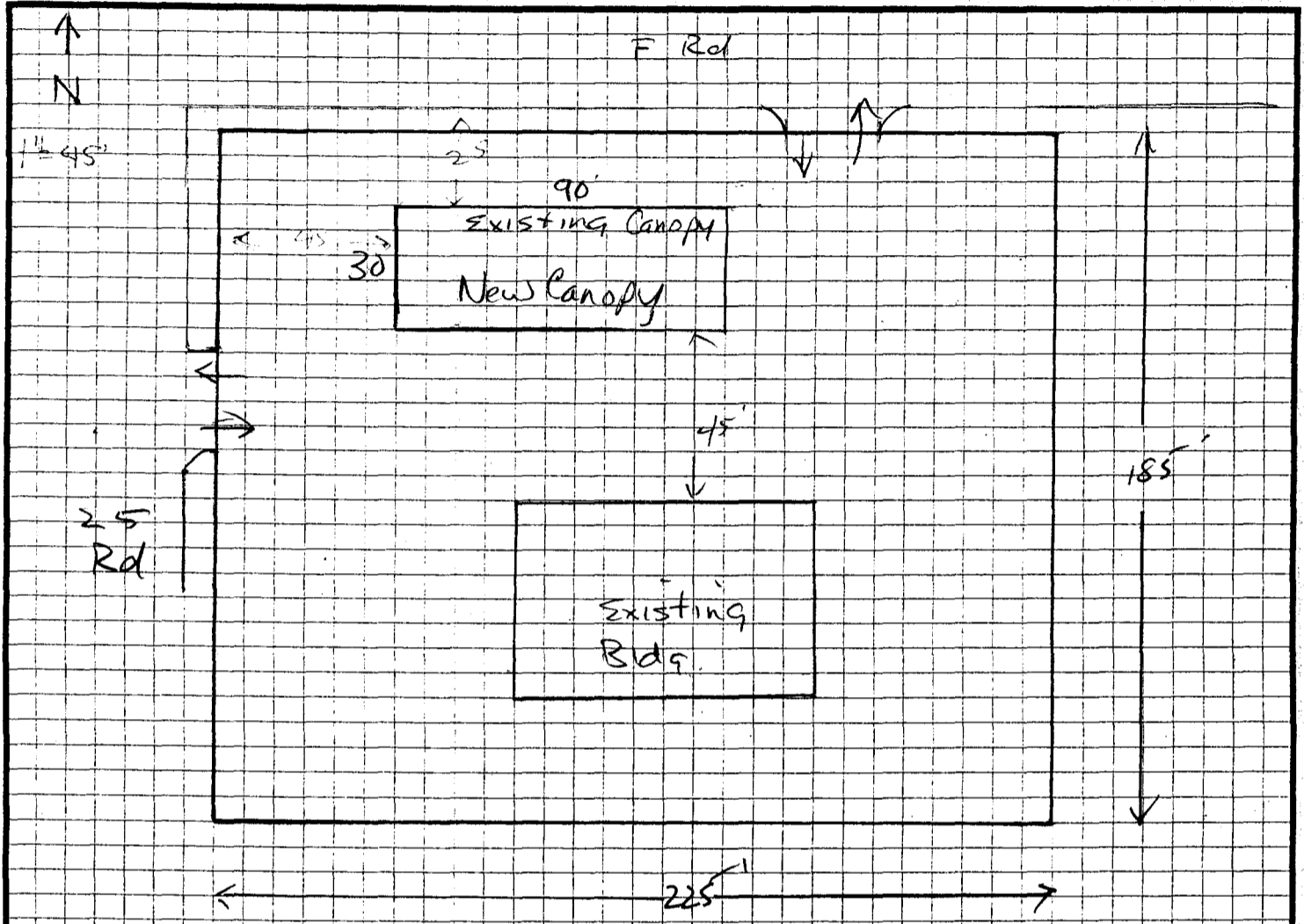

9/1/00 Replacing Canopy @ Islands

ACCEPTED
 ANY CHANGE OF SETBACKS MUST BE APPROVED BY THE CITY PLANNING DEPT. IT IS THE APPLICANT'S RESPONSIBILITY TO PROPERLY LOCATE AND IDENTIFY EASEMENTS AND PROPERTY LINES.

Clare Johnson - F Food Store # 4
 596 25 Rd
 Grand Jet