

Planning \$ <u>10<sup>00</sup></u>	Drainage \$ <u>—</u>
TCP \$ <u>—</u>	School Impact \$ <u>—</u>



BLDG PERMIT NO. <u>78516</u>
FILE #

## PLANNING CLEARANCE

(site plan review, multi-family development, non-residential development)  
**Grand Junction Community Development Department**

THIS SECTION TO BE COMPLETED BY APPLICANT

**BUILDING ADDRESS** 202 ~~4TH~~ <sup>Fourth</sup> AVE      **TAX SCHEDULE NO.** 2945-232-04-001

**SUBDIVISION** D & R G W Railroad Sub E1#1      **SQ. FT. OF PROPOSED BLDG(S)/ADDITION** NA

**FILING** —      **BLK** —      **LOT** 1      **SQ. FT OF EXISTING BLDG(S)** N/A

**OWNER** KOCK      **NO. OF DWELLING UNITS: BEFORE** 0      **AFTER** 0  
**CONSTRUCTION**

**ADDRESS** 202 4TH AVE      **NO. OF BLDGS ON PARCEL: BEFORE** 2      **AFTER** 2  
**CONSTRUCTION**

**TELEPHONE** 241-1135      **USE OF ALL EXISTING BLDGS** Asphalt Plant

**APPLICANT** Jim Cox      **DESCRIPTION OF WORK & INTENDED USE:** Retaining Wall

**ADDRESS** 1135 24 RD.

**TELEPHONE** 242-4664

*Submittal requirements are outlined in the SSID (Submittal Standards for Improvements and Development) document.*

THIS SECTION TO BE COMPLETED BY COMMUNITY DEVELOPMENT DEPARTMENT STAFF

**ZONE** I-2      **LANDSCAPING/SCREENING REQUIRED:** YES — NO X

**SETBACKS: FRONT:** 25' 15" from Property Line (PL) or from center of ROW, whichever is greater

**SIDE:** 0 from PL      **REAR:** 10' from PL

**PARKING REQUIREMENT:** —

**SPECIAL CONDITIONS:** —

**MAXIMUM HEIGHT** 20'

**MAXIMUM COVERAGE OF LOT BY STRUCTURES** —      **CENSUS TRACT** 9      **TRAFFIC ZONE** 101      **ANNX** —

Modifications to this Planning Clearance must be approved, in writing, by the Community Development Department Director. The structure authorized by this application cannot be occupied until a final inspection has been completed and a Certificate of Occupancy has been issued by the Building Department (Section 307, Uniform Building Code). Required improvements in the public right-of-way must be guaranteed prior to issuance of a Planning Clearance. All other required site improvements must be completed or guaranteed prior to issuance of a Certificate of Occupancy. Any landscaping required by this permit shall be maintained in an acceptable and healthy condition. The replacement of any vegetation materials that die or are in an unhealthy condition is required by the Grand Junction Zoning and Development Code.

Four (4) sets of final construction drawings must be submitted and stamped by City Engineering prior to issuing the Planning Clearance. One stamped set must be available on the job site at all times.

I hereby acknowledge that I have read this application and the information is correct; I agree to comply with any and all codes, ordinances, laws, regulations, or restrictions which apply to the project. I understand that failure to comply shall result in legal action, which may include but not necessarily be limited to non-use of the building(s).

**Applicant's Signature** [Signature]      **Date** —

**Department Approval** [Signature: Steve J. Costello]      **Date** 1/30/01

Additional water and/or sewer tap fee(s) are required:	YES	NO <input checked="" type="checkbox"/>	W/O No. <u>Existing 958-194</u>
Utility Accounting <u>[Signature]</u>			Date <u>1/30/01</u>

**VALID FOR SIX MONTHS FROM DATE OF ISSUANCE (Section 9-3-2C Grand Junction Zoning and Development Code)**

(White: Planning)      (Yellow: Customer)      (Pink: Building Department)      (Goldenrod: Utility Accounting)

ACCEPTED *SLE V30/01*  
ANY CHANGE OF SETBACKS MUST BE  
APPROVED BY THE CITY PLANNING  
DEPT. IT IS THE APPLICANT'S  
RESPONSIBILITY TO PROPERLY  
LOCATE AND IDENTIFY EASEMENTS  
AND PROPERTY LINES.

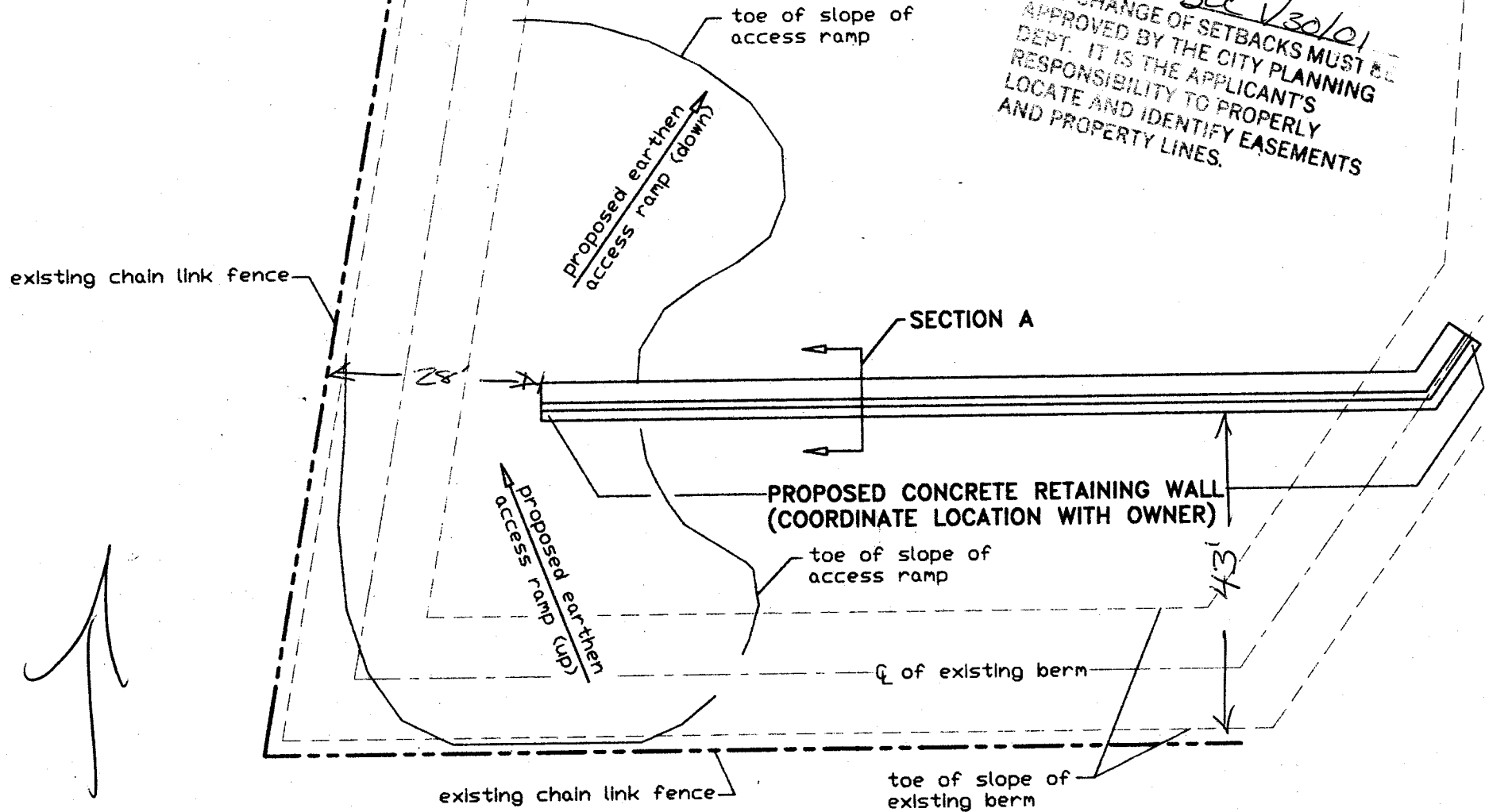

*N*

*4th Ave*

Tank Farm Containment Facility  
Scale: 1" = 20'

ACCEPTED *Bonne* 2/20/01  
ANY CHANGE OF SETBACKS OR  
APPROVED BY THE CITY PLANNING  
DEPT. IT IS THE APPLICANT'S  
RESPONSIBILITY TO PROPERLY  
LOCATE AND IDENTIFY EASEMENTS  
AND PROPERTY LINES.  
*Revised location  
okay*

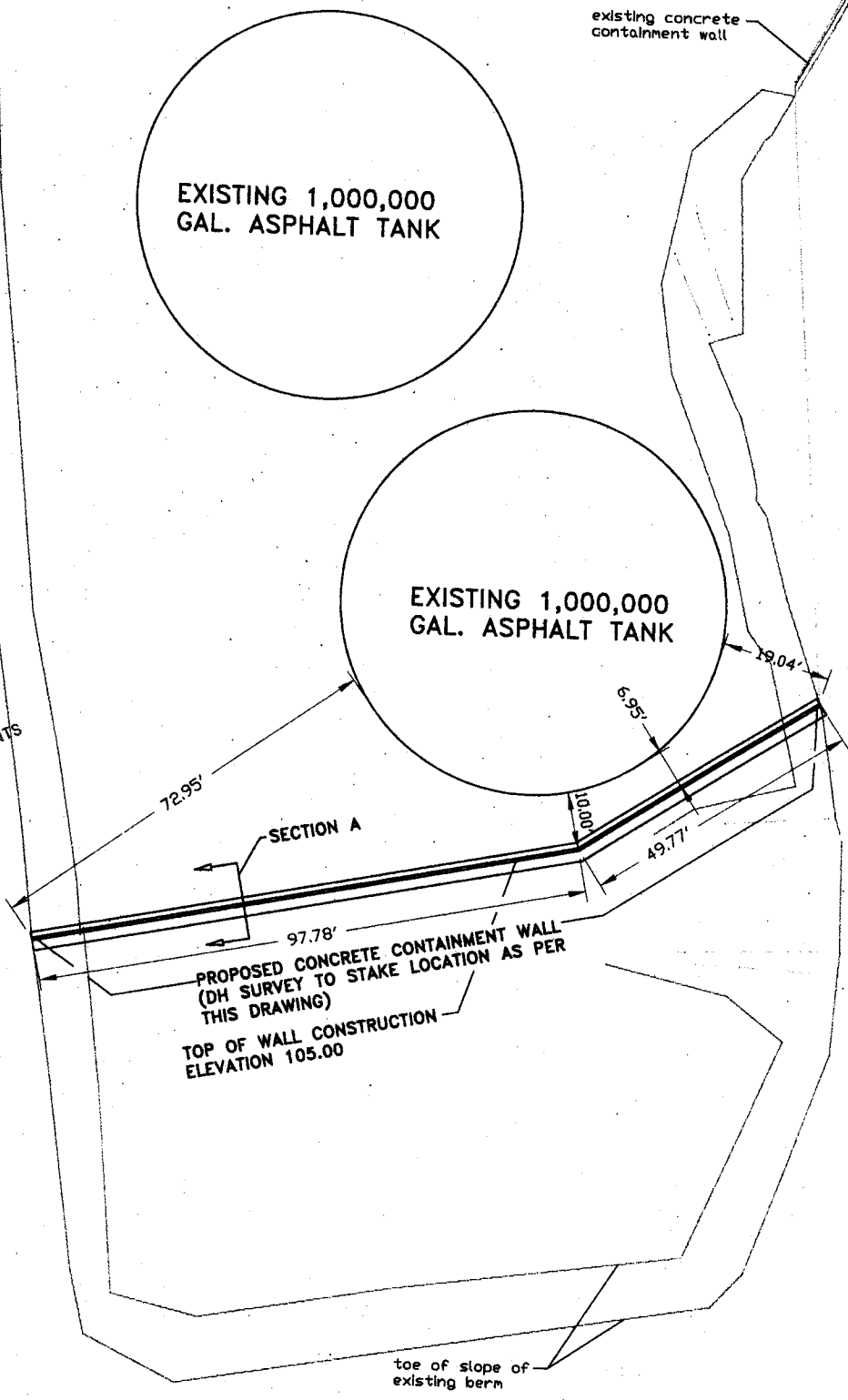

**Tank Farm Containment Facility**  
Scale: 1" = 20'