

ORDINANCE NO. 2118

AN ORDINANCE ANNEXING TERRITORY TO THE
CITY OF GRAND JUNCTION, COLORADO.

WHEREAS, on the 6th day of April, 1983, the City Council of the City of Grand Junction considered a petition for the annexation of the following described territory to the City of Grand Junction; and

WHEREAS, the City Council determined that said territory was eligible for annexation and that no election was necessary to determine whether such territory should be annexed as the petition was signed by the owner of one hundred percent of the territory petitioned for annexation;

NOW, THEREFORE, BE IT ORDAINED BY THE CITY COUNCIL OF THE CITY OF GRAND JUNCTION, COLORADO:

That the property situate in Mesa County, Colorado, and described to wit:

All Denver & Rio Grande Western Railroad right of way in Section 9, Township 1 South, Range 1 West, Ute Meridian; also all right of way for U.S. Highway 6 & 50 in the West Half of said Section 9;

be and the same is hereby annexed to the City of Grand Junction, Colorado.

PASSED and ADOPTED this 20 day of April, 1983.

Attest:

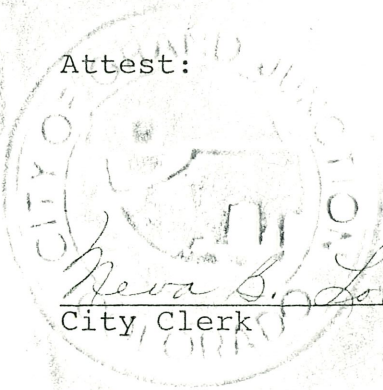

Neva B. Lockhart, CMC
City Clerk

Effective: May 22, 1983

151 Louis R. BRACH
President of the Council

CERTIFIED A TRUE COPY

Neva B. Lockhart, CMC
City Clerk

May 6, 1983

Date

Page No. 57 Book No. 11

NW Corner
Section 9

NE Corner
Section 9

Section Line

Section Line

RIVER ROAD ANNEXATION



DESCRIPTION

All Denver & Rio Grand Western Railroad right of way in Section 9, Township 1 South, Range 1 West of the Ute Meridian, Mesa County, Colorado; also all right of way for U.S. Highway 6 & 50 in the West one half of said Section 9.

LEGEND

Boundary of existing corporate limits -----
Boundary of new corporate limits _____

AREA OF ANNEXATION

Boundary contiguous to existing corporate limits 4,040 feet, more or less
Perimeter of area to be annexed 14,370 feet, more or less
Total annexed area in acres 32, more or less

2118
ORDINANCE NO.

5/22/83
EFFECTIVE DATE

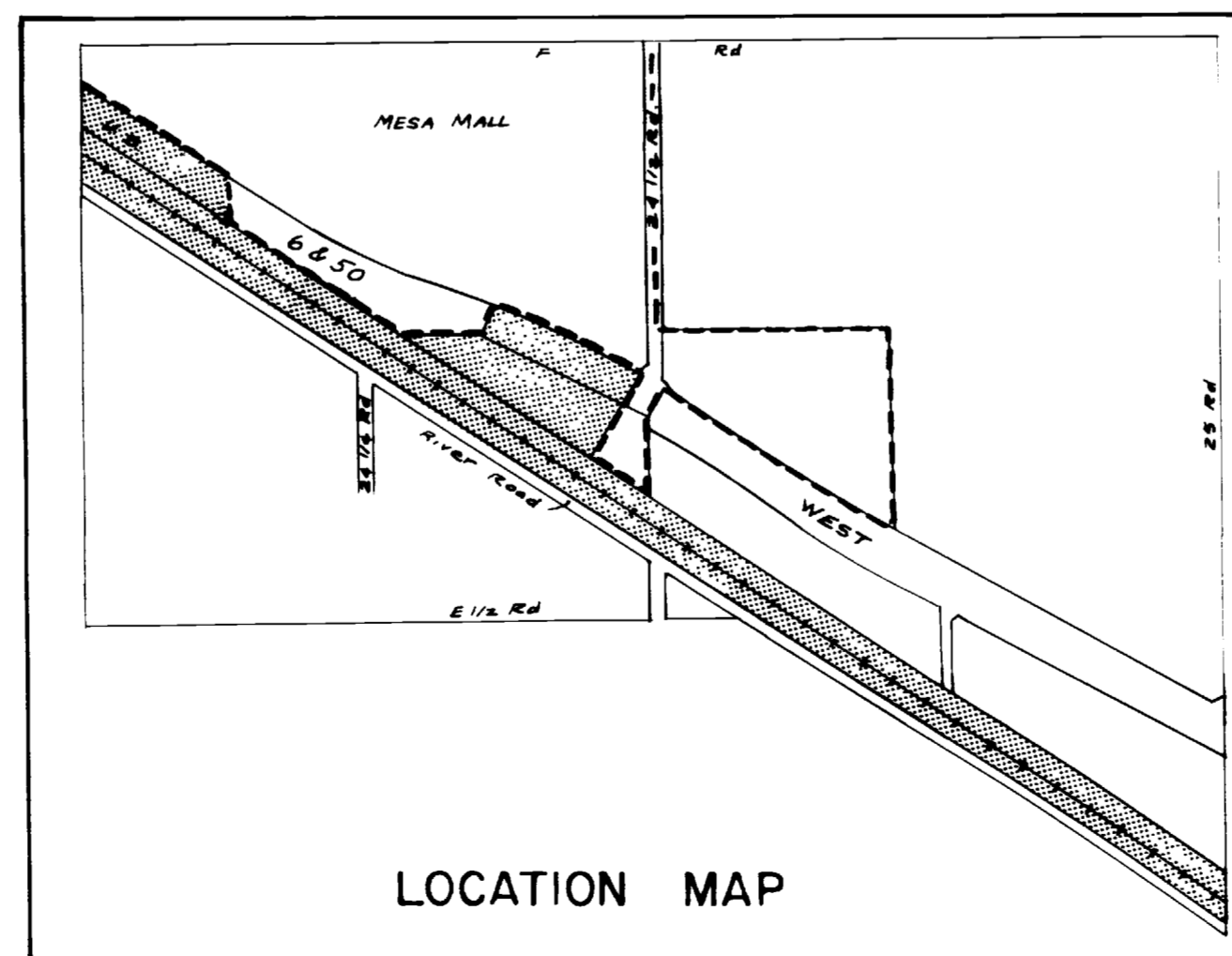

LOCATION MAP

| | | | | | | |
|-------------|------|----------------|---------|-------|--------------|---------|
| DESCRIPTION | DATE | DRAWN BY | DATE | SCALE | PLAN | PROFILE |
| REVISION A | | TH | 4/21/83 | | | |
| REVISION B | | CHECKED BY | DATE | | | |
| REVISION C | | APPROVED BY | DATE | | | |
| REVISION D | | FIELD BOOK NO. | PAGE | | not to scale | |

DEPARTMENT OF PUBLIC WORKS AND UTILITIES
ENGINEERING DIVISION
CITY OF GRAND JUNCTION, COLORADO

RIVER ROAD ANNEXATION

SHEET NO. 1
OF 1
FILE NO.