

FEE \$ <u>10.00</u>
TCP \$
SIF \$

**PLANNING CLEARANCE**  
 (Single Family Residential and Accessory Structures)  
**Community Development Department**

BLDG PERMIT NO. \_\_\_\_\_

Building Address 2676 CONTINENTAL DR  
 Parcel No. 2701-354-34-001  
 Subdivision PEACH HILL  
 Filing \_\_\_\_\_ Block \_\_\_\_\_ Lot \_\_\_\_\_

No. of Existing Bldgs 1 No. Proposed 1  
 Sq. Ft. of Existing Bldgs 3,000 Sq. Ft. Proposed ~~9200~~ 1205F  
 Sq. Ft. of Lot / Parcel .488 AC  
 Sq. Ft. Coverage of Lot by Structures & Impervious Surface (Total Existing & Proposed) \_\_\_\_\_

**OWNER INFORMATION:**

Name MICHAEL A HENDERSON  
 Address 2676 CONTINENTAL DR  
 City / State / Zip GRAND JUNCTION CO

**DESCRIPTION OF WORK & INTENDED USE:**

- New Single Family Home (\*check type below)
- Interior Remodel
- Addition NEW SHED
- Other (please specify): \_\_\_\_\_

**APPLICANT INFORMATION:**

Name MICHAEL A. HENDERSON  
 Address 2676 CONTINENTAL DR  
 City / State / Zip GRAND JUNCTION  
 Telephone 970-243-4399

**\*TYPE OF HOME PROPOSED:**

- Site Built
- Manufactured Home (HUD)
- Other (please specify): \_\_\_\_\_
- Manufactured Home (UBC)

NOTES: \_\_\_\_\_

**REQUIRED: One plot plan, on 8 1/2" x 11" paper, showing all existing & proposed structure location(s), parking, setbacks to all property lines, ingress/egress to the property, driveway location & width & all easements & rights-of-way which abut the parcel.**

<b>THIS SECTION TO BE COMPLETED BY COMMUNITY DEVELOPMENT DEPARTMENT STAFF</b>	
ZONE <u>RSF-2</u>	Maximum coverage of lot by structures <u>30%</u>
SETBACKS: Front <u>25'</u> from property line (PL)	Permanent Foundation Required: YES _____ NO <u>X</u>
Side <u>3'</u> from PL Rear <u>15' because of utility easement</u> from PL	Parking Requirement <u>2</u>
Maximum Height of Structure(s) <u>35'</u>	Special Conditions _____
Voting District _____	Driveway Location Approval _____ (Engineer's Initials)

Modifications to this Planning Clearance must be approved, in writing, by the Community Development Department. The structure authorized by this application cannot be occupied until a final inspection has been completed and a Certificate of Occupancy has been issued, if applicable, by the Building Department (Section 305, Uniform Building Code).

I hereby acknowledge that I have read this application and the information is correct; I agree to comply with any and all codes, ordinances, laws, regulations or restrictions which apply to the project. I understand that failure to comply shall result in legal action, which may include but not necessarily be limited to non-use of the building(s).

Applicant Signature [Signature] Date 10-5-04

Department Approval [Signature] Date 10/5/04

Additional water and/or sewer tap fee(s) are required:	YES	NO <u>X</u>	W/O No. _____
Utility Accounting <u>[Signature]</u>	Date	<u>10/5/04</u>	

VALID FOR SIX MONTHS FROM DATE OF ISSUANCE (Section 2.2.C.1 Grand Junction Zoning & Development Code)  
 (White: Planning) (Yellow: Customer) (Pink: Building Department) (Goldenrod: Utility Accounting)

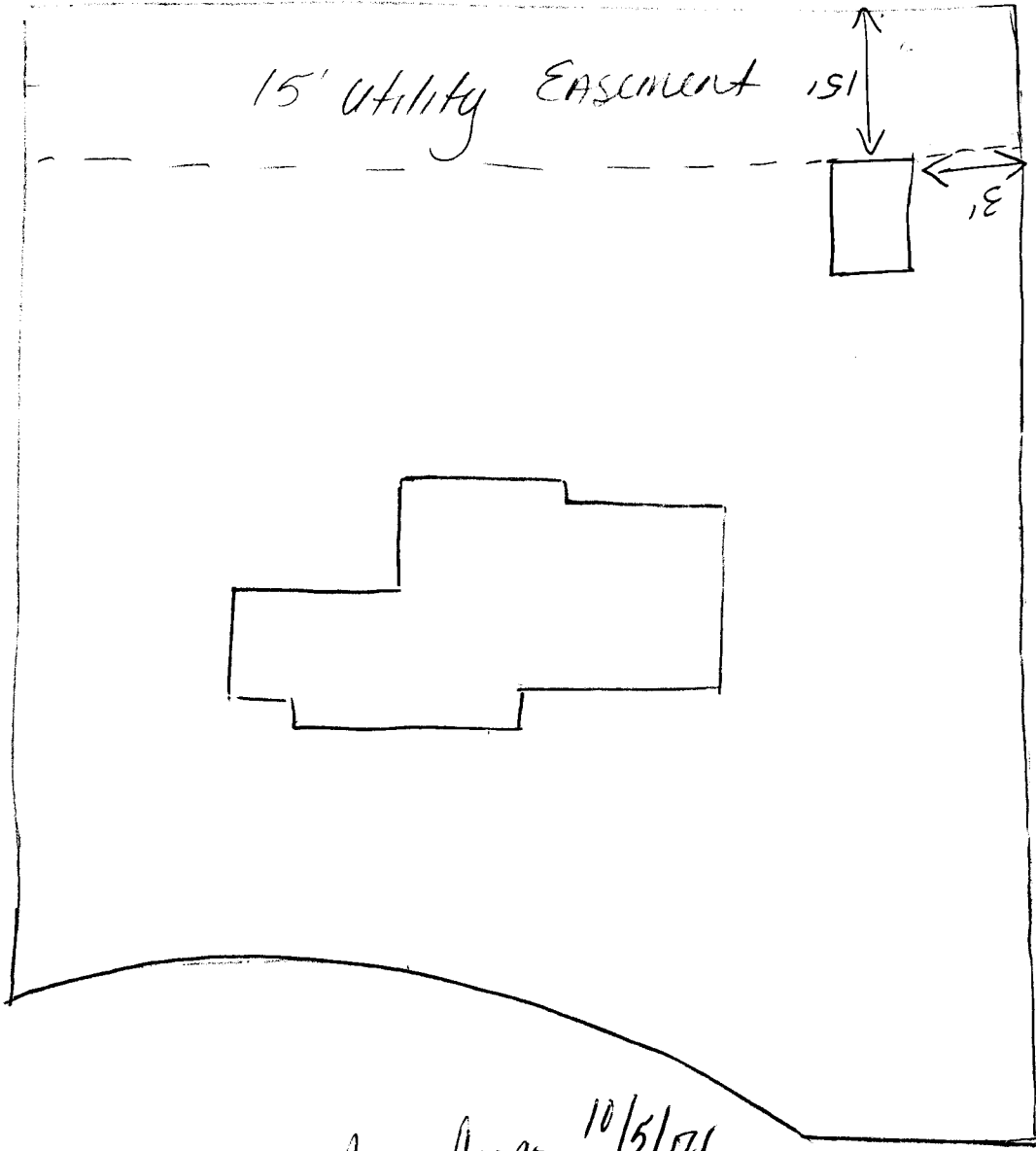

*Aishi Aaraz* 10/5/21  
**ACCEPTED**  
ANY CHANGE OF SETBACKS MUST BE  
APPROVED BY THE CITY PLANNING  
DEPT. IT IS THE APPLICANT'S  
RESPONSIBILITY TO PROPERLY  
LOCATE AND IDENTIFY EASEMENTS  
AND PROPERTY LINES.