

FEE \$ 10.00
 TCP \$ 1589.00
 SIF \$ 460.00

PLANNING CLEARANCE
 (Single Family Residential and Accessory Structures)
Community Development Department

BLDG PERMIT NO. _____

Building Address 1465 Sun Hawk Dr.
 Parcel No. 243-321-00-154/243-321-00-162
 Subdivision Hawks Nest
 Filing I Block 2 Lot 2

No. of Existing Bldgs 0 No. Proposed 1
 Sq. Ft. of Existing Bldgs 0 Sq. Ft. Proposed 2599
 Sq. Ft. of Lot / Parcel 9115
 Sq. Ft. Coverage of Lot by Structures & Impervious Surface (Total Existing & Proposed) _____
 Height of Proposed Structure _____

OWNER INFORMATION:

Name Pinnacle Homes
 Address 362 Main Street
 City / State / Zip Grand Jct, CO 81501

DESCRIPTION OF WORK & INTENDED USE:
 New Single Family Home (*check type below)
 Interior Remodel Addition
 Other (please specify): _____

APPLICANT INFORMATION:

Name Same
 Address Same
 City / State / Zip Same
 Telephone 970-241-1646

*TYPE OF HOME PROPOSED:
 Site Built Manufactured Home (UBC)
 Manufactured Home (HUD)
 Other (please specify): _____

NOTES: _____

REQUIRED: One plot plan, on 8 1/2" x 11" paper, showing all existing & proposed structure location(s), parking, setbacks to all property lines, ingress/egress to the property, driveway location & width & all easements & rights-of-way which abut the parcel.

THIS SECTION TO BE COMPLETED BY COMMUNITY DEVELOPMENT DEPARTMENT STAFF			
ZONE <u>R-4</u>	Maximum coverage of lot by structures <u>50%</u>		
SETBACKS: Front <u>20</u> from property line (PL)	Permanent Foundation Required: YES <u>X</u> NO _____		
Side <u>7</u> from PL Rear <u>25</u> from PL	Parking Requirement <u>2</u>		
Maximum Height of Structure(s) <u>35'</u>	Special Conditions _____		
Voting District <u>E</u>	Driveway Location Approval <u>[Signature]</u> (Engineer's Initials)		

Modifications to this Planning Clearance must be approved, in writing, by the Community Development Department. The structure authorized by this application cannot be occupied until a final inspection has been completed and a Certificate of Occupancy has been issued, if applicable, by the Building Department (Section 305, Uniform Building Code).

I hereby acknowledge that I have read this application and the information is correct; I agree to comply with any and all codes, ordinances, laws, regulations or restrictions which apply to the project. I understand that failure to comply shall result in legal action, which may include but not necessarily be limited to non-use of the building(s).

Applicant Signature Robert Taber For Bill Gibore Date August 3, 2007
 Department Approval [Signature] Date 8/17/07

Additional water and/or sewer tap fee(s) are required:	YES <input checked="" type="checkbox"/>	NO <input type="checkbox"/>	W/O No. <u>paid @ OMSD</u>
Utility Accounting <u>[Signature]</u>	Date <u>8-17-07</u>		

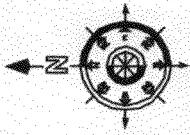

NOTE:
 BUILDER TO VERIFY
 ALL SETBACK AND EASEMENT
 ENCROACHMENTS PRIOR
 TO CONSTRUCTION

NOTE:
 DIMENSION LINES ARE PULLED FROM
 EDGE OF BRICK LEDGE. IF NO BRICK LEDGE
 EXISTS, DIMENSIONS WILL BE FROM EDGE
 OF FOUNDATION.

NOTE:
 GRADE MUST SLOPE AWAY FROM HOUSE 6" OF FALL IN
 THE FIRST 10' OF DISTANCE PER LOCAL BUILDING CODE.

NOTICE:
 1. IT IS THE RESPONSIBILITY OF THE BUILDER OR OWNER TO VERIFY ALL DETAILS.
 2. USE OF THIS PLAN CONSTITUTES BUILDING AND OR HOME OWNERS ACCEPTANCE OF THESE TERMS.
 3. ALL DIMENSIONS ARE TO EDGE OF FOUNDATION UNLESS OTHERWISE NOTED.
 4. BUILDER AND OR OWNER TO VERIFY ALL SETBACKS AND ENCROACHMENTS.
 5. THIS DRAWING IS UNLESS OTHERWISE INDICATED BY OTHERWISE SHOWN BY OTHERS.

SITE PLAN INFORMATION	
SUBDIVISION NAME	HAWKS NEST
PLAT NUMBER	1
LOT NUMBER	2
BLOCK NUMBER	2
STREET ADDRESS	7 SUN HAWK DR.
COUNTY	MESA
GARAGE SQ. FT.	700
COVERED ENTRY SQ. FT.	121 SF
COVERED PATIO SQ. FT.	218 SF
LIVING SQ. FT.	2589 SF
LOT SIZE	9115 SF
FRONT 20'	
SIDES 7'	
REAR 25'	

SCALE: 1"=20'-0"

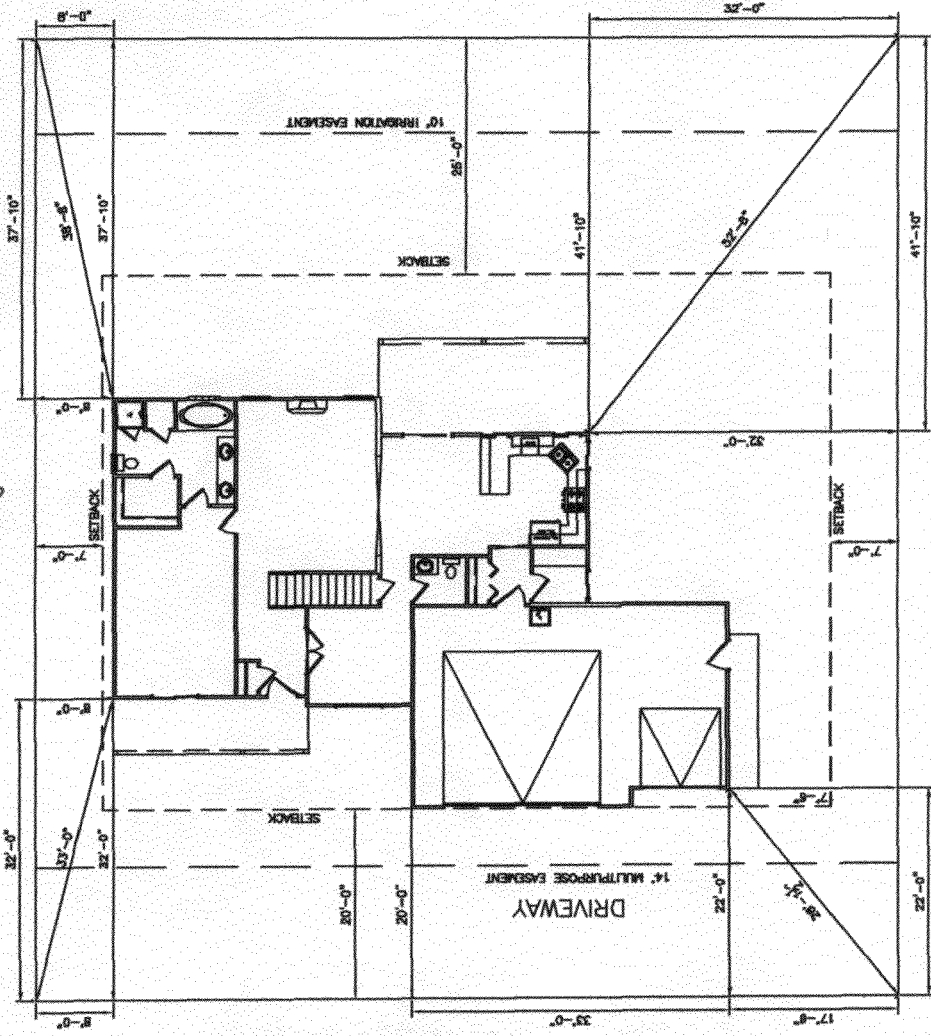

*7/21/13
 210 Ave
 Sun Hawk Drive*

Accepted
Paula Henderson

ACCEPTED
 ANY CHANGE IN SETBACKS MUST BE
 APPROVED BY THE CITY PLANNING
 DEPT. IT IS THE APPLICANT'S
 RESPONSIBILITY TO PROPERLY
 LOCATE AND IDENTIFY EASEMENTS
 AND PROPERTY LINES.