

CHRIS BROWN

PINYON AVE.

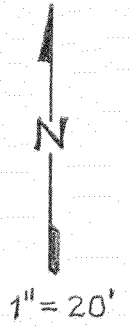
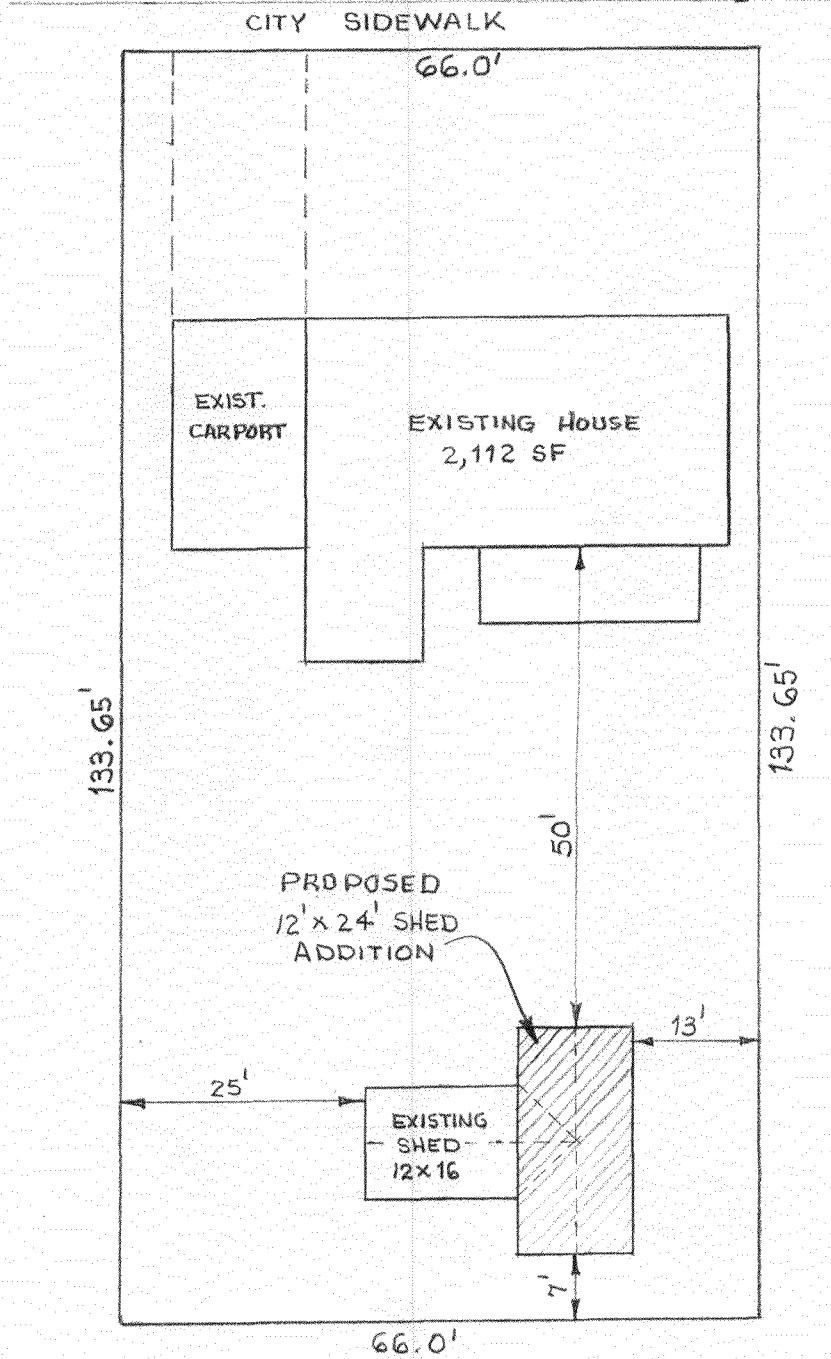

PLOT PLAN

ACCEPTED *SLC 9/16/08*
ANY CHANGE OF SETBACKS MUST BE
APPROVED BY THE CITY PLANNING DIVISION.
IT IS THE APPLICANT'S RESPONSIBILITY TO
PROPERLY LOCATE AND IDENTIFY
EASEMENTS AND PROPERTY LINES.