

ORDINANCE NO. 2490

AN ORDINANCE ANNEXING TERRITORY TO THE CITY OF GRAND JUNCTION, COLORADO (PAINTED BOWL ANNEXATION NO. 1)

WHEREAS, on the 5th day of September, 1990, the City Council of the City of Grand Junction considered a petition for the annexation of the following described territory to the City of Grand Junction; and

WHEREAS, a hearing on the petition was duly held after proper notice on the 17th day of October, 1990; and

WHEREAS, the City Council determined that said territory was eligible for annexation and that no election was necessary to determine whether such territory should be annexed;

NOW, THEREFORE, BE IT ORDAINED BY THE CITY COUNCIL OF THE CITY OF GRAND JUNCTION, COLORADO:

That the property situate in Mesa County, Colorado, and described to wit:

All of Mt. Sopris Drive platted in Heatheridge Subdivision, and all of the public right-of-way of South Redlands Road adjacent to Heatheridge Subdivision, and the Southerly one foot of the public right-of-way of Monument Road from the intersection of the north right-of-way line of South Redlands Road to the southwesterly right-of-way line for Mariposa Drive as dedicated in Book 1037, Pages 381 and 382 and the northwesterly right-of-way line for Monument Road as dedicated in Book 963, Page 135 of the records of the Mesa County Clerk and Recorder.

be and the same is hereby annexed to the City of Grand Junction, Colorado.

PASSED and ADOPTED this 7th day of November, 1990.

William E. McCurry

\_\_\_\_\_  
President of the Council

Attest:

Neva B. Lockhart, CMC

\_\_\_\_\_  
City Clerk

I HEREBY CERTIFY that the foregoing ordinance, being Ordinance No. 2490, was introduced, read, and ordered published by the City Council of the City of Grand Junction, Colorado, at a regular meeting of said body held on the 7th day of October, 1990, and that the same was published in The Daily Sentinel, a newspaper published and in general circulation in said City, at least ten days before

its final passage.

IN WITNESS WHEREOF, I have hereunto set my hand and affixed the official Seal of said City this 8th day of November, 1990.

Neva B. Lockhart

---

Neva B. Lockhart, CMC  
City Clerk

Published: October 19, 1990

Published: November 9, 1990

Effective: December 9, 1990

# PAINTED BOWL ANNEXATION #1

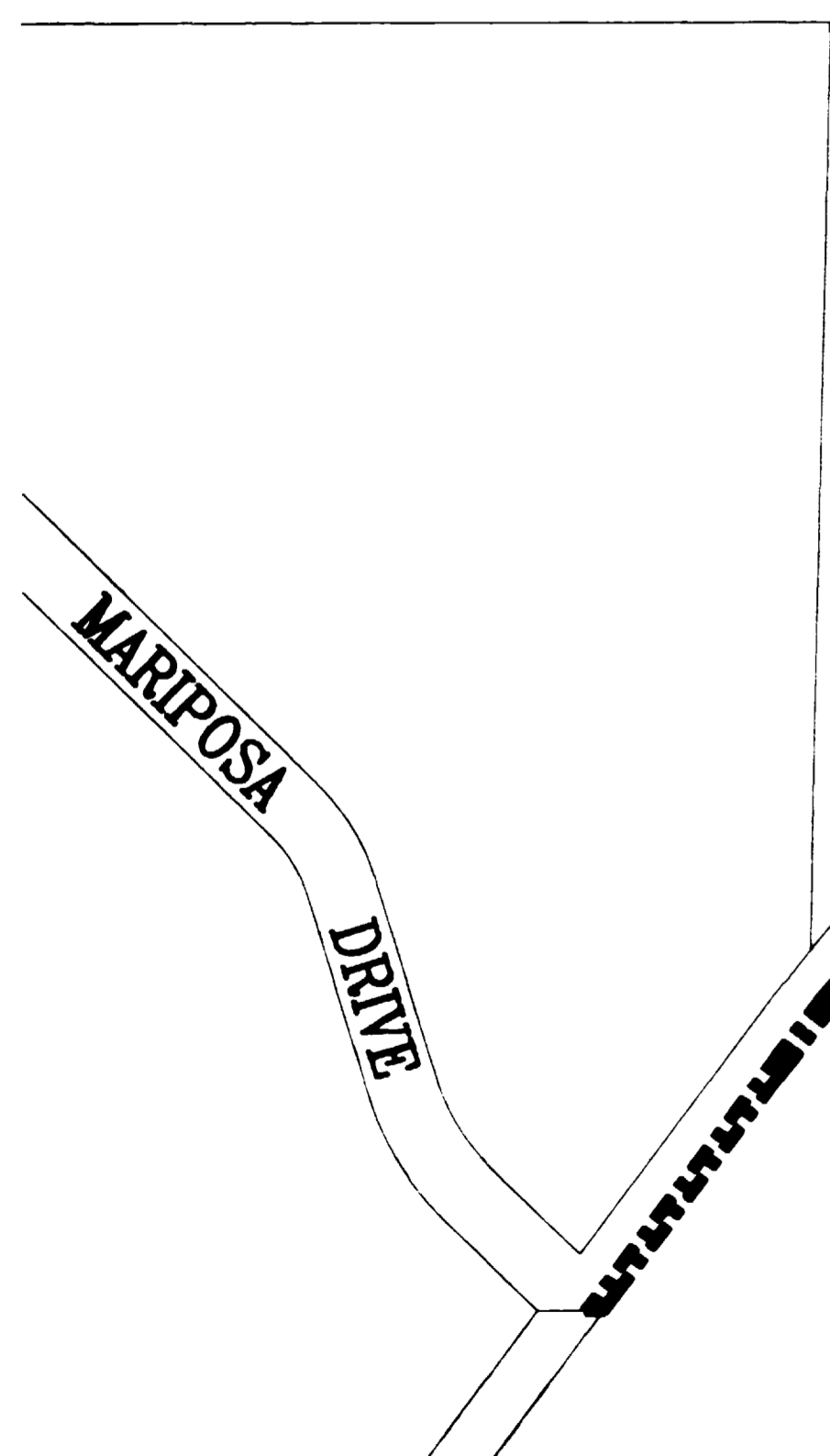
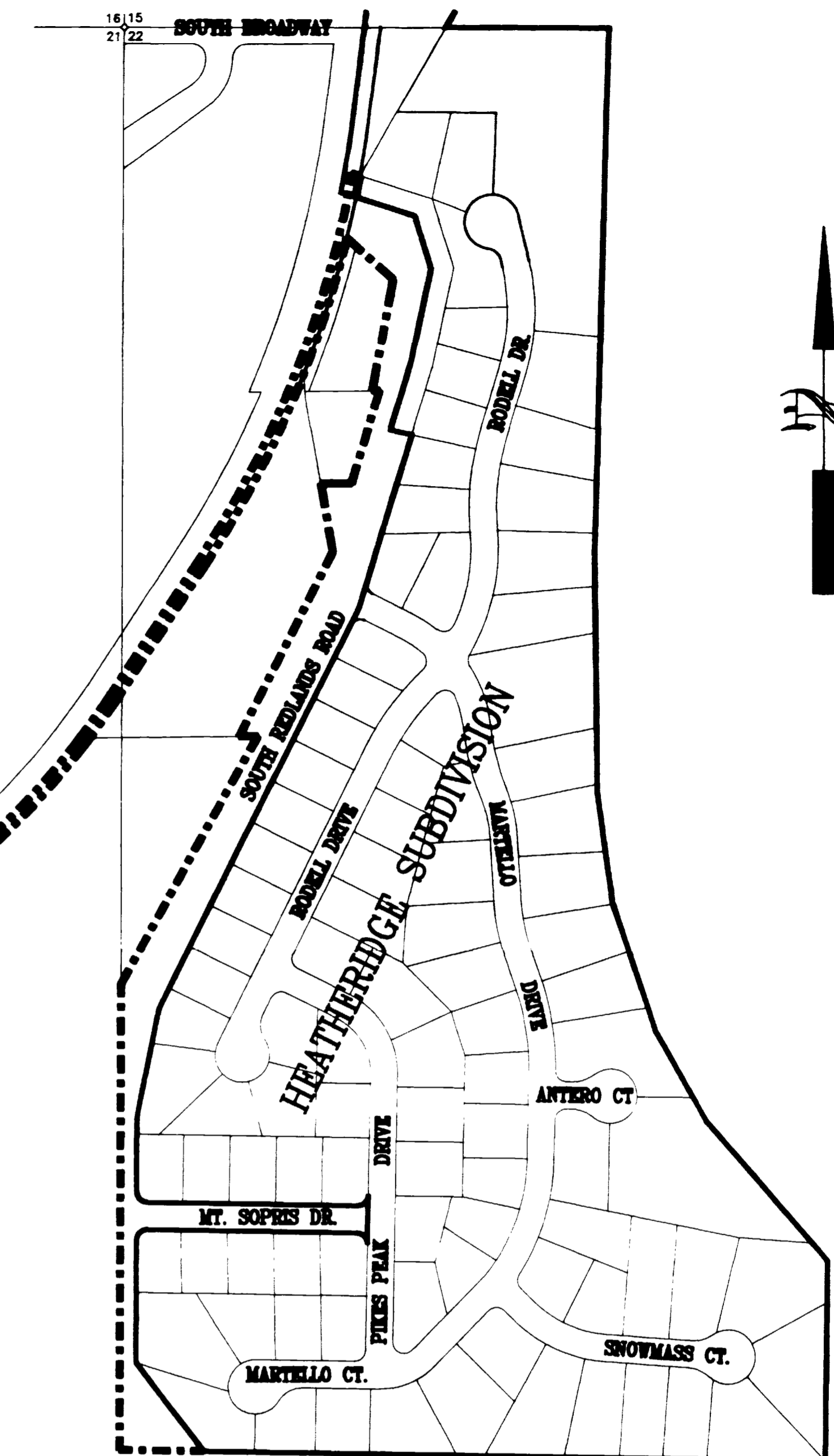

MONUMENT ROAD

### LEGEND

- Annexation Boundary
- Existing City Limits

### AREA OF ANNEXATION

Annexation Perimeter	18,536
Contiguous Perimeter	3,554
Area in Square Feet	192,212
Area in Acres	4.41

### DESCRIPTION

All of Mt. Sopris Drive platted in Heatheridge Subdivision, and all of the public right-of-way of South Redlands Road adjacent to Heatheridge Subdivision, and the Southerly one foot of the public right-of-way of Monument Road from the intersection of the North right-of-way line of South Redlands Road to a point on a line projected Easterly from the intersection of the Southwesterly right-of-way line for Miraposa Drive as dedicated in Book 1037, Pages 381 and 382, and the Northwesterly right-of-way line for Monument Road as dedicated in Book 963, Page 135 of the records of the Mesa County Clerk and Recorder.

ORDINANCE NUMBER

2490

EFFECTIVE DATE

12/9/90

This annexation plat has been prepared under my direction. The Legal Description(s) contained herein have been derived from subdivision plats and deed description as they appear in the office of the Mesa County Clerk and Recorder. This plat does not constitute a legal survey, and is not intended to be used as a means for establishing or verifying property boundary lines.

*J. Don Newton*  
 J. Don Newton, City Engineer

REVISION	DESCRIPTION	DATE	DRAWN BY	KADEL	DATE	10/90	SCALE
			CHECKED BY		DATE		PLAN
			APPROVED BY		DATE		1"=200'
			FIELD BOOK NO.		PAGE		VERT.

DEPARTMENT OF PUBLIC WORKS AND UTILITIES  
 ENGINEERING DIVISION  
 CITY OF GRAND JUNCTION, COLORADO

PAINTED BOWL ANNEXATION #1	SHEET NO. 1
	OF 1
	FILE NO. PAINT1.DWG