

ORDINANCE NO. 2492

AN ORDINANCE ANNEXING TERRITORY TO THE CITY OF GRAND JUNCTION,
COLORADO (PAINTED BOWL ANNEXATION NO. 3)

WHEREAS, on the 5th day of September, 1990, the City Council of the
City of Grand Junction considered a petition for the annexation of
the following described territory to the City of Grand Junction;
and

WHEREAS, a hearing on the petition was duly held after proper
notice on the 17th day of October, 1990; and

WHEREAS, the City Council determined that said territory was
eligible for annexation and that no election was necessary to
determine whether such territory should be annexed;

NOW, THEREFORE, BE IT ORDAINED BY THE CITY COUNCIL OF THE CITY OF
GRAND JUNCTION, COLORADO:

That the property situate in Mesa County, Colorado, and described
to wit:

All of the north 1/4 of the south 1/2 of the west 1/4 of Section
21, T1S R1W.

be and the same is hereby annexed to the City of Grand Junction,
Colorado.

PASSED and ADOPTED this 7th day of November, 1990.

William E. McCurry

President of the Council

Attest:

Neva B. Lockhart, CMC

City Clerk

I HEREBY CERTIFY that the foregoing ordinance, being Ordinance No.
2492, was introduced, read, and ordered published by the City
Council of the City of Grand Junction, Colorado, at a regular
meeting of said body held on the 17th day of October, 1990, and
that the same was published in The Daily Sentinel, a newspaper
published and in general circulation in said City, at least ten
days before its final passage.

IN WITNESS WHEREOF, I have hereunto set my hand and affixed the
official Seal of said City this 8th day of November, 1990.

Neva B. Lockhart

Neva B. Lockhart, CMC
City Clerk

Published: October 19, 1990

Published: November 9, 1990

Effective: December 9, 1990

PAINTED BOWL ANNEXATION #3

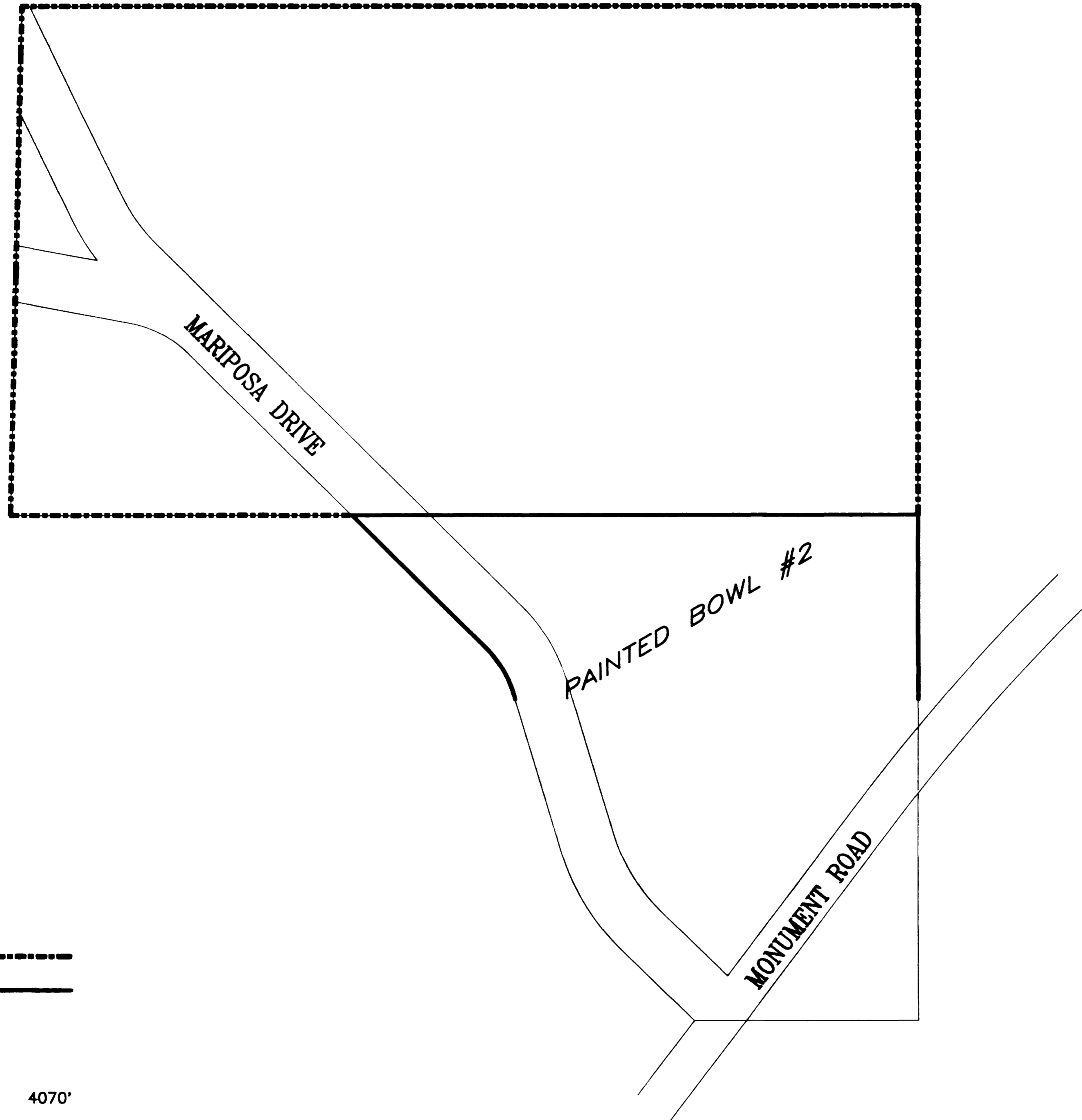

DESCRIPTION

All of the North 1/4 of the South 1/2 of the West 1/4 of Section 21, T1S, R1W of the Ute Meridian.

ORDINANCE NUMBER
2492

EFFECTIVE DATE
12/9/90

LEGEND

Annexation Boundary
Existing City Limits

AREA OF ANNEXATION

Annexation Perimeter 4070'
Contiguous Perimeter 820'
Area in Square Feet 955,180
Area in Acres 21.93

This annexation plat has been prepared under my direction. The Legal Description(s) contained herein have been derived from subdivision plats and deed descriptions as they appear in the office of the Mesa County Clerk and Recorder. This plat does not constitute a legal survey, and is not intended to be used as a means for establishing or verifying property boundary lines.

Don Newton
Don Newton, City Engineer

REVISION	DESCRIPTION	DATE	DRAWN BY	L. MARTIN	DATE	9/90	SCALE	PLAN	PROFILE
REVISION			CHECKED BY	B.L.	DATE	10/90		HORIZ. N.T.S.	HORIZ. N.T.S.
REVISION			APPROVED BY		DATE			VERT.	
REVISION			FIELD BOOK NO.		PAGE				

DEPARTMENT OF PUBLIC WORKS AND UTILITIES
ENGINEERING DIVISION
CITY OF GRAND JUNCTION, COLORADO

PAINTED BOWL ANNEXATION #3

SHEET NO. 1
OF 1
FILE NO. PAINT3.DWG