

ORDINANCE NO. 2493

AN ORDINANCE ANNEXING TERRITORY TO THE CITY OF GRAND JUNCTION, COLORADO (PAINTED BOWL ANNEXATION NO. 4)

WHEREAS, on the 5th day of September, 1990, the City Council of the City of Grand Junction considered a petition for the annexation of the following described territory to the City of Grand Junction; and

WHEREAS, a hearing on the petition was duly held after proper notice on the 17th day of October, 1990; and

WHEREAS, the City Council determined that said territory was eligible for annexation and that no election was necessary to determine whether such territory should be annexed;

NOW, THEREFORE, BE IT ORDAINED BY THE CITY COUNCIL OF THE CITY OF GRAND JUNCTION, COLORADO:

That the property situate in Mesa County, Colorado, and described to wit:

All of the south 1/2 of the west 1/4 of Section 21, T1S R1W and the SE 1/4 SW 1/4 of said Section 21, except that property described in Painted Bowl Annexations #2 and #3.

be and the same is hereby annexed to the City of Grand Junction, Colorado.

PASSED and ADOPTED this 7th day of November, 1990.

William E. McCurry

\_\_\_\_\_  
President of the Council

Attest:

Neva B. Lockhart, CMC

\_\_\_\_\_  
City Clerk

I HEREBY CERTIFY that the foregoing ordinance, being Ordinance No. 2493, was introduced, read, and ordered published by the City Council of the City of Grand Junction, Colorado, at a regular meeting of said body held on the 17th day of October, 1990, and that the same was published in The Daily Sentinel, a newspaper published and in general circulation in said City, at least ten days before its final passage.

IN WITNESS WHEREOF, I have hereunto set my hand and affixed the official Seal of said City this 8th day of November, 1990.

Neva B. Lockhart

---

Neva B. Lockhart, CMC  
City Clerk

Published: October 19, 1990

Published: November 9, 1990

Effective: December 9, 1990

# PAINTED BOWL ANNEXATION #4

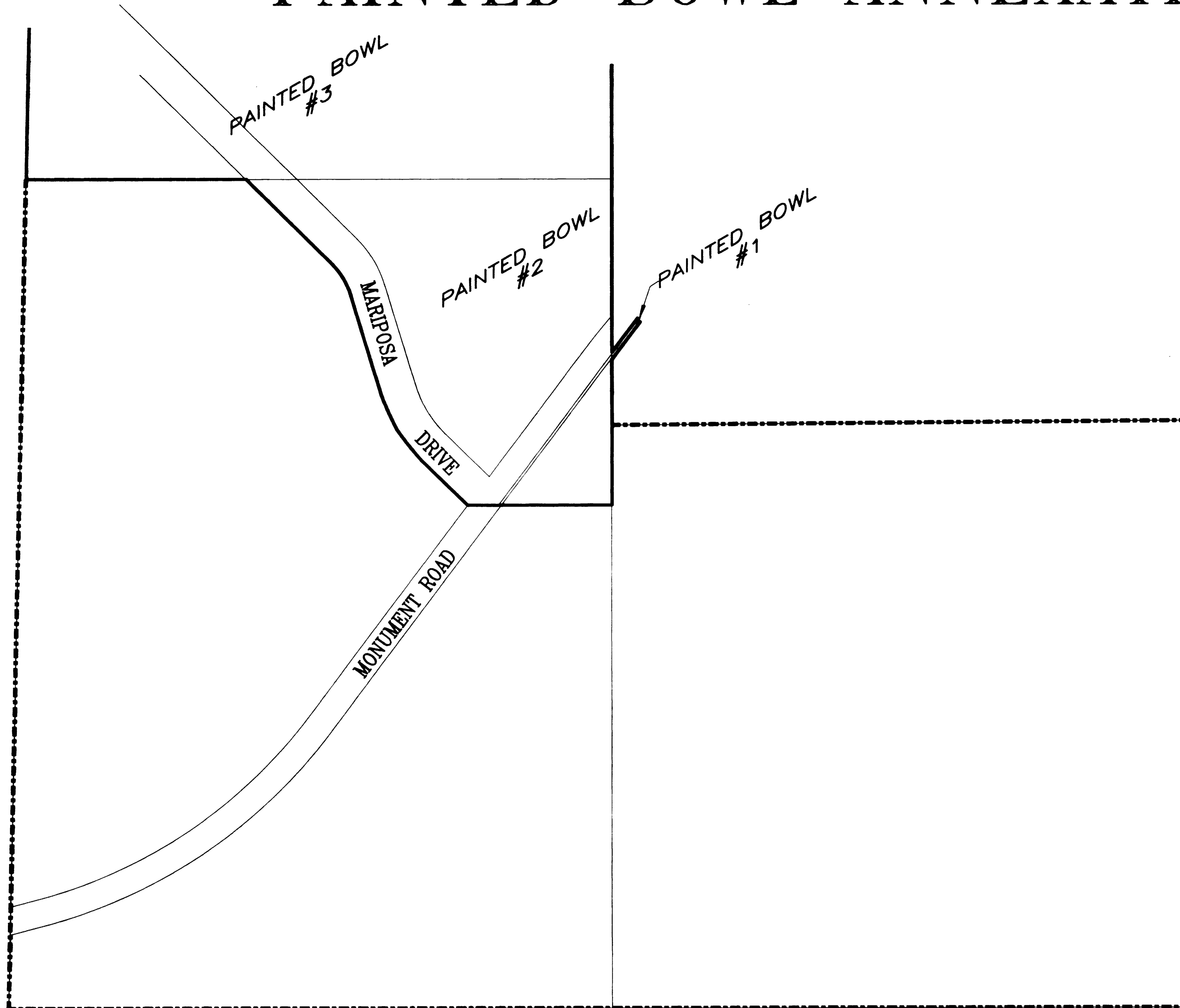

### DESCRIPTION

All of the South 1/2 of the West 1/4 of Section 21, T1S R1W of the Ute Meridian and the SE 1/4 SW 1/4 of said Section 21 of the Ute Meridian, except that property described in Painted Bowl Annexations #2 and #3.

### LEGEND

Annexation Boundary   
 Existing City Limits

### AREA OF ANNEXATION

Annexation Perimeter	7,181'
Contiguous Perimeter	1,517,
Area in Square Feet	2,387,170
Area in Acres	54.82

ORDINANCE NUMBER  
2493

EFFECTIVE DATE  
12/9/90

This annexation plat has been prepared under my direction. The Legal Description(s) contained herein have been derived from subdivision plats and deed descriptions as they appear in the office of the Mesa County Clerk and Recorder. This plat does not constitute a legal survey, and is not intended to be used as a means for establishing or verifying property boundary lines.

*J. Don Newton*  
J. Don Newton, City Engineer

REVISION	DESCRIPTION	DATE	DRAWN BY L. MARTIN	DATE 9/90	SCALE
REVISION			CHECKED BY B.L.	DATE 10/90	PLAN
REVISION			APPROVED BY	DATE	PROFILE
REVISION			FIELD BOOK NO.	PAGE	HORIZ. N.T.S.
					VERT.

DEPARTMENT OF PUBLIC WORKS AND UTILITIES  
ENGINEERING DIVISION  
CITY OF GRAND JUNCTION, COLORADO

PAINTED BOWL ANNEXATION #4

SHEET NO. 1  
OF 1  
FILE NO. PAINT4.DWG