

RECORD DRAWINGS:
 These record drawings were created from contractor provided red-lined drawings and field survey information provided by Atkins and Associates, Inc.

CITY OF GRAND JUNCTION ENGINEERING
 APPROVED FOR CONSTRUCTION FOR ONE YEAR FROM THIS DATE.
 BY: _____ DATE: _____
 ACCEPTED AS CONSTRUCTED
 BY: _____ DATE: _____

"All details, construction, inspections, and testing shall conform to the City of Grand Junction Standard Contract Documents for Capital Improvements Construction. Contractor shall have a copy of the accepted plans and current City of Grand Junction Standard Documents for Capital Improvements Construction on site and available at all times."

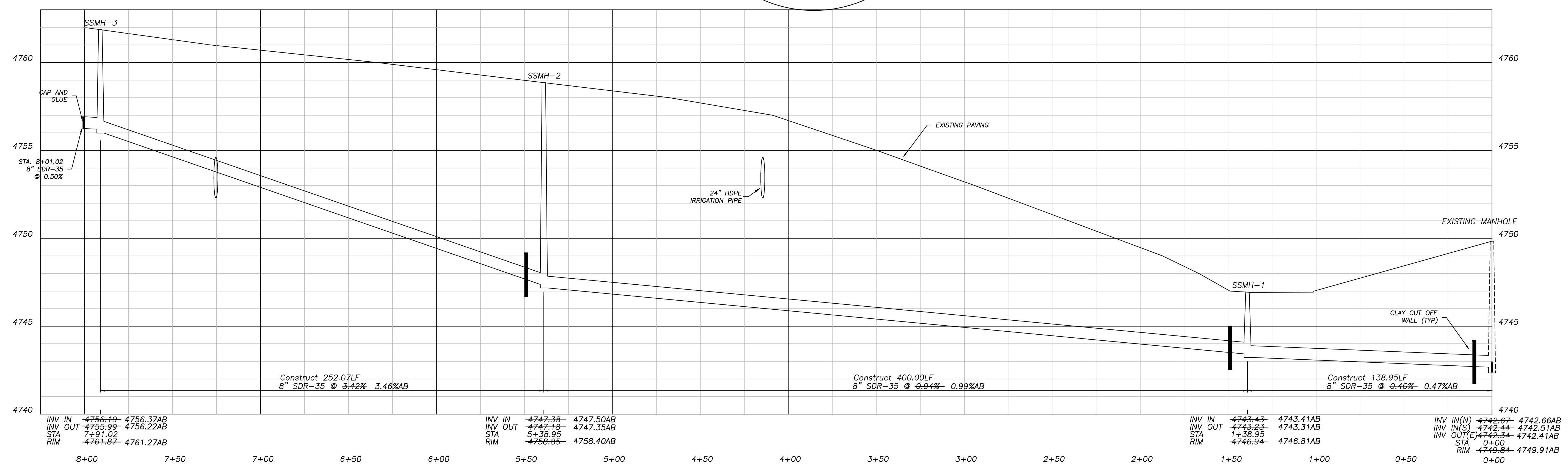

CALL UTILITY NOTIFICATION CENTER OF COLORADO 1-800-822-1887	
DATE: 9/9/03	DRAWN BY: JCS
DATE: 7/6/04	DESIGNED BY: JCS
NO. 1	DESCRIPTION: WEST ENTRANCE RELOCATION PER CITY
NO. 2	DESCRIPTION: RECORD DRAWINGS
 336 Main Street, Suite 203 • Grand Junction, Colorado • 81501 (970) 242-7540	
MONUMENT PRESBYTERIAN CHURCH description: SANITARY SEWER PLAN & PROFILE prepared for: PRESBYTERY OF WESTERN COLORADO	
DRAWN BY: JCS	CHECKED BY: RTRC
DESIGNED BY: JCS	APPROVED BY: mrc
JOB NUMBER: 653.0002	
DATE: 5/29/03	
SCALE: 1"=30'	
SHEET NO: U2	