

McMULLIN & GORMLEY SUB-DIVISION
of W $\frac{1}{2}$ SE $\frac{4}{4}$ SECTION 11, T.1 S. R.1 W. Ute M.

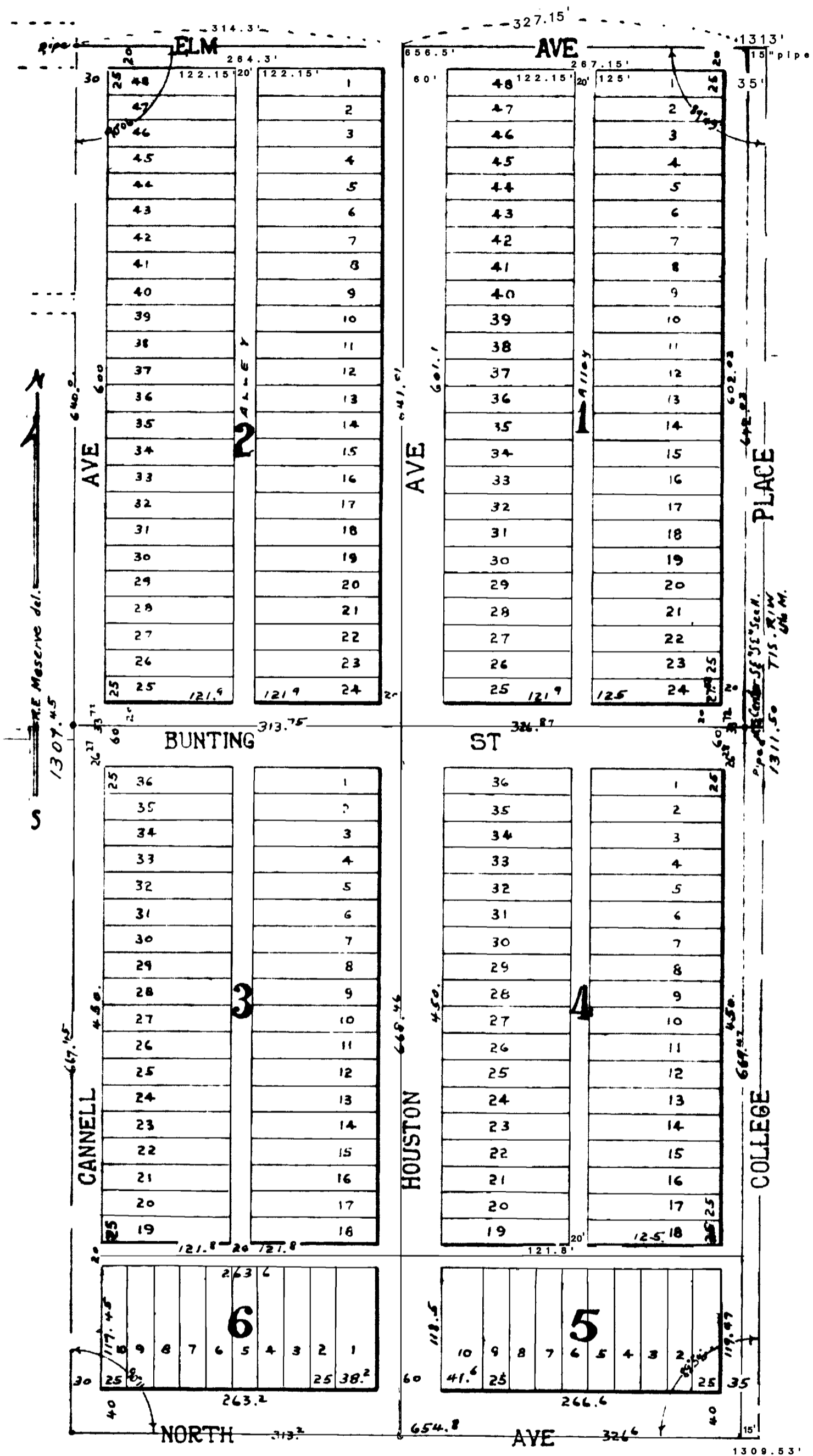

McMULLIN & GORMLEY SUB-DIVISION
of W $\frac{1}{2}$ SE $\frac{4}{4}$ Section 11, T.1 S, R.1 W, Ute Mer.

KNOW ALL MEN BY THESE PRESENTS: That the undersigned A.T.GORMLEY, J.A. CANNELL, and THE HOME LOAN and INVESTMENT COMPANY, a corporation, being the owners of the following described land, to-wit:
THE WEST ONE HALF OF THE SOUTHEAST QUARTER OF THE SOUTHEAST QUARTER OF SECTION ELEVEN, TOWNSHIP ONE SOUTH OF RANGE ONE WEST UTE MERIDIAN, MESA COUNTY, COLORADO,
have laid out and platted "McMULLIN and GORMLEY Sub-division" of said land, and hereby dedicate the streets, avenues and alleys indicated on this plat to the use of the public forever.
In witness whereof A.T.Gormley and J.A.Cannell have affixed their hands, and the corporation has caused its name to be hereunto subscribed by its President, and its corporate seal to be hereunto affixed, attested by its Secretary.

A.T. Gormley
J.A. Cannell
THE HOME LOAN AND INVESTMENT COMPANY
Secretary by *A.T. Gormley* President

STATE of COLORADO }
County of Mesa } ss.
The foregoing instrument was acknowledged before me this 25 day of January 1939
by A.T.GORMLEY and J.A.CANNELL
Witness my hand and official seal
My Commission expires March 22, 1941
Arline Jones
Notary Public

STATE of COLORADO }
County of Mesa } ss.
The foregoing instrument was acknowledged before me this 25 day of January 1939
by *A.T. McMullin* as President, and by *O.E. Daniels, Jr.* as Secretary of
THE HOME LOAN AND INVESTMENT COMPANY, a corporation
Witness my hand and official seal.
My commission expires March 22, 1941
Arline Jones
Notary Public.

I, Richard E Meserve, a registered engineer of Colorado, hereby certify that all the requirements of Ordinance # 588, city of Grand Junction, Colorado, have been complied with

APPROVED January 18 1939

Approved and Accepted on this 18 day of JANUARY A.D. 1939
by *B.P. Graves*
President of the City Council.



ATTEST:
William C. Tomlinson
City Clerk

CITY OF GRAND JUNCTION
OFFICE of the CITY ENGINEER
McMULLIN-GORMLEY