

State of Colorado }
County of Mesa }



On the seventh day of July 1890 before me came The Orchard Mesa Heights Company by its President Benton Cannon who is known to me to be the identical person whose name is subscribed to the foregoing statement as such. President and he then acknowledged the said foregoing instrument to be the act and deed of the said The Orchard Mesa Heights Company and for the uses and purposes therein set forth.

Witness my hand and seal this 7th day of July 1890.
J.H. Bridges,
Notary Public
My Commission expires May 22nd 1894

MAP OF ORCHARD MESA HEIGHTS.

VAR 14° 45' E.
Scale 200ft-1 inch
E.B. SAWYER, C.E.
Montrose Colorado

Know all men by these presents, that The Orchard Mesa Heights Co. of the County of Mesa and State of Colorado has set aside and platted the parcel of land as shown on this map, being the NW 1/4 of the NE 1/4 of Sec 26 and lots No 5, 6 and parts of Lot No 9 of Sec 23 Township 1 S Range 9 W of the Meridian under the name and style of Orchard Mesa Heights and by these presents do grant to the use of the public the perpetual right of way over and through the blocks used to be a corner of lots this plat of way over and through the alleys and streets in their respective blocks as shown on this map.

Witness our hand and Corporate seal this seventh day of July 1890
Attest
The Orchard Mesa Heights Co.
By Benton Cannon, President

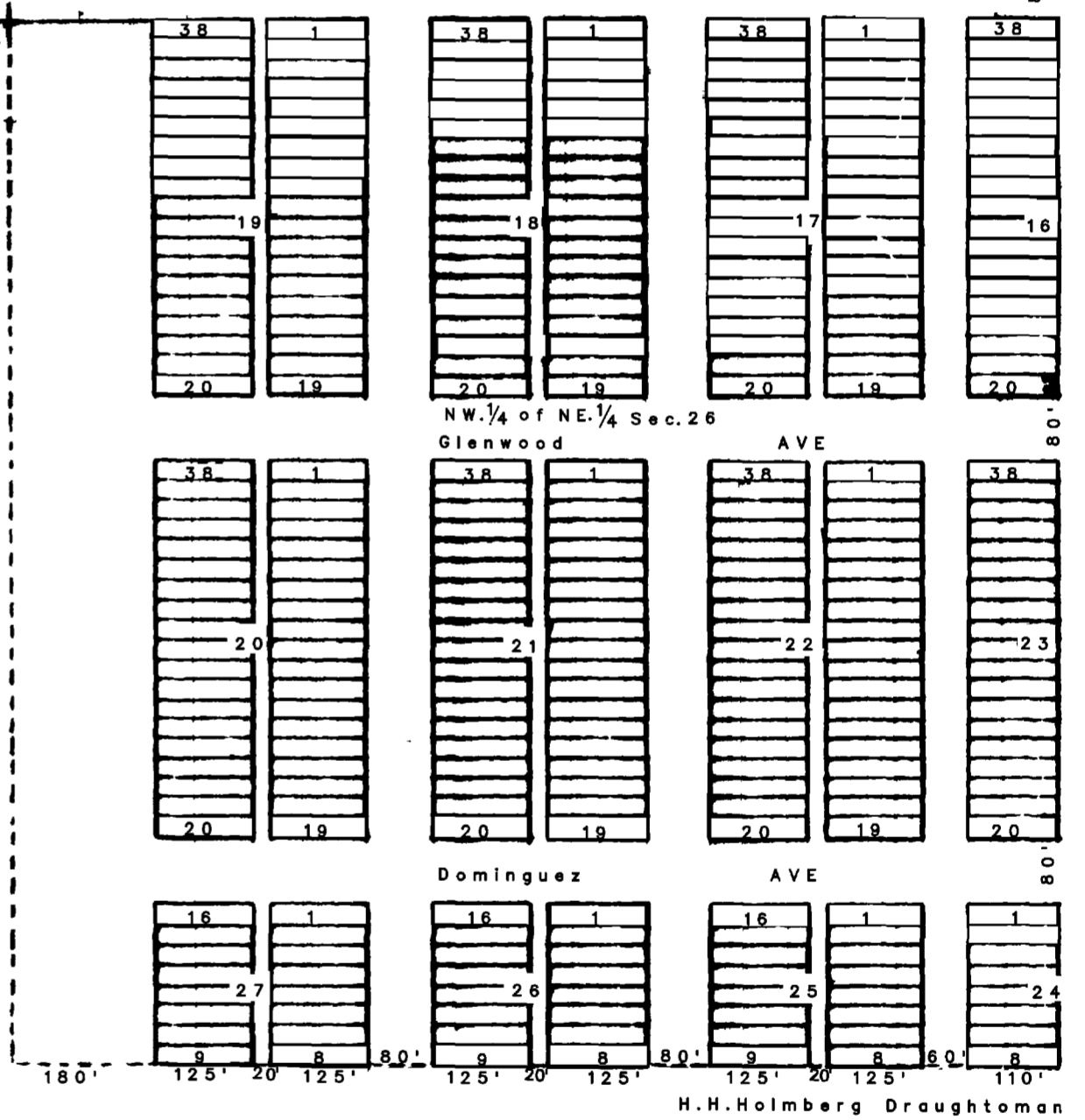

State of Colorado }
Mesa County }
I, H.H. Holmberg, Recorder, do hereby certify that this instrument was filed for record in my office at Montrose on July 7th 1890 and is recorded in Plat Book 1 Page 216

(Amended Plat of A picture of the Plat Recorded on page 26)

- Vacating Parcel 25 A 401 P 151
- 251 2000 A 218
- Vacating land 2438 - P 20
- 2438 - P 20
- Vacating parcel 2438 - P 20
- Apr 800 2438 - P 20
- Vacating alley 2411 - P 10
- Vacating parcel alley 2412 A 194
- Vacating order of land on S. & W. sides of
- Palmer St. B. 503 - P. 20
- Vol 0710 no Dedication - Part As per B 554 P 263

B-1 P-16