

PLAT OF  
 AMENDED SURVEY  
 OF THE  
 LITTLE BOOKCLIFF RAILROAD YARDS  
 GRAND JUNCTION COLORADO

COMPARED  
 245519  
 State of Colorado, } ss.  
 County of Mesa }  
 I hereby certify that this instrument  
 was filed for record on June 26 1929  
 at 10:00 clock A.M. and recorded  
 in Book 57 Page 10  
 DENZEL L. YARNELL, RECORDER  
 By \_\_\_\_\_ Deputy.

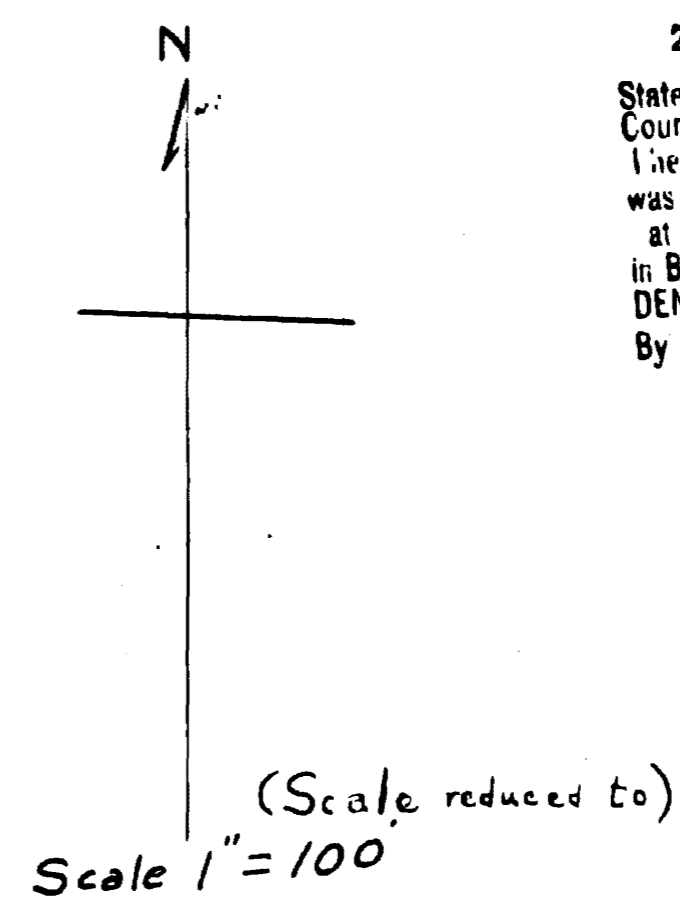

STATE OF COLORADO } ss  
 COUNTY OF MESA }

KNOW ALL MEN BY THESE PRESENTS: That CH Biggs and WC Kurtz have caused the following described tract of land to be surveyed and plotted as shown on this map to wit Beginning at a point 281' West and 30' South of the NE corner of NE 1/4 Sec 15 T15 N1W Ute Mer; thence West 1563' to the East line of Carpenters Subdivision No 2 Thence 528' 10" W along the East line of said subdivision 634' to the East line of the County Road thence 540' 47" E along said road 3076' to the North line of Main Street thence East along the North line of said Main Street 3524' thence North 966.0' to the place of beginning

CH Biggs  
 WC Kurtz

I Chas M Holmas a Notary Public in and for the State and County aforesaid do hereby certify that CH Biggs and WC Kurtz known to me to be the same persons who signed the above and foregoing plat and statement appeared before me this day in person and acknowledged that they signed sealed and delivered the same as their own free and voluntary act and deed for the uses and purposes therein set forth

Given under my hand and notarial seal this 25<sup>th</sup> day of June 1929  
 My commission expires June 20 1931

Charles M Holmas  
 Notary Public

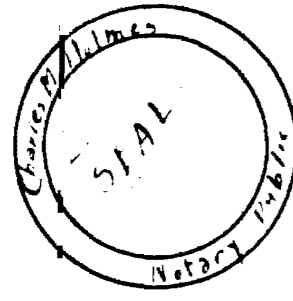

I Roy L George being the duly elected and qualified County Surveyor in and for the County of Mesa State of Colorado do hereby certify that I have surveyed the above described tract and find it to be on the ground as shown on this plat

Roy L George  
 County Surveyor

