

LINDEN ACRES SUBDIVISION REPLAT

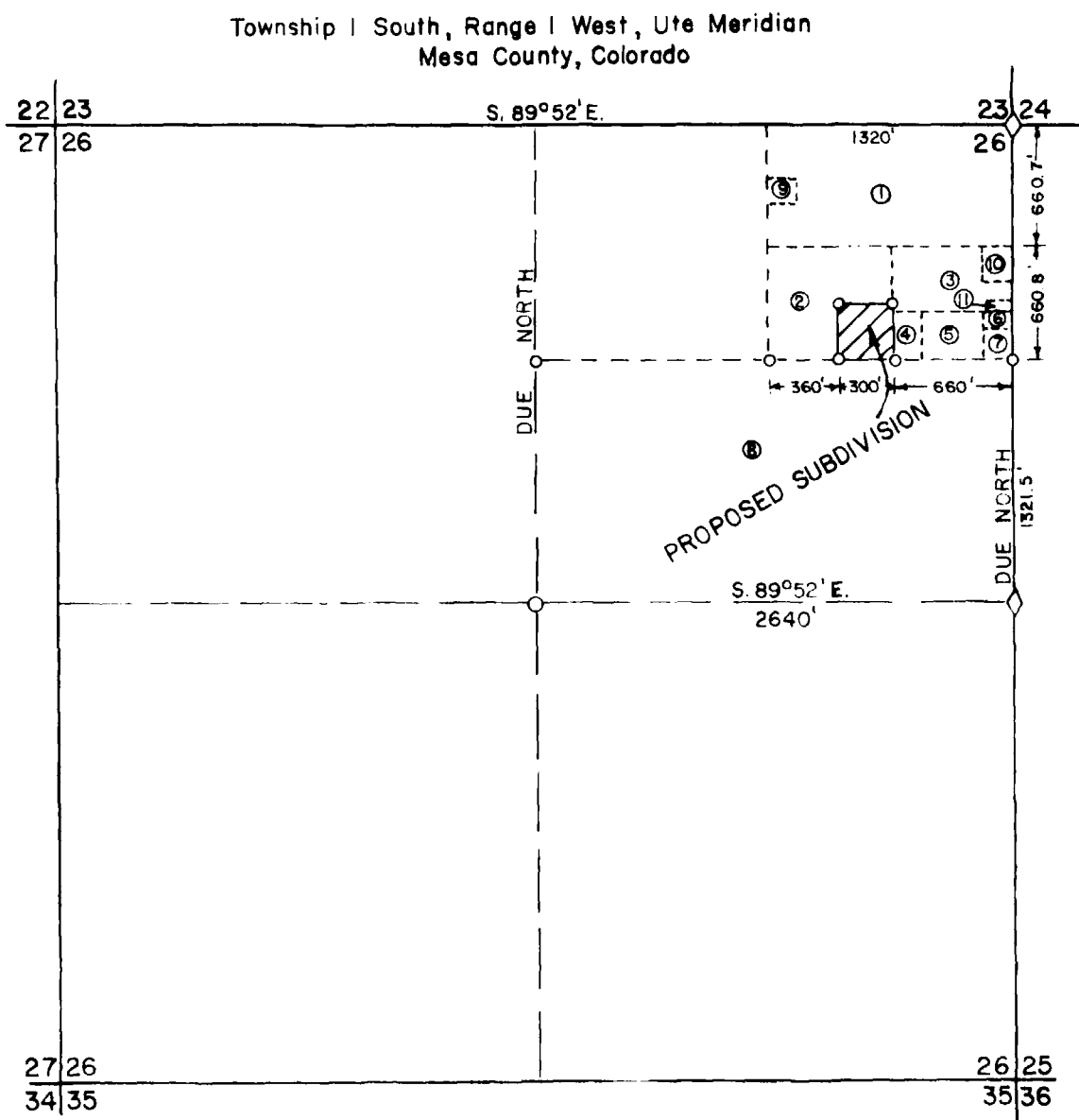

LOCATION MAP  
SCALE: 1" = 1000'

ADJACENT LAND OWNERS

1. Glen C & Roberta C Perkins
2. Paul J & Margaret Mae Hammond
3. Milton & Lyda J Manfreda
4. Donald & Helen B Rhyno
5. Angelo & Alyce Arcieri
6. William A. Graham
7. Arthur & Velma Moore
8. Tom & Katona Hayashi
9. Florence & Gill Ingraham
10. W. Darrell & Virginia M Bays
11. Thorvald Jensen

NOTE: See numbered Tracts on Location Map

RECITATION

KNOW ALL MEN BY THESE PRESENTS:

That the undersigned PAUL J. HAMMOND & MARGARET MAE HAMMOND, BILL J. McCLENEGHAN & GLORIA G. McCLENEGHAN and GEORGE P. BROUGHTON & NETTA BELLE BROUGHTON are the owners of that real property situated in the County of Mesa, State of Colorado, described as follows and shown on the accompanying plat hereof:

Beginning at the S.E. cor. of the S.W. 1/4 NE 1/4 of Sec. 23, T. 1 S., R. 1 W. of the Ute Meridian; thence Due North 315' thence N 89° 52' E 300' thence Due South 315' thence S 89° 52' E 300' to the place of beginning, together with that area shown hereon as Gary Drive.

The above described is a portion of that tract formerly described as the SW 1/4 NE 1/4 of Sec. 26, T. 1 S., R. 1 W. of the Ute Meridian.

That the said owner has caused the said real property to be laid out and surveyed as LINDEN ACRES a subdivision of a part of the County of Mesa.

That said owners do hereby dedicate and set apart all of the streets and roads as shown on the accompanying plat to the use of the public forever, and hereby dedicate those portions of said real property which are labeled as utility easements on the accompanying plat as easements for the installation and maintenance of such as telephone and electric lines, pipes and conduits, storm and sanitary sewer mains, water mains, gas pipe lines; and those portions of said real property which are labeled as irrigation easements on the accompanying plat as easements for the installation and maintenance of irrigation ditches, flumes, and conduits.

That all expenses for installation of utilities or ditches referred to above, for grading or landscaping, and for street graveling or improvements shall be financed by the seller or the purchaser --- not the County of Mesa.

IN WITNESS WHEREOF, said PAUL J. HAMMOND & MARGARET MAE HAMMOND, BILL J. McCLENEGHAN & GLORIA G. McCLENEGHAN and GEORGE P. BROUGHTON & NETTA BELLE BROUGHTON have caused their names to be herunto subscribed this 5th day of November, A.D. 1959.

By Paul J. Hammond By Margaret Mae Hammond  
 By Gloria G. McCleughan  
 By George P. Broughton By Netta Belle Broughton  
 STATE OF COLORADO )  
 COUNTY OF MESA )

The foregoing instrument was acknowledged before me this 5th day of November, A.D. 1959 by PAUL J. HAMMOND & MARGARET MAE HAMMOND, BILL J. McCLENEGHAN & GLORIA G. McCLENEGHAN and GEORGE P. BROUGHTON & NETTA BELLE BROUGHTON.

My Commission expires June 22, 1961

Witness my hand and official seal.

D. K. Clifton  
Notary Public

CLERK AND RECORDER'S CERTIFICATE

STATE OF COLORADO )  
 COUNTY OF MESA )

757903

I hereby certify that this instrument was filed in my office at 1:20 o'clock P.M., Nov 17 A.D. 1959, and is duly recorded in Plat Book No. 9 page 88.

Annice M. Dunston  
Clerk and Recorder

By \_\_\_\_\_ Deputy

Fees \$ 6.00

COUNTY PLANNING COMMISSION CERTIFICATE

Approved this 10 day of November, A.D. 1959.  
 County Planning Commission of the County of Mesa, Colorado.

By E. J. ...  
Chairman

BOARD OF COUNTY COMMISSIONER'S CERTIFICATE

Approved this 23rd day of November, A.D. 1959.  
 Board of County Commissioners of the County of Mesa, Colorado.

By R. F. ...  
Chairman

WEST ORCHARD MESA PLANNING DISTRICT CERTIFICATE

Approved this 23rd day of November, A.D. 1959  
 County Planning Commission of the County of Mesa, Colorado.

By ...  
Chairman

SURVEYOR'S CERTIFICATE

I, Davis C. Holder, do hereby certify that the accompanying plat of LINDEN ACRES, a subdivision of a part of the County of Mesa, has been prepared under my direction, and accurately represents a field survey of same.

By Davis C. Holder  
Registered Land Surveyor  
 Colo. No. 1833

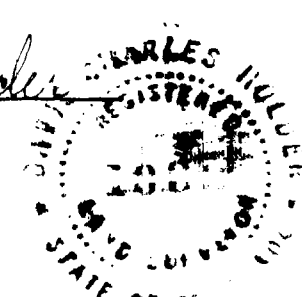

SCALE: 1" = 30'

MAP OF  
 LINDEN ACRES SUBDIVISION REPLAT  
 MESA COUNTY, COLORADO  
 HOLDER ENGINEERING SERVICE

SURVEYED BY M.R. MCGAW - H.L. CRAWFORD  
 DRAWN BY M.R. MCGAW - H.L. CRAWFORD  
 CHECKED BY D.C. HOLDER  
 GRAND JUNCTION, COLO. 8V3-1-1 OCTOBER 30, 1959